

**REVISIONS**

**McCabe**  
 2011B SAN ELIJAO AVE.  
 CARLIFF BY THE SEA,  
 CALIFORNIA, 90207  
 T 760-478-0733  
 F 760-478-0710  
 mcbcabv.com

architect

LICENSED ARCHITECT  
 THOMAS A. McCABE  
 NO. C 11868  
 REN. 09-30-13  
 STATE OF CALIFORNIA

These drawings, specifications, calculations, designs and arrangements are and shall remain the sole property of McCabe ARCHITECTURE. All rights reserved for the specific project that these plans are prepared for. Duplication or reproduction of any kind for any purpose without any expressed written permission of McCabe ARCHITECTURE is prohibited.

**6 STORY  
 SUBMITTAL SET**

**PARCEL A  
 LEVEL 6  
 FLOOR PLAN**

DRAWN BY:  
 VS-DS  
 DATE:  
 December 14, 2012  
 SHEET:

**A2.5**

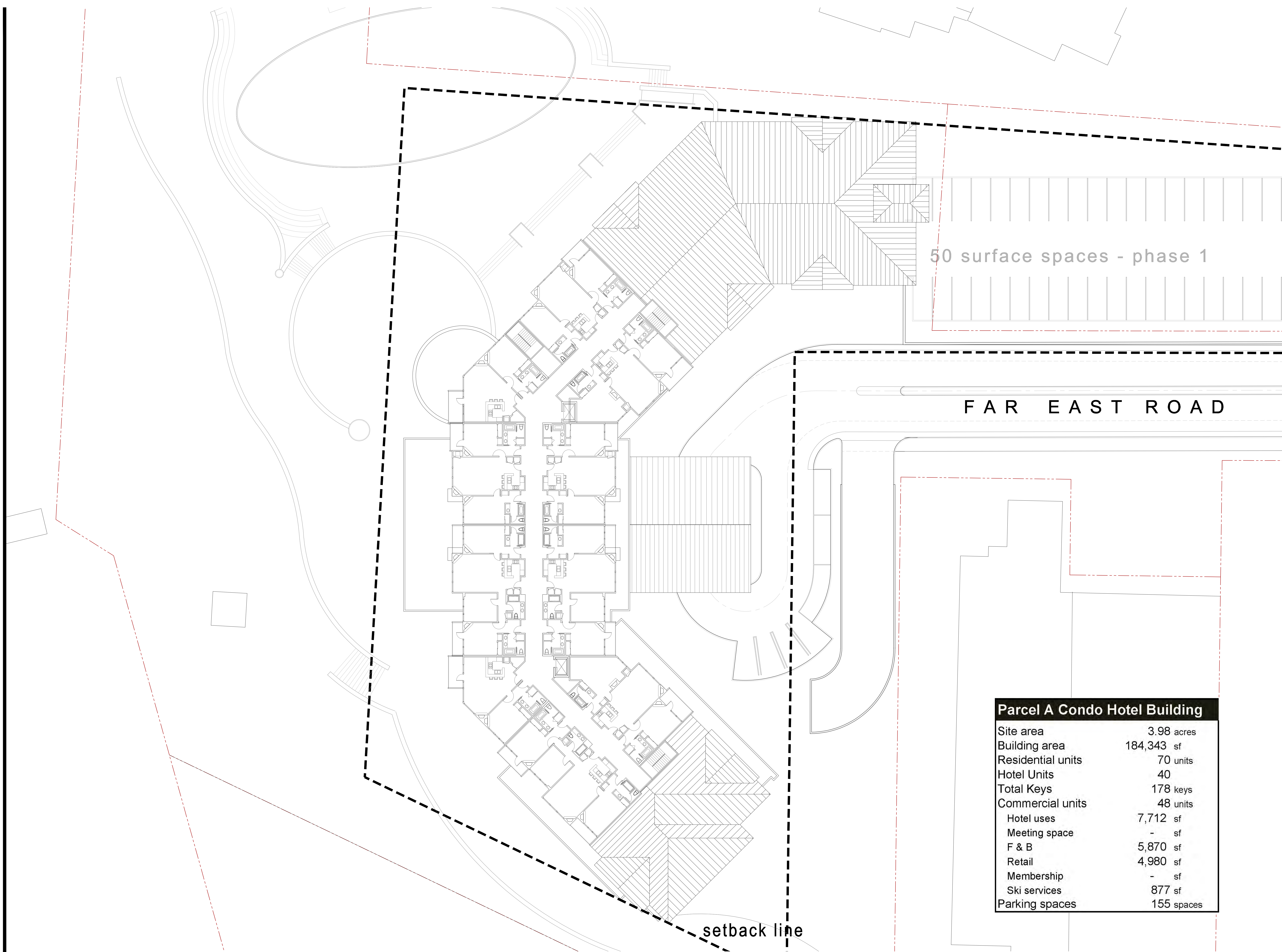

**Parcel A Condo Hotel Building**

Site area	3.98 acres
Building area	184,343 sf
Residential units	70 units
Hotel Units	40
Total Keys	178 keys
Commercial units	48 units
Hotel uses	7,712 sf
Meeting space	- sf
F & B	5,870 sf
Retail	4,980 sf
Membership	- sf
Ski services	877 sf
Parking spaces	155 spaces

setback line

**LEVEL 6 FLOOR PLAN**  
SCALE: 1/16"=1'-0"

