

ALTERNATIVE 4 - ROADWAY CROSS SECTION:

- 1 - 3.6 m (12') TRAFFIC LANE EACH DIRECTION
- 1 - 3.6 m (12') DUAL CENTER TURN LANE
- 1 - 1.5 m (5') BIKE LANE EACH DIRECTION
- 1 - 5.3 m (18'±) SIDEWALK/PLANTING AREA EACH DIRECTION
(SEE SHEET 18 FOR TYPICAL X-SECTION - ALTERNATIVE 4)



NO.	DATE	DESCRIPTION AND SHEET NO.	APPROVED BY	DATE

PLAN SCALE: 1:500
 PROFILE SCALE: 1:500
 HORIZ: 1:500
 VERT: 1:50

THE COUNTY OF PLACER OR ITS OFFICERS OR AGENTS SHALL NOT BE RESPONSIBLE FOR THE ACCURACY OR COMPLETENESS OF ELECTRONIC COPIES OF THIS PLAN SHEET.

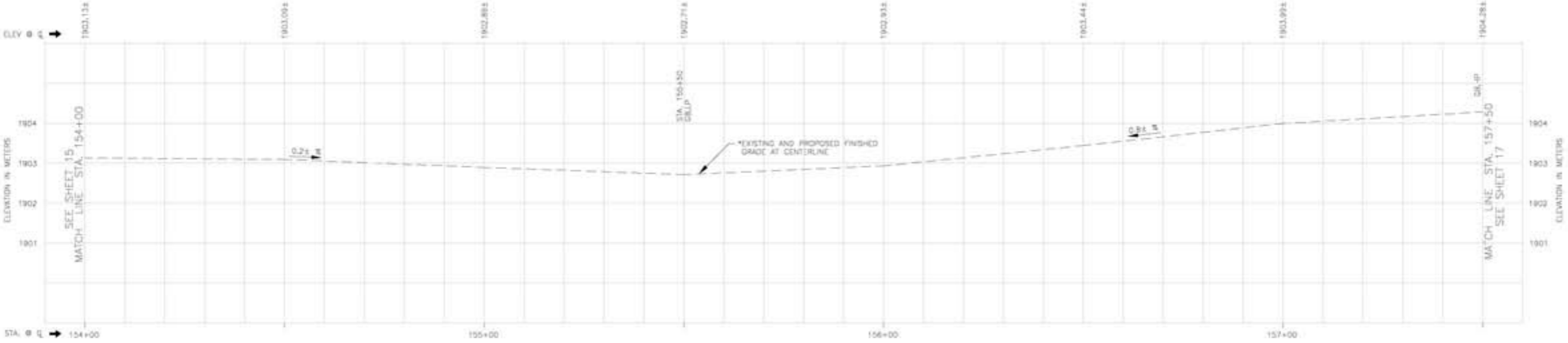
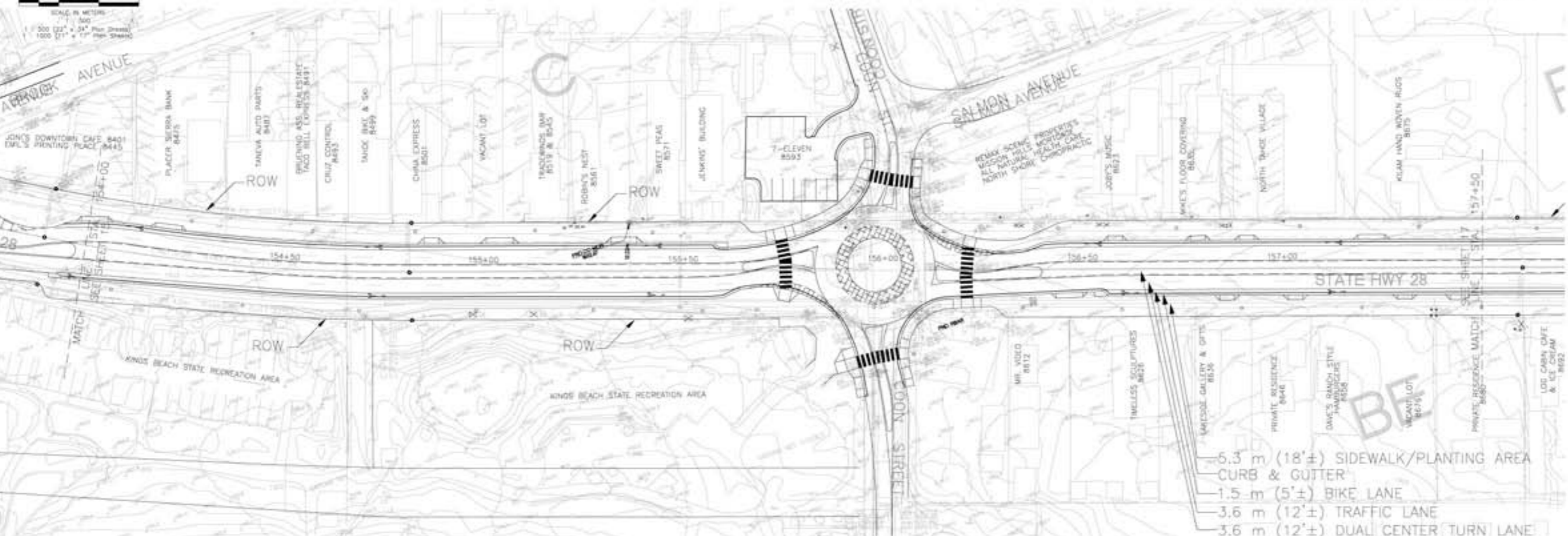

CONTRACT NO. 73108
 DESIGNED: BPS
 DRAWN: BRS
 CHECKED: BTL
 DATE: 12/02/08
 RECORD: [blank]

DEPARTMENT OF PUBLIC WORKS
KINGS BEACH COMMERCIAL CORE IMPROVEMENT PROJECT
 FEASIBILITY STUDY - ALTERNATIVE 4 - PLAN, PROFILE & STRIPING LAYOUT

SHEET NO. 15 OF 18

Figure 2-1 Kings Beach Commercial Core Improvement Project Alternatives

Source: Dokken Engineering