

**ALTERNATIVE 5 - ROADWAY CROSS SECTION:**

- 1 - 3.6 m (12') TRAFFIC LANE EASTBOUND
- 2 - 3.6 m (12') TRAFFIC LANES WESTBOUND
- 1 - 3.6 m (12') DUAL CENTER TURN LANE
- 1 - 1.5 m (5') BIKE LANE EACH DIRECTION
- 1 - 2.4 m (8') PARKING LANE WESTBOUND
- 1 - 2.3 m (7½) SIDEWALK/PLANTING AREA EACH DIRECTION (SEE SHEET 27 FOR TYPICAL X-SECTION - ALTERNATIVE 5)

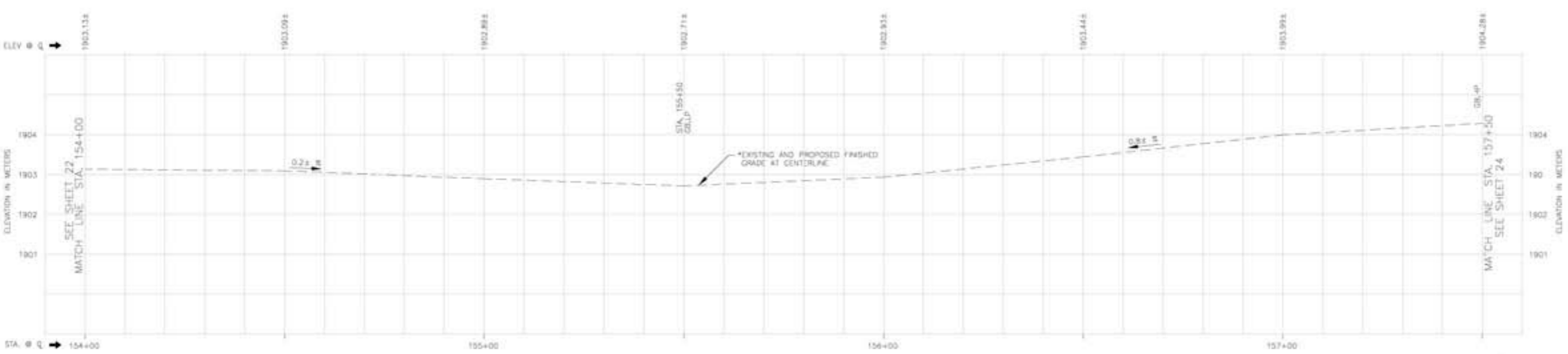

THE COUNTY OF PLACER OR ITS OFFICERS OR AGENTS SHALL NOT BE RESPONSIBLE FOR THE ACCURACY OR COMPLETENESS OF ELECTRONIC COPIES OF THIS PLAN SHEET.

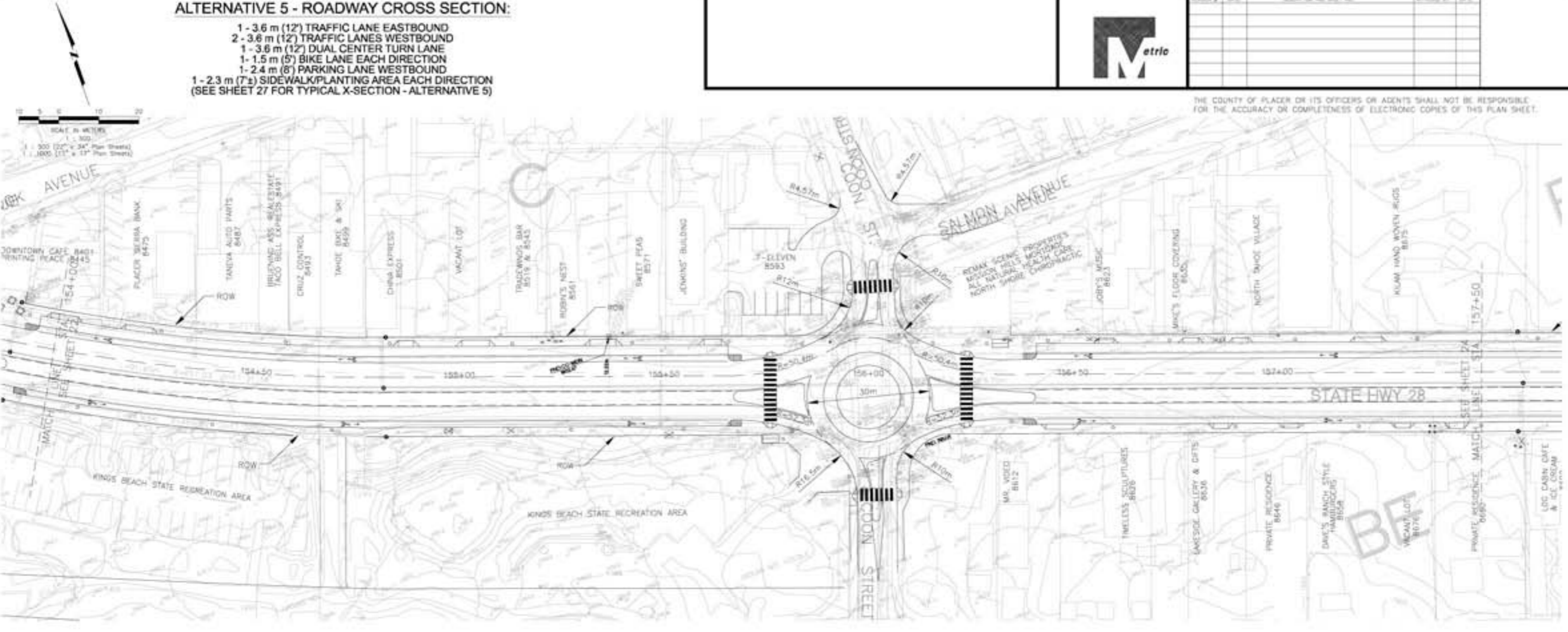

PLAN SCALE: 1:500
PROFILE SCALE: 1:500
HORIZ: 1:500
VERT: 1:50

DESIGNED: BRS	DATE:
DRAWN: BRS	12/29/08
CHECKED: BRS	
RECORDS: BRS	
CONTRACT NO. 73108	

DEPARTMENT OF PUBLIC WORKS  
 COUNTY OF PLACER  
**KINGS BEACH COMMERCIAL CORE IMPROVEMENT PROJECT**  
 FEASIBILITY STUDY - ALTERNATIVE 5 - PLAN, PROFILE & STRIPING LAYOUT

SHEET NO. 39

**Figure 2-5**  
**Kings Beach Commercial Core Improvement Project Rejected Alternative 5**