

CORNER RECORD

COUNTY OF Placer T. 16 N. R. 11 E. M.D.B.& MERIDIAN CALIFORNIA

CORNER TYPE: GOV'T. CORNER MEANDER RANCHO CONTROL OTHER

CORNER IDENTIFICATION — DATE OF VISIT August 25, 1977

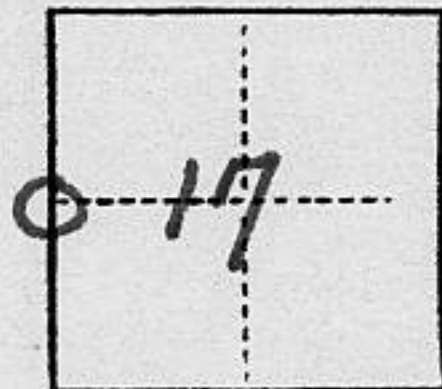

West one-quarter corner of Section 17.

CORNER — LEFT AS FOUND FOUND AND TAGGED REESTABLISHED OBLITERATED CORNER REBUILT

PHYSICAL DESCRIPTION OF CORNER FOUND; EVIDENCE AND METHOD USED TO IDENTIFY OR REESTABLISH

60 inch fir B.T.
14 inch black oak B.T. with M. S. Bartel's mark \bar{E} cut into bark.

Government notes June 1866 (72-9-59)

PHYSICAL DESCRIPTION OF MONUMENTS REBUILT OR PERPETUATED

2-1/2 inch square aluminum plate on aluminum x-bar.

CALIFORNIA COORDINATE SYSTEM ORDER: FIRST SECOND THIRD
STATIONS USED: NGS (USC & GS) STATE COUNTY OTHER STATION _____ STATION _____
ZONE _____ ELEVATION _____ NORTHINGS (Y) _____ EASTINGS (X) _____

SKETCH: (Include reference tie or witness points, remarks and topo of area)

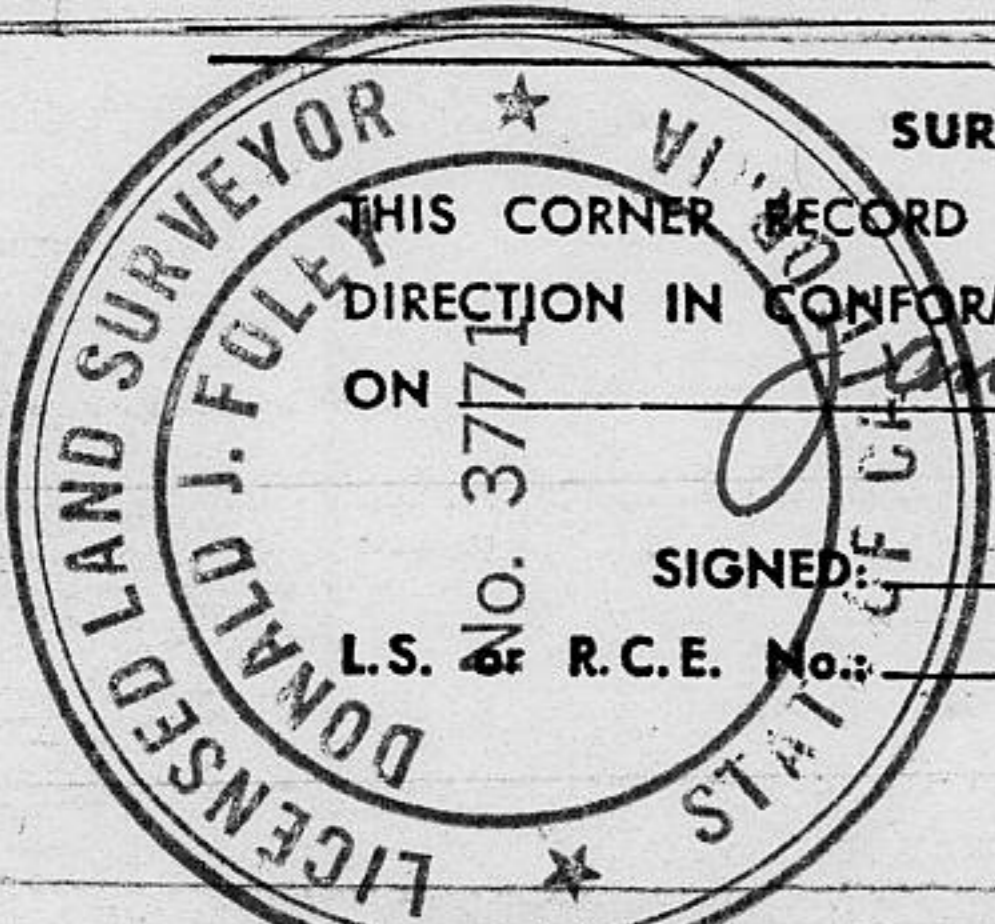
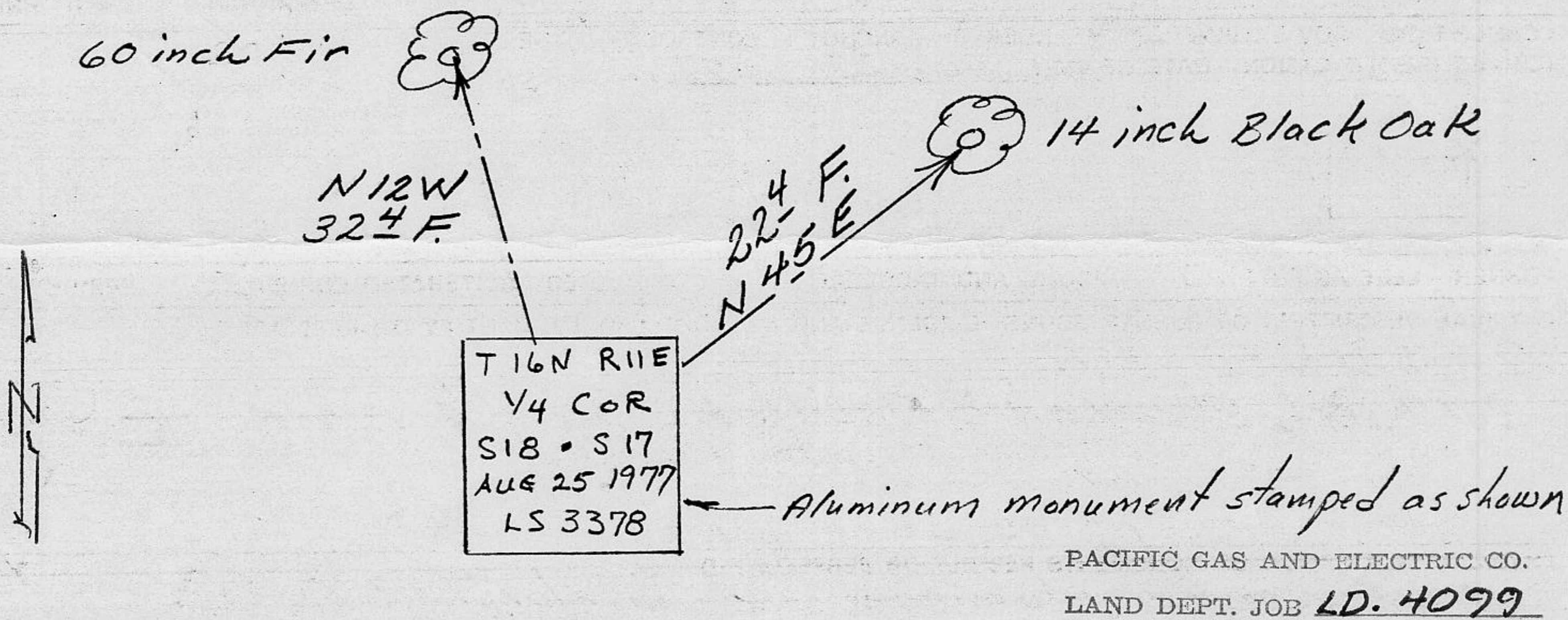

SURVEYOR'S CERTIFICATE

THIS CORNER RECORD WAS PREPARED BY ME OR UNDER MY DIRECTION IN CONFORMANCE WITH THE LAND SURVEYORS ACT ON January 23, 1978

SIGNED: [Signature]

L.S. No. 37701 R.C.E. No. _____

SEAL

COUNTY SURVEYOR'S CERTIFICATE

THE CORNER RECORD WAS RECEIVED January 31, 1978 AND EXAMINED AND FILED January 31, 1978

BY: [Signature]

TITLE: Deputy County Surveyor
LS 3798

DOCUMENT No. _____

STATEMENT ON BACK OF SHEET

YES NO