

**Before the Board of Supervisors  
County of Placer, State of California**

In the matter of: **AN ORDINANCE AMENDING  
PLACER COUNTY CODE SECTION 9.08.010  
REGARDING POSSESSION OR CONSUMPTION  
OF ALCOHOLIC BEVERAGES IN DESIGNATED  
AREAS**

Ord. No: \_\_\_\_\_

First Reading: April 24, 2012

The following Ordinance was duly passed by the Board of Supervisors of the  
County of Placer at a regular meeting held \_\_\_\_\_ by the following  
vote on roll call:

Ayes:

Noes:

Absent:

Signed and approved by me after its passage.

\_\_\_\_\_  
CHAIR, BOARD OF SUPERVISORS

Attest:  
Clerk of said Board

\_\_\_\_\_

\_\_\_\_\_

**THE BOARD OF SUPERVISORS OF THE COUNTY OF PLACER, STATE OF CALIFORNIA, DOES HEREBY ORDAIN AS FOLLOWS:**

**SECTION 1:** Placer County Code Chapter 9, PUBLIC PEACE, SAFETY AND WELFARE, Article 9.08, OFFENSES AGAINST PUBLIC PEACE AND DECENCY, Section 9.08.010, Possession or consumption of alcoholic beverages in designated areas prohibited, is hereby amended and restated in its entirety as follows:

9.08.010 Possession or consumption of alcoholic beverages in designated area prohibited.

Any person consuming any alcoholic beverage or possessing any can, bottle, or other receptacle containing any alcoholic beverage which has been opened, or a seal broken, or the contents of which has been partially removed in the following designated areas shall be guilty of an infraction:

A. That area of land located in Kings Beach, California known as Agatam County Beach described as follows:

Beginning at a point on the low water line of Lake Tahoe at the intersection of the south-westerly extension of the south-easterly boundary of Lot 8 Block BF of Brockway Vista subdivision (M.O.R. Bk. D, Pg. 16);

Thence from said point of beginning north-easterly along said south-easterly boundary of said Lot 8 and the north-easterly extension thereof to a point on the north-easterly boundary of Brockway Vista Avenue, Placer County Road X7038;

Thence north-westerly along said north-easterly boundary of Brockway Vista Avenue to the south corner of Lot 141 Block BE of said Brockway Vista subdivision;

Thence north-easterly along the south-easterly line of said Lot 141 to the east corner of said Lot 141 of Brockway Vista subdivision;

Thence north-westerly along the north-easterly boundaries of Lots 141, 142, 143 and 144 Block BE of Brockway Vista subdivision to the north corner of Lot 144, to a point on the south-easterly side of Coon Street, Placer County Road X7026;

Thence north-easterly along the south-easterly boundary of Coon Street to its intersection with the south-westerly boundary of California State Highway 28;

Thence north-westerly along said south-westerly boundary of California State Highway 28 to the easterly corner of Lot 42 Block B of said Brockway Vista subdivision, said point being the north-easterly corner of the Kings Beach State Recreation area;

Thence along the easterly boundary of said Kings Beach State Recreation Area to a point on the low water line of Lake Tahoe;

Thence south-easterly along the low water line of Lake Tahoe to the point of beginning.

Excepting therefrom any land owned by the state of California for which an adopted management plan or other authorized action expressly provides for, or otherwise governs, the consumption of alcoholic beverages, or any land or buildings owned by the state of California for which a lease or rental agreement does not prohibit the consumption of alcoholic beverages.

B. That area of land located in Kings Beach, California known as Buck's/Speedboat County Beach located at the end of Speedboat and Harbor Avenues in Brockway, Lake Tahoe.

C. That area of land located in Kings Beach, California known as Secline Beach including the beach, day-use area, streets and parking lot.

D. From July 1 to July 6, inclusive, each year, that area of land located in Homewood, California known as Chambers Landing Beach described as follows:

Recreation Area X (4.64 acres) of Chambers Landing II, Tract No. 553, 'A Condominium Project Being Lot 1 of Chambers Landing I Subdivision' as said land is shown and designated on that certain map filed for record on January 29, 1982 in Book N of Maps at Page 50, Official Records, Placer County, California.

**SECTION 2:** This ordinance shall take effect and be in full force thirty (30) days after the date of its passage. The Clerk is directed to publish this ordinance, or a summary thereof, within fifteen (15) days in accordance with Government Code Section 25124.

Ord Intro

PLACER COUNTY

# SHERIFF CORONER-MARSHAL

MAIN OFFICE  
2020 RICHARDSON DR  
AUBURN, CA 95603  
PH: (530) 889-7300 FAX: (530) 889-7699

TAHOE SUBSTATION  
DRAWER 1710  
TAHOE CITY, CA 96145  
PH: (530) 681-6300 FAX: (530) 681-8377

EDWARD N. BONNER  
SHERIFF-CORONER-MARSHAL

DEVON BELL  
UNDERSHERIFF

**To:** The Honorable Board of Supervisors  
**From:** Edward N. Bonner, Sheriff-Coroner-Marshal  
**Date:** April 24, 2012  
**Subject:** Approve an Ordinance modifying Chapter 9 of the Placer County Code.

### Action Requested

Approve an ordinance modifying Chapter 9 of the Placer County Code designating the dates of July 1 through July 6 annually as summer holiday periods banning alcohol, at Chambers Landing Beach located in Homewood, California. The enforcement area is described in the Ordinance and depicted as parcel "098-330-015 USFS" on the attached map.

### Background

On April 14, 2008 your board approved Ordinance No. 5507-B, which prohibits possession of open alcoholic containers for a distance of three feet on both sides of the Truckee River. Placer County Code 9.08.010 also bans alcohol from designated beach areas. Both of these statutes have made a significant impact on reducing alcohol related incidents during the summer holiday periods. Chambers Landing Beach is the only shoreline in our jurisdiction that currently is not included in these County Ordinances. The United States Forest Service (USFS) has primary law enforcement responsibility on Chambers Landing; however due to staffing shortages they have been unable to have a law enforcement presence during the summer holiday periods. The Sheriff's Office has requested, and the USFS concurs that Chambers Landing Beach be added to our Ordinance which will allow Sheriff's Office staff to take action when alcohol violations occur. Over the last few years crowds who are in violation of our current ordinances will move to the Chambers Landing Beach which current ordinances do not address creating a difficult situation for Sheriff's Office staff to manage.

### Fiscal Impact

Related costs associated with law enforcement efforts in enforcing the proposed ban are not expected to be greater than annual costs associated with activities during the summer holiday. Funds for enforcement are included in our FY 2012-2013 Proposed Budget. There is no impact to the General Fund.

**LAKE TAHOE**

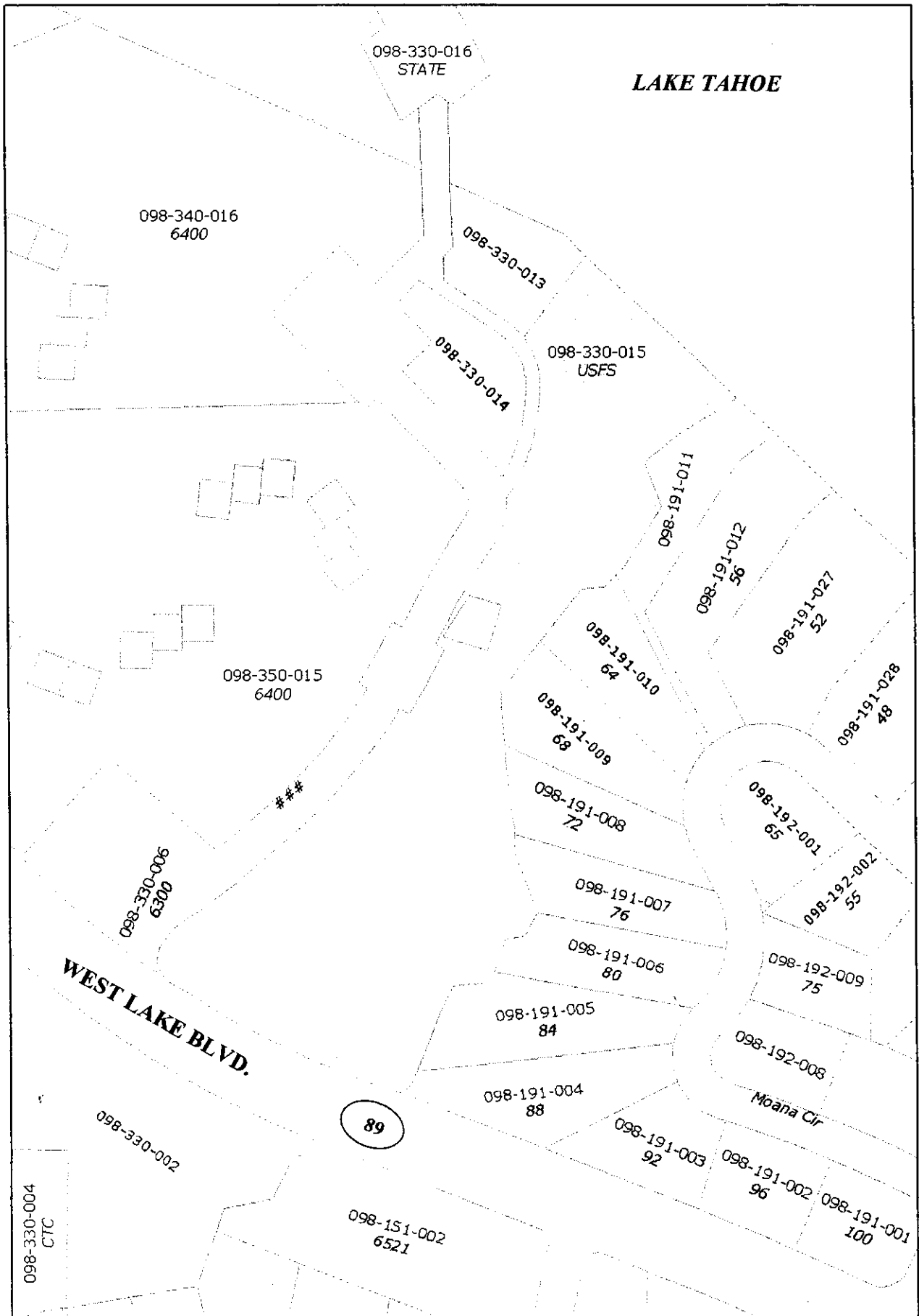

098-330-016  
STATE

098-340-016  
6400

098-330-013

098-330-014

098-330-015  
USFS

098-350-015  
6400

###

098-330-006  
6300

**WEST LAKE BLVD.**

098-330-004  
CTC

89

098-151-002  
6521

098-191-011

098-191-012  
56

098-191-027  
52

098-191-028  
48

098-191-010  
64

098-191-009  
68

098-191-008  
72

098-192-001  
65

098-192-002  
55

098-191-007  
76

098-191-006  
80

098-192-009  
75

098-191-005  
84

098-192-008

Moana Cir

098-191-004  
88

098-191-003  
92

098-191-002  
96

098-191-001  
100

0 87.5 175 Feet

