

MEMORANDUM

DEPARTMENT OF PUBLIC WORKS
County of Placer

TO: BOARD OF SUPERVISORS DATE: November 6, 2012
FROM: KEN GREHM / PETER KRAATZ
SUBJECT: ALPINE MEADOWS ROAD BRIDGE REPLACEMENT PROJECT,
EASEMENT ACQUISITION FROM TRUCKEE RIVER RANCH
PROPERTY

ACTION REQUESTED / RECOMMENDATION

1. Adopt a Resolution approving a Purchase Agreement for the acquisition of a Highway Easement and a Temporary Construction Easement on property owned by Truckee River Ranch Co. for the Alpine Meadows Bridge Replacement Project in the amount of \$92,437 utilizing Highway Bridge Program Acquisition funds.
2. Authorize the Chairwoman to execute the Agreement and accept the Easement deeds. There is no net county cost.

BACKGROUND / SUMMARY

The Department of Public Works is currently completing the design of a federal Highway Bridge Program project which will replace the existing bridge on Alpine Meadows Road over the Truckee River. The project will replace the existing structurally deficient and functionally obsolete bridge which is deteriorating and does not meet current design standards. The replacement bridge and improved approaches will bring this bridge into compliance with current structural, geometric, and hydraulic guidelines.

Right-of-Way for the Project is required from four properties. A permanent Highway Easement and Temporary Construction Easement are being acquired from the Truck River Ranch property on the southeast corner of Highway 89 and Alpine Meadows Road to accommodate the new bridge and approaches. The easements are being acquired for the appraised value of \$92,437.

ENVIRONMENTAL CLEARANCE

A Negative Declaration was prepared for this project pursuant to the provisions of CEQA and adopted by the Placer County Board of Supervisors on March 8, 2011. The NEPA Categorical Exclusion Compliance for this project was approved on March 10, 2011.

FISCAL IMPACT

The total cost of the project is estimated to be \$10,000,000, with funding from the federal Highway Bridge program at 88.53 percent, County Road Funds and Traffic Mitigation fees from the Tahoe Resorts Benefit District at 11.47 percent.

Attachments: Resolution
 Location Map
 Acquisition Map

Copies of the Agreement and deeds are on file
with the Clerk of the Board

**Before the Board of Supervisors
County of Placer, State of California**

In the matter of: Adopt a Resolution approving the Purchase Agreement for the acquisition of a Highway Easement and Temporary Construction Easement on property owned by Truckee River Ranch Co., and authorize the Chairwoman to execute the Agreement and accept the Easement Deeds – Alpine Meadows Bridge Replacement Project.

Resol. No:.....

The following RESOLUTION was duly passed by the Board of Supervisors of the County of Placer at a regular meeting held _____, by the following vote on roll call:

Ayes:

Noes:

Absent:

Signed and approved by me after its passage.

Attest:
Clerk of said Board

Chairwoman, Board of Supervisors

BE IT RESOLVED by the Board of Supervisors of the County of Placer, State of California, that the attached Purchase Agreement between Truckee River Ranch Co. and the County of Placer in the amount of \$92,437 is hereby approved and the Chairwoman is authorized to execute the agreement on behalf of Placer County and accept the Highway Easement and Temporary Construction Easement.

ALPINE MEADOWS ROAD BRIDGE REPLACEMENT PROJECT

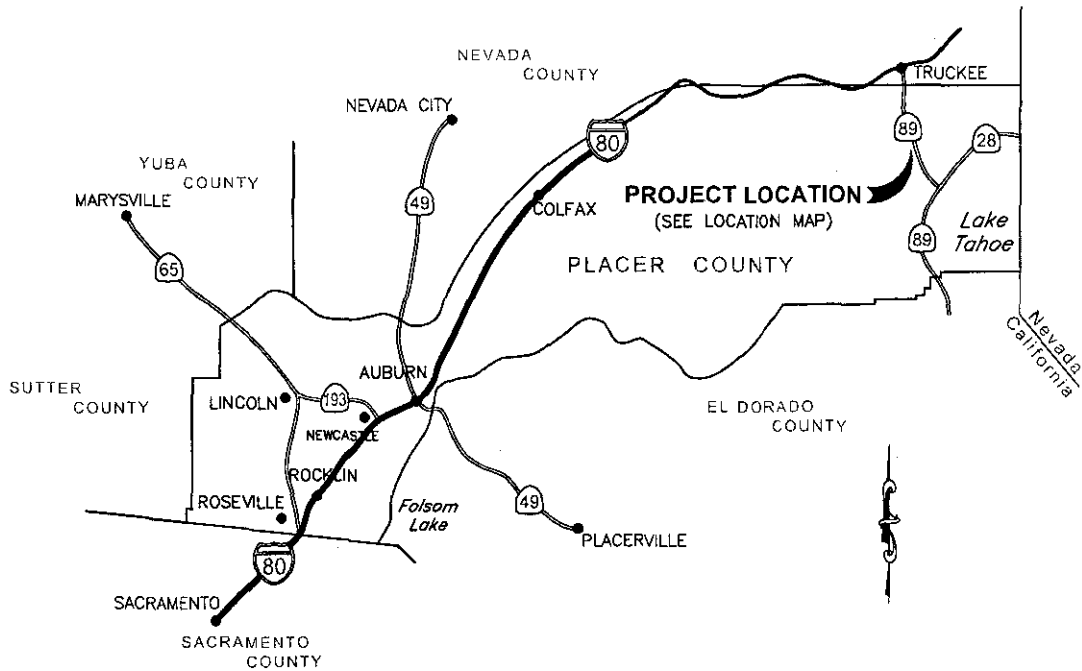

VICINITY MAP

Not to Scale

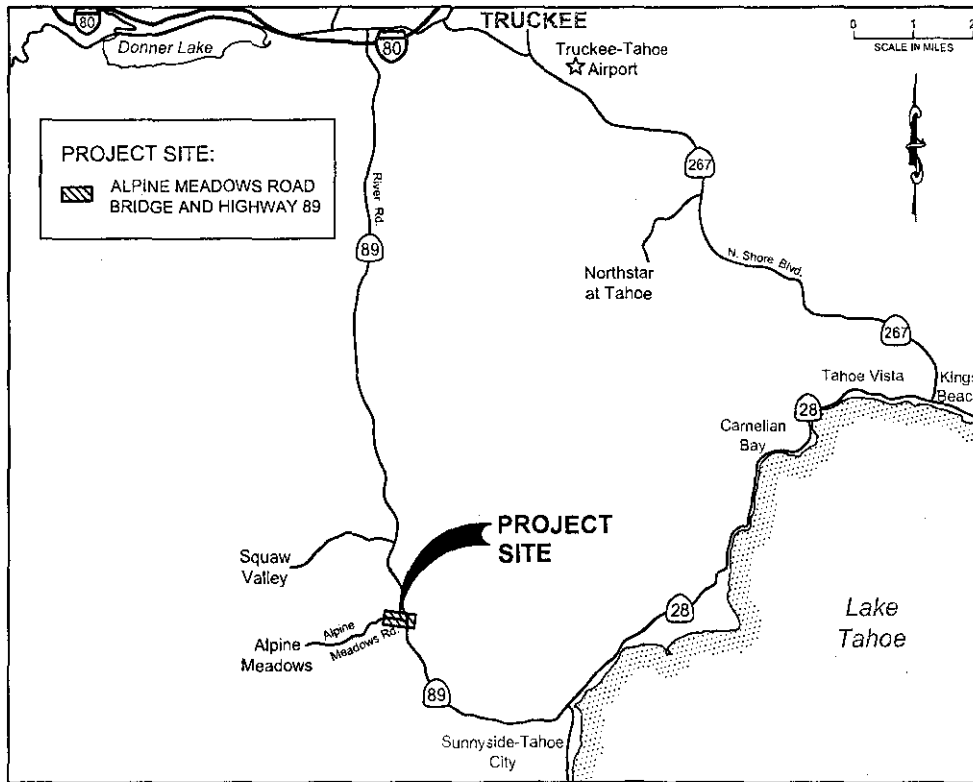

LOCATION MAP

Scale as Shown

ACQUISITION MAP

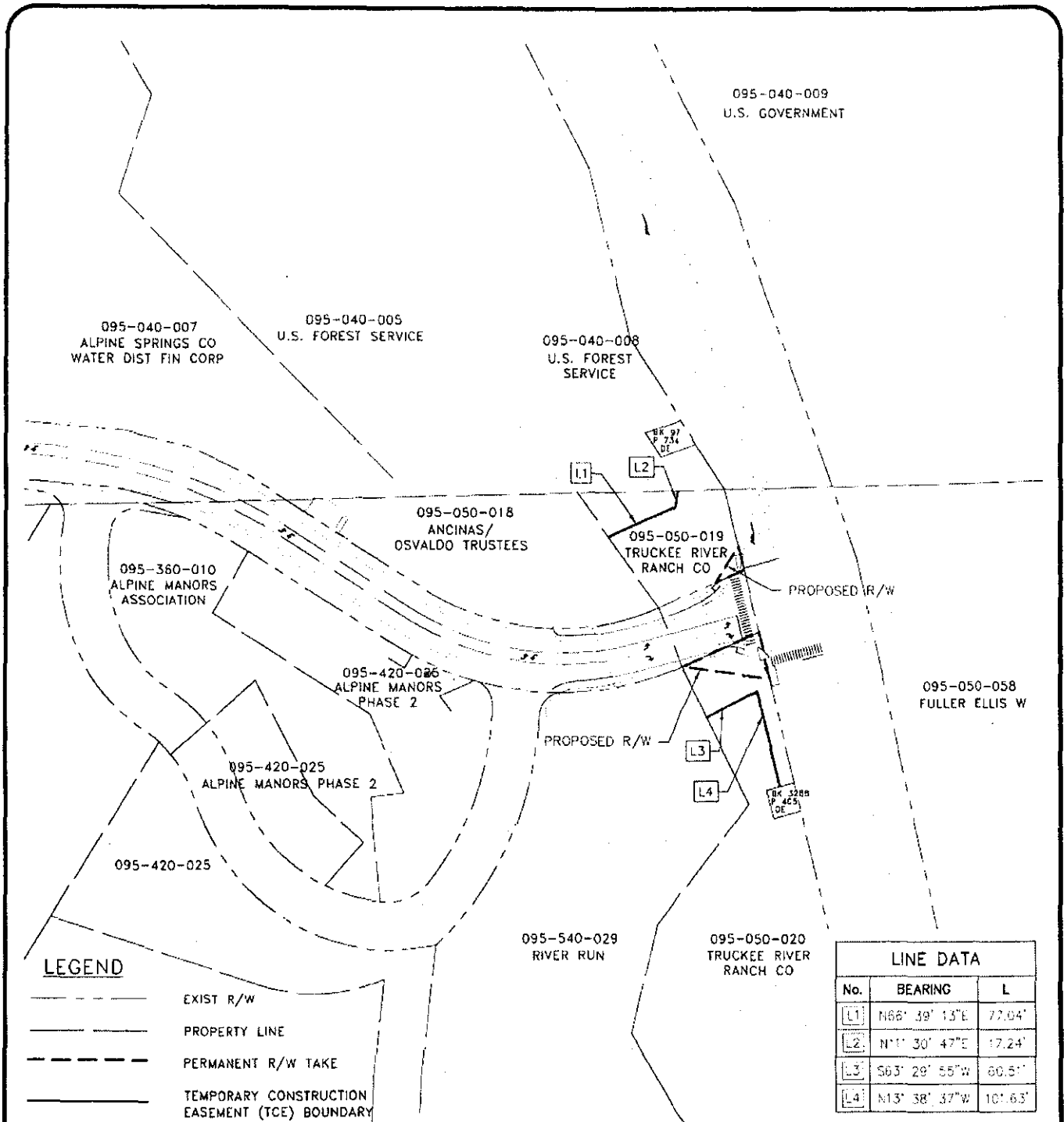

LINE DATA		
No.	BEARING	L
L1	N68° 39' 13"E	77.04'
L2	N1° 30' 47"E	17.24'
L3	S63° 29' 55"W	60.51'
L4	N13° 38' 37"W	101.63'

	PARCEL NO.	GRANTOR	SQFT	ACRES
TEMPORARY CONSTRUCTION EASEMENT	095-050-019	TRUCKEE RIVER RANCH CO	10,308.10	0.237
	095-050-020	TRUCKEE RIVER RANCH CO	4,192.40	0.096
PERMANENT RIGHT-OF-WAY	095-050-019	TRUCKEE RIVER RANCH CO	1,331.67	0.031
	095-050-020	TRUCKEE RIVER RANCH CO	3,027.93	0.070



TRUCKEE RIVER RANCH CO APPRAISAL MAP

OCTOBER 2012
1 OF 1

272