

CORNER RECORD

COUNTY OF Placer T. 13N R. 12E MDM MERIDIAN CALIFORNIA

CORNER TYPE: GOVT. CORNER MEANDER RANCHO CONTROL OTHER

CORNER IDENTIFICATION — DATE OF VISIT Feb 1978



CORNER — LEFT AS FOUND FOUND AND TAGGED REESTABLISHED OBLITERATED CORNER REBUILT

PHYSICAL DESCRIPTION OF CORNER FOUND, EVIDENCE AND METHOD USED TO IDENTIFY OR REESTABLISH

Record { Corner mon. gone
Orig B.T. 22" Y.P. N82 1/2° W 10 Iks. (see below)
Orig B.T. 28" Y.P. S86 1/2° (E) 21 Iks found - orig blaze & scribing good cond.

PHYSICAL DESCRIPTION OF MONUMENTS REBUILT OR PERPETUATED

Set 2" capped pipe - stamped for corner at Record Beaming & Dist. from S.E. B.T. - a large pine log with original blaze and scribing is lying near S.E. B.T. - The stump of this log would be at approx. N80°E 15 Iks from the corner - pipe stamped LS3026 1978

New B.T. - 5" dia Doug fir bears N 23° W 78 Iks - scribed

CALIFORNIA COORDINATE SYSTEM ORDER: FIRST SECOND THIRD
STATIONS USED: NGS (USC & GS) STATE COUNTY OTHER STATION _____ STATION _____
ZONE _____ ELEVATION _____ NORTHINGS (Y) _____ EASTINGS (X) _____

SKETCH: (Include reference tie or witness points, remarks and topo of area)

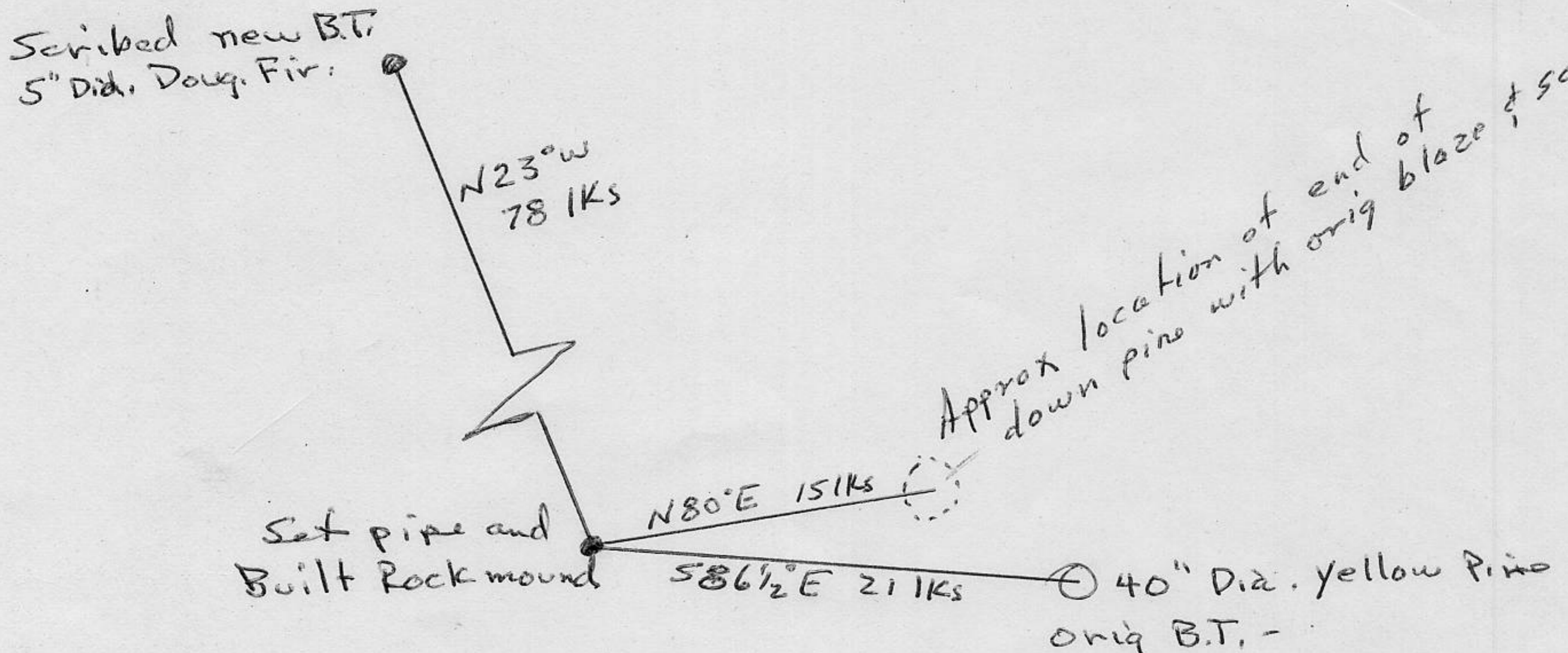

SURVEYOR'S CERTIFICATE

THIS CORNER RECORD WAS PREPARED BY ME OR UNDER MY DIRECTION IN CONFORMANCE WITH THE LAND SURVEYORS ACT ON May 18 19 78

SIGNED: J.L. Miller L.S. 3026
L.S. or R.C.E. No.: LS 3026

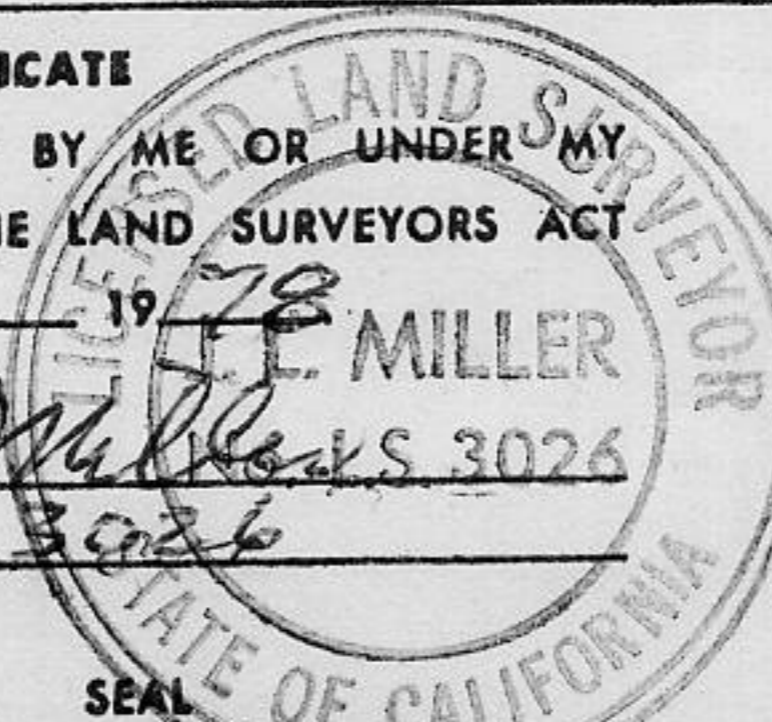

COUNTY SURVEYOR'S CERTIFICATE

THE CORNER RECORD WAS RECEIVED 5/26 19 78
AND EXAMINED AND FILED 5/26 19 78

BY: John F. Photwell
TITLE: COUNTY SURVEYOR

DOCUMENT No. _____

STATEMENT ON BACK OF SHEET

YES NO