

CORNER RECORD

COUNTY OF EAST 1/4 COR. T. 13 N R. 8 E MOUNT DIABLO MERIDIAN CALIFORNIA

CORNER TYPE: GOV'T. CORNER [X] MEANDER [ ] RANCHO [ ] CONTROL [ ] OTHER [ ]

CORNER IDENTIFICATION - DATE OF VISIT 10-10-88 19\_\_

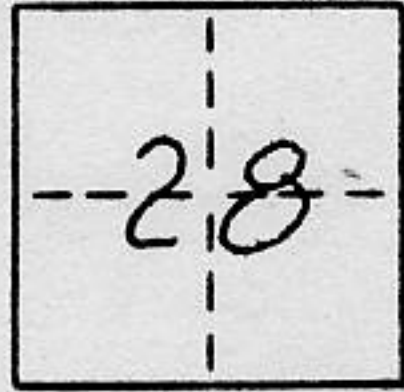

CORNER - LEFT AS FOUND [ ] FOUND AND TAGGED [ ] REESTABLISHED OBLITERATED CORNER [ ] REBUILT [X]

PHYSICAL DESCRIPTION OF CORNER FOUND: EVIDENCE AND METHOD USED TO IDENTIFY OR REESTABLISH FOUND BRASS CAPPED IRON PIPE IN JULY 1987 AND REFERENCED DUE TO IMMINENT DESTRUCTION BY ROAD CONSTRUCTION. I RESET THE REFERENCED POSITION FROM REFERENCE POINTS SET BY ME IN 1987

PHYSICAL DESCRIPTION OF MONUMENTS REBUILT OR PERPETUATED SET 1" IRON PIPE WITH ALUMINUM CAP STAMPED AS SHOWN IN MOUND OF STONE.

CALIFORNIA COORDINATE SYSTEM ORDER: FIRST [ ] SECOND [ ] THIRD [ ] STATIONS USED: NGS (USC & GS) [ ] STATE [ ] COUNTY [ ] OTHER [ ] STATION \_\_\_\_\_ STATION \_\_\_\_\_ ZONE \_\_\_\_\_ ELEVATION \_\_\_\_\_ NORTHINGS (Y) \_\_\_\_\_ EASTINGS (X) \_\_\_\_\_

SKETCH: (Include reference tie or witness points, remarks and topo of area)

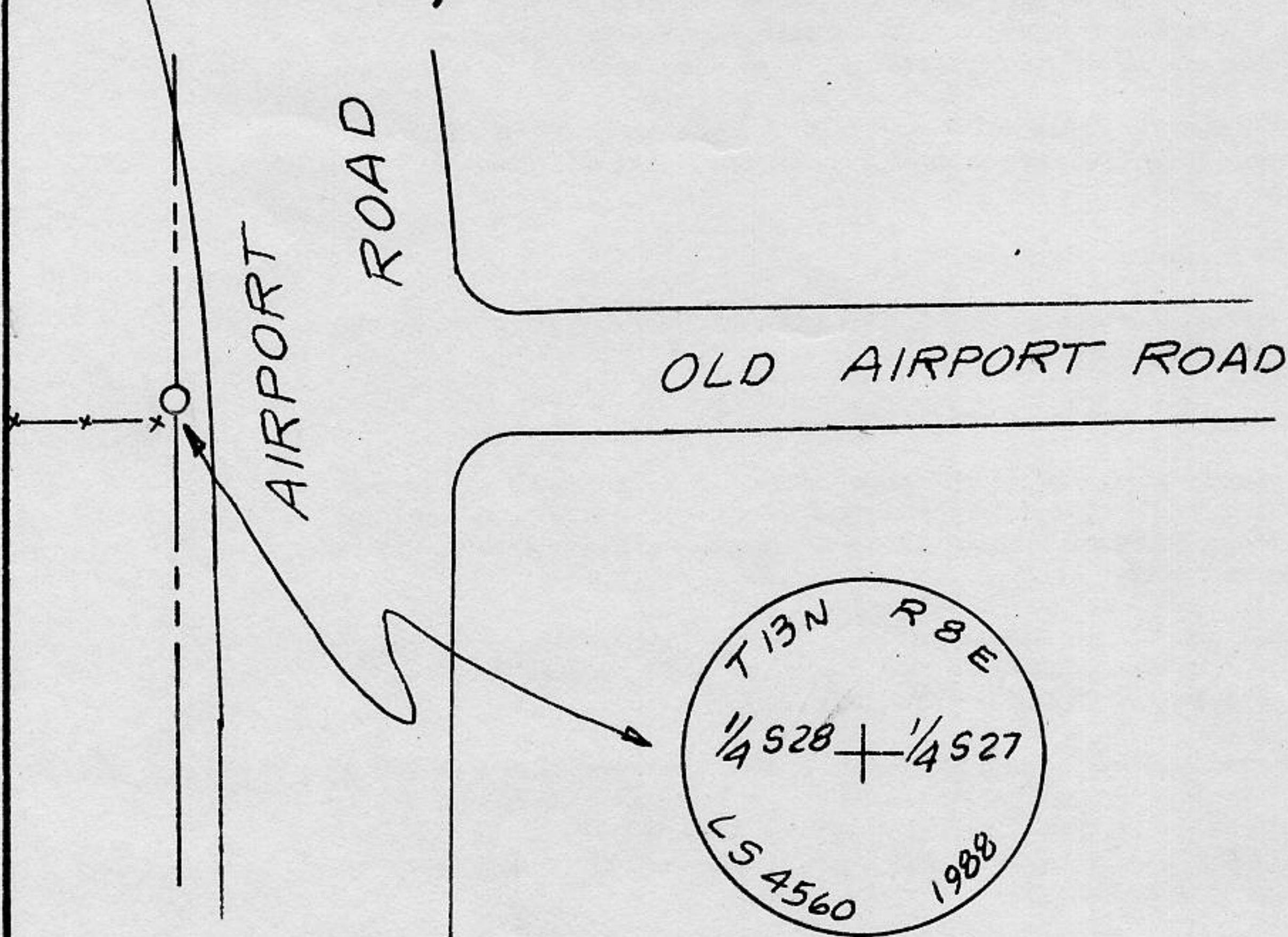

SURVEYOR'S CERTIFICATE

THIS CORNER RECORD WAS PREPARED BY ME OR UNDER MY DIRECTION IN CONFORMANCE WITH THE LAND SURVEYORS ACT ON 10-13 1988

SIGNED: Edward Alan Hess

L.S. or R.C.E. No.: LS 4560 EXPIRES 9-90

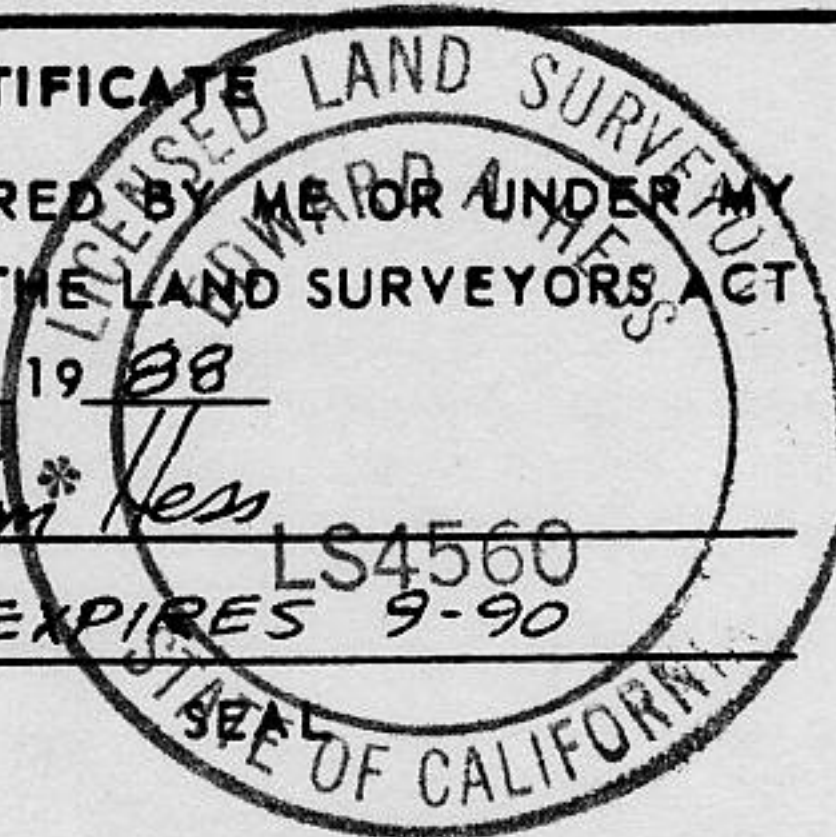

COUNTY SURVEYOR'S CERTIFICATE

THIS CORNER RECORD WAS RECEIVED 10/17 1988 AND EXAMINED AND FILED 5/27 1991

BY: David J. McDaniel TITLE: DEPUTY COUNTY SURVEYOR

DOCUMENT No. \_\_\_\_\_

STATEMENT ON BACK OF SHEET

YES [ ] NO [ ]

BOOK 2, CORNER RECORDS, PAGE 47