

# CORNER RECORD

Document Number \_\_\_\_\_

City of Auburn

County of Placer, California

Brief Legal Description Lot 21, Vista Pointe Subdivision R/Maps/19

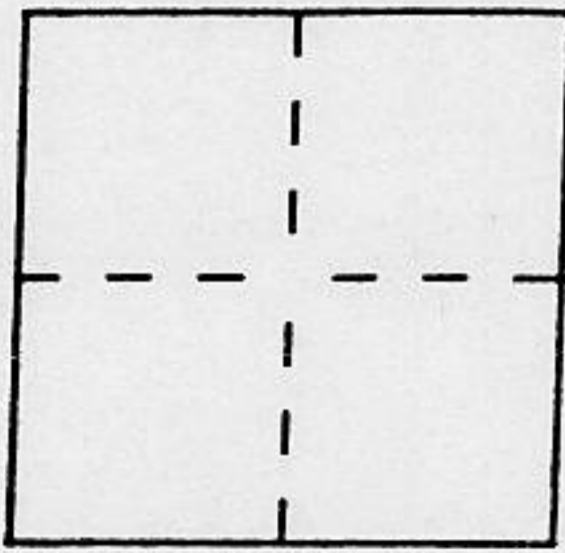

S 1/2  
Sec 3  
T12N  
R08E

### CORNER TYPE

Government Corner  Control   
 Meander  Property   
 Rancho  Other   
 Date of Survey April 1996

### COORDINATES (Optional)

N. \_\_\_\_\_  
 E. \_\_\_\_\_  
 Zone \_\_\_\_\_ Datum \_\_\_\_\_  
 Elev. \_\_\_\_\_

Corner — Left as found  Found and tagged  Established  Reestablished  Rebuilt

Identification and type of corner found: Evidence used to identify or procedure used to establish or reestablish the corner:

see sketch on back

A description of the physical condition of the monument as found and as set or reset:

see sketch on back

### SURVEYOR'S STATEMENT

This Corner Record was prepared by me or under my direction in conformance with the Land Surveyors' Act on 20 May 1996.

Signed [Signature] L.S. or R.C.E. Number LS 6230

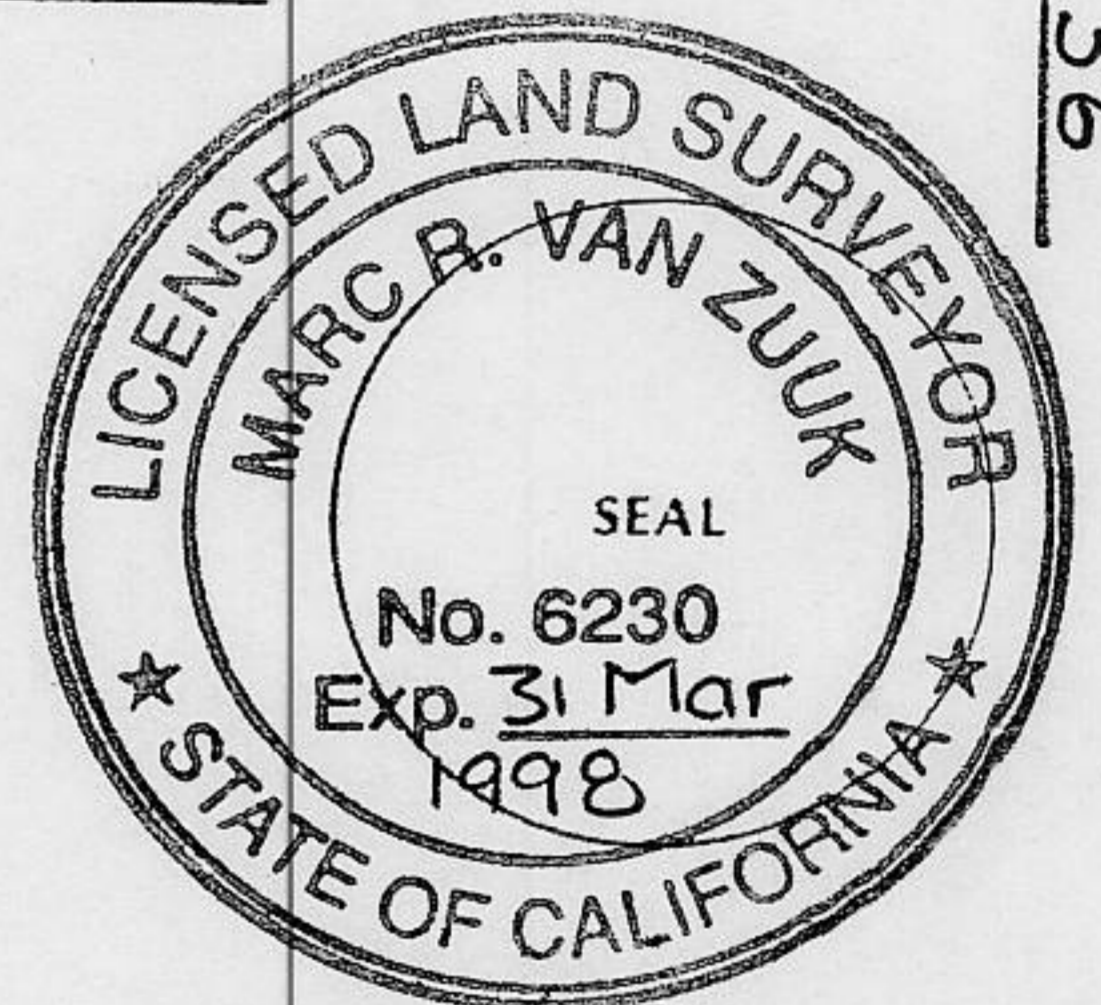

### COUNTY SURVEYOR'S STATEMENT

This Corner Record was received MAY 20 1996 and examined

and filed MAY 31 1996.

Signed [Signature] Title Deputy County Surveyor

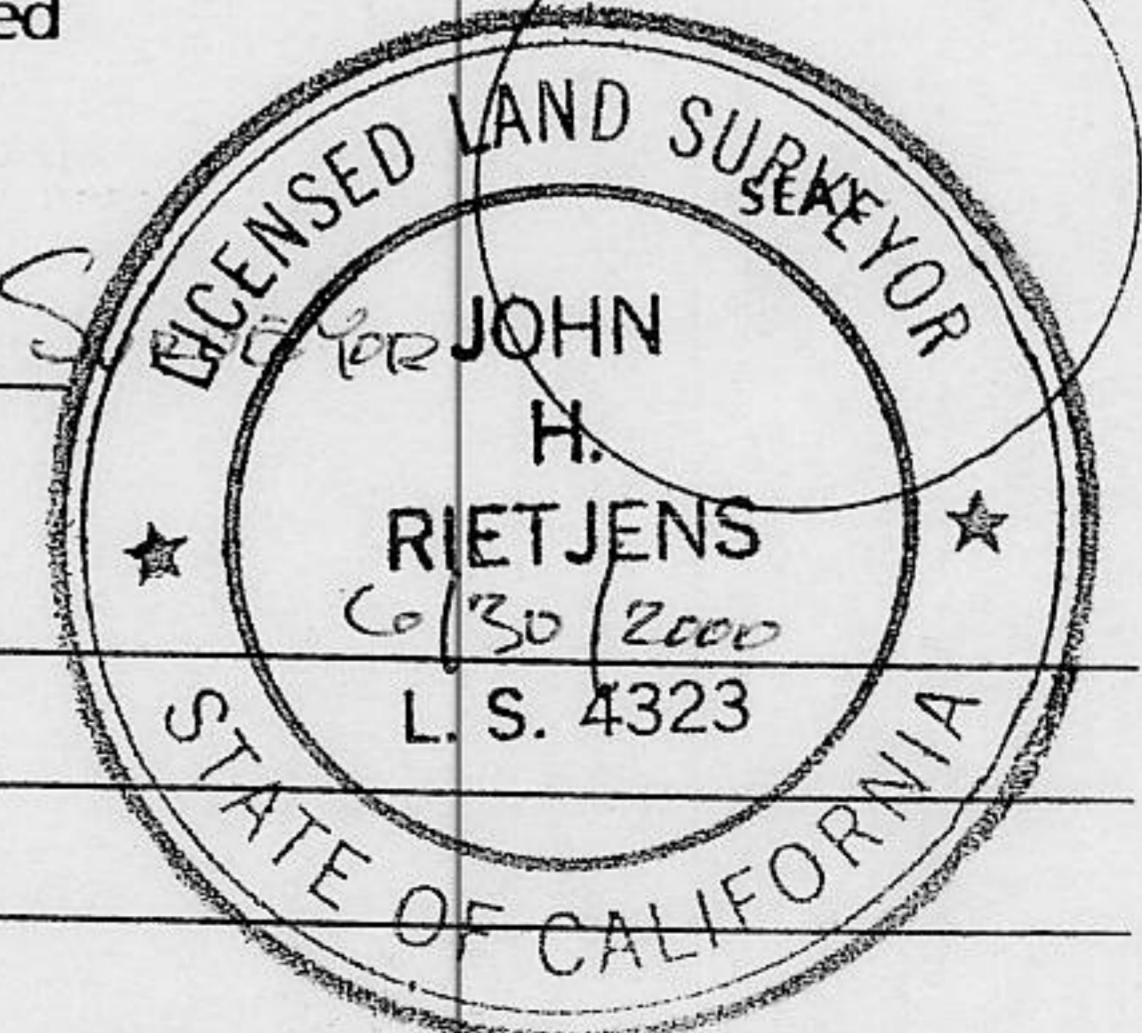

County Surveyor's Comment \_\_\_\_\_

BOOK 5 CORNER RECORDS PAGE 36



Plat of Survey  
of a Portion of Vista Point Subdivision  
... Book R of Maps, Page 19  
South 1/2, Section 3, Township 12 North, Range 08 East  
Placer County California  
May 1996

BOOK \_\_\_\_\_ CORNER RECORDS PAGE \_\_\_\_\_

BOOK 5 CORNER RECORDS PAGE 36

