

CORNER RECORD

Document Number _____

City of N/A County of PLACER, California

Brief Legal Description LOT 15, DOLLAR POINT, UNIT NO. 1, PLACER COUNTY, CALIFORNIA. (MAP BK. 7, PG. 73)

BKF MAPS PG 73

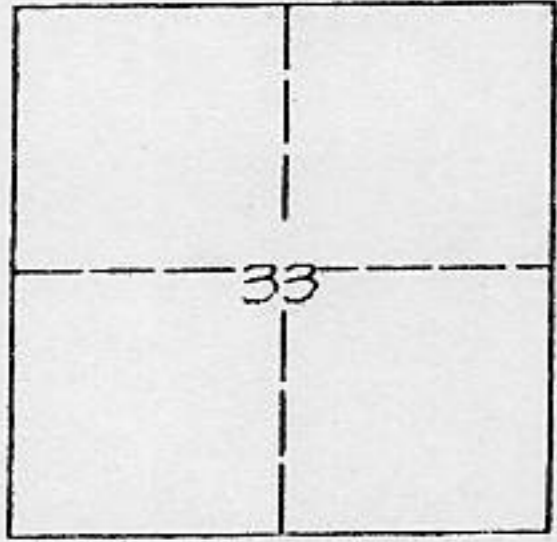

CORNER TYPE

Government Corner Control
 Meander Property
 Rancho Other
 Date of Survey 8 APRIL 1997

COORDINATES (Optional)

N. _____
 E. _____
 Zone _____ Datum _____
 Elev. _____

T. 16 N., R. 17 E., M.D.M.

Corner - Left as found Found and tagged Established Reestablished Rebuilt

Identification and type of corner found: Evidence used to identify or procedure used to establish or reestablish the corner:

● = FOUND MONUMENT AS SHOWN HEREON.

USED NEAREST FOUND MONUMENTS TO REESTABLISH PROPERTY CORNERS AS SHOWN HEREON.

A description of the physical condition of the monument as found and as set or reset:

○ = SET MONUMENT AS SHOWN HEREON.

SURVEYOR'S STATEMENT

This Corner Record was prepared by me or under my direction in conformance with
 the Land Surveyors' Act on 9 APRIL 1997.

Signed Edward Leckey L.S. or R.C.E. Number L.S. 4226
LIC EXP 30 JUN 2000

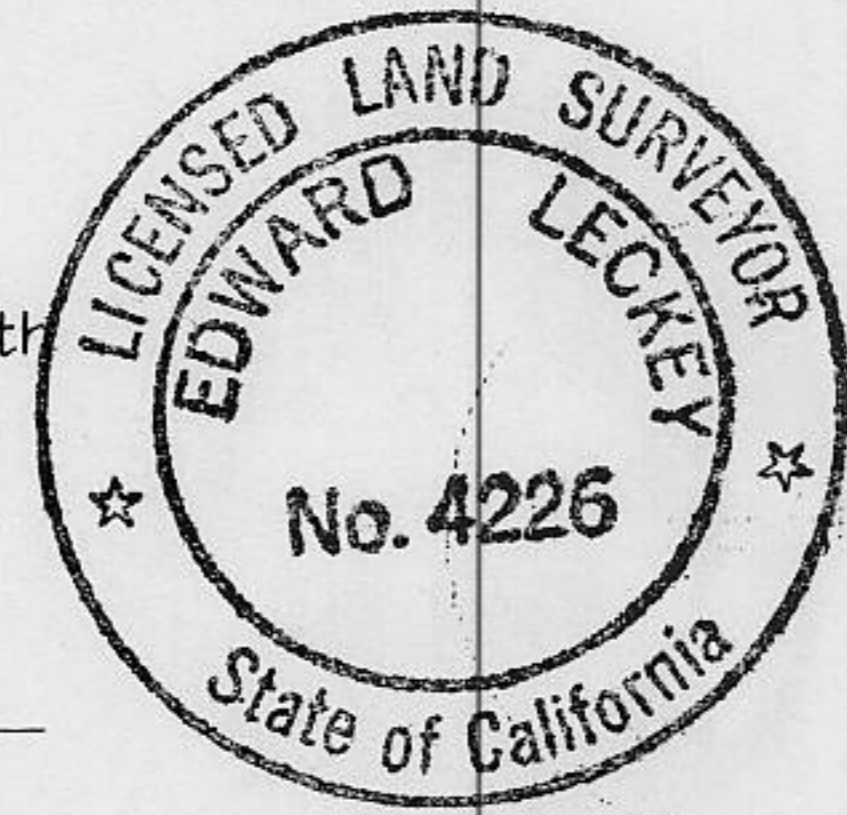

COUNTY SURVEYOR'S STATEMENT

This Corner Record was received June 11, 1997 1997 and examined
 and filed September 1, 1998.

Signed Ned J. Snyder Title Deputy Co. Surveyor

County Surveyor's Comment None

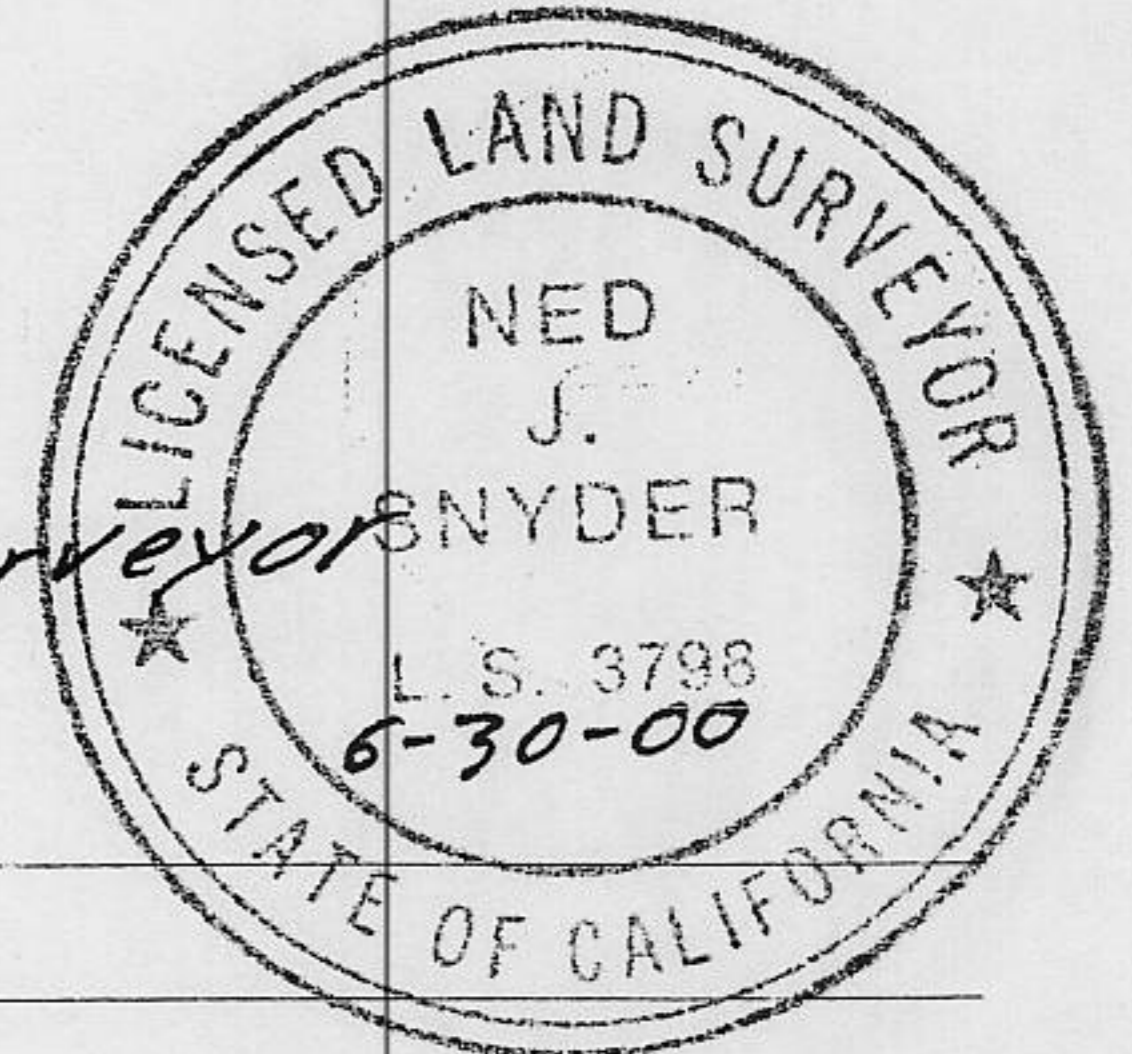

BOOK 5 CORNER RECORDS, PAGE 91



1" = 50'

NOTES

IP= IRONPIPE
FB= REBAR
B OF B=BASIS OF BEARINGS
() = INFORMATION PER F/T3

Book 2
Corner Records
Pg 11

LOT 2

DOLLAR POINT, UNIT NO. 1 F/T3

FD 3/8 RB W/CAP PLS 5728
ACCEPTED AS SOUTH COR
LOTS 4-5-12-13.

(N82°23'30"E 81.18')
N82°22'54"E 81.11'
SET 5/8"X18"RB W/CAP
LS4226.

N 82°23'30"E 162.59'
81.28' (81.18) 81.31'
FD 3/8"RB BENT ± 0.10'
SOUTH OF LINE.

LASSEN
DRIVE

LOT 16

(N 2°10'00"W 178.69')

N 2°10'00"W 178.69'

LOT 15

13737 SQ. FT.

N 2°10'00"W 164.90'

(N 2°10'00"W 164.90')

LOT 14

FD 3/4 I PIN W/TAG RCE 9189 ACCEPTED
AS BC & EC OF CURVE ON NORTH SIDE OF
EDGEWATER R/W AT LOT 17, PER F/T3.

FD 2"IP W 2 1/2"CAP
0.53' SOUTH OF LINE.

SET 3/4"X18" IP W/CAP
LS4226

FD 3/8 RB W/CAP PLS 5728
ACCEPTED AS SOUTH COR
LOTS 11-12.

19.91' 83.31'
N 86°03'27"E 24.87'
N 87°50'00"E
(N 87°50'00"E

EDGE WATER
(60' R/W)

(80.00) 79.96'

488.05'
B OF B 488.32'

244.87'

20.91'
N 2°10'00"W

60.04'

DRIVE

20.98'

N 2°10'00"W

60.00'

FD 5/8 RB W/CAP LS 3422 ACCEPTED
AS NORTH CORNERS OF LOT 29.