

CORNER RECORD

Document Number _____

City of _____

County of Placer, California

Brief Legal Description 1/4 S28 | S27

T16N R16E M.D.M.

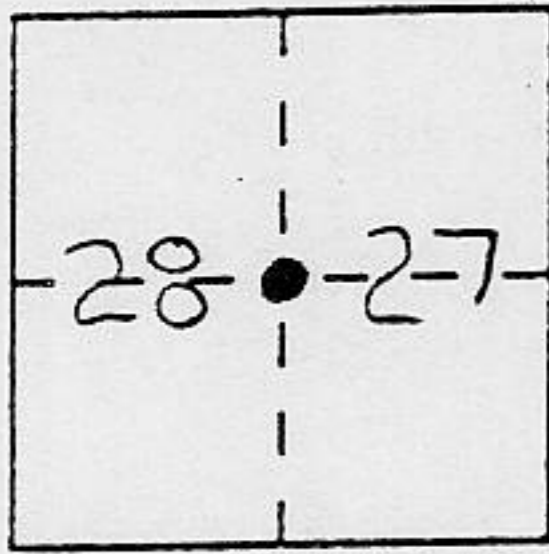

T16N
R16E
M.D.M

CORNER TYPE

Government Corner Control
 Meander Property
 Rancho Other
 Date of Survey 29 June 93

COORDINATES (Optional)

N. _____
 E. _____
 Zone _____ Datum _____
 Elev. _____

Corner — Left as found Found and tagged Established Reestablished Rebuilt

Identification and type of corner found: Evidence used to identify or procedure used to establish or reestablish the corner:

Found BLM Brass Cap in Stone Mound
with accessories per BLM Plat.

Monument tied to project control
for waterline installation by
Tahoe City P.U.D. in Oct. 1991

1/4
S28 | S27
1978

A description of the physical condition of the monument as found and as set or reset:

monument found disturbed by construction. Reset from
control ties to position prior to construction in 1992.
Rebuilt stone mound ± 3" dia by 1" high.
Hale-Tippin Consultants J/N 22.37A

SURVEYOR'S STATEMENT

This Corner Record was prepared by me or under my direction in conformance with
 the Land Surveyors' Act on 30 June 1993.

Signed [Signature] L.S. or R.C.E. Number 6230



COUNTY SURVEYOR'S STATEMENT

This Corner Record was received JULY 6 1993 and examined
 and filed Aug 20 1993.

Signed John Rietjens Title Deputy County Surveyor

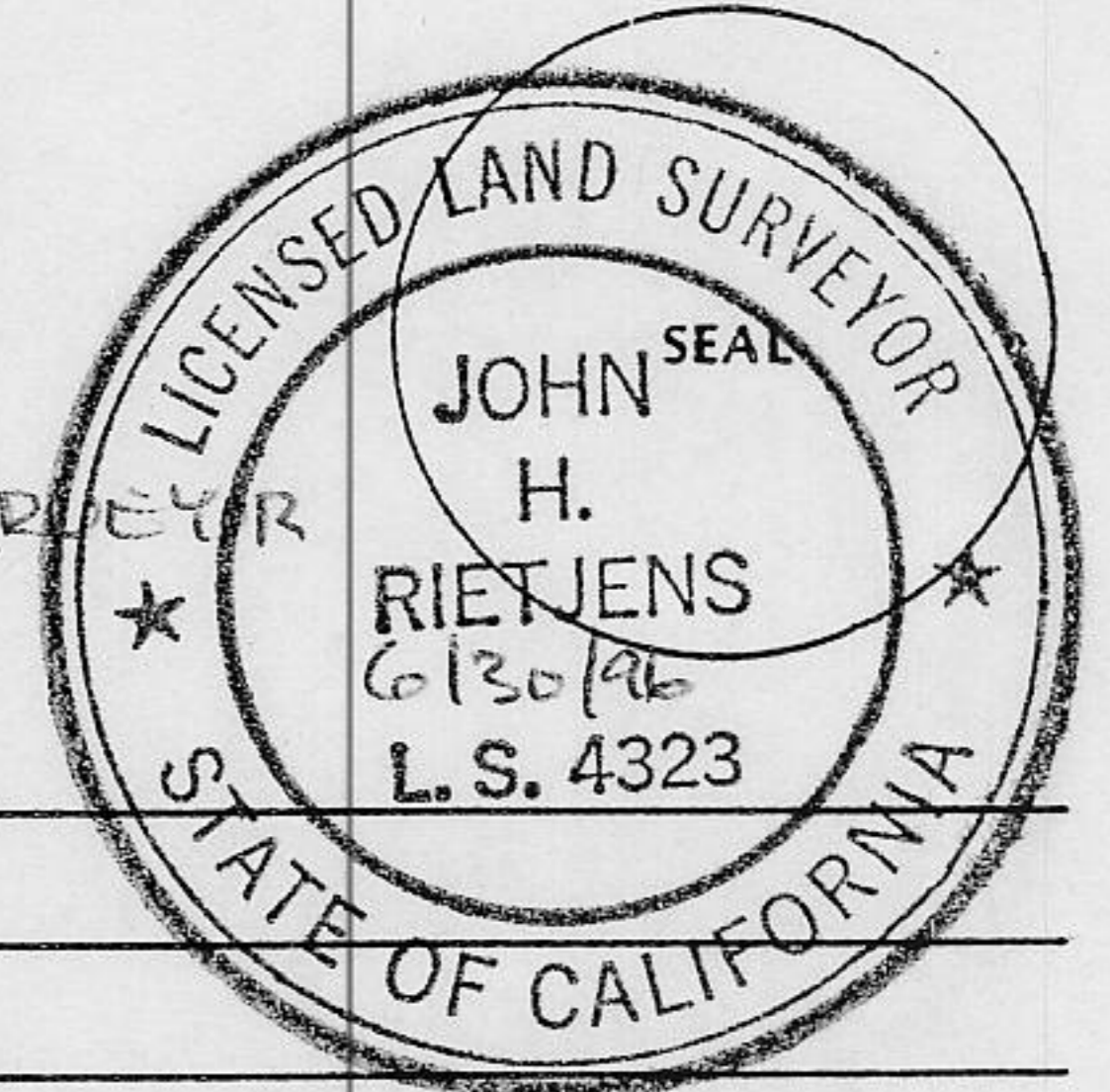

County Surveyor's Comment _____

BOOK 3 CORNER RECORDS PAGE 177