

CORNER RECORD

Document Number _____

City of _____

County of PLACER

California

Brief Legal Description LOT 52, AGATE BAY VISTA UNIT NO. 3, BOOK I, MAPS, PAGE 55

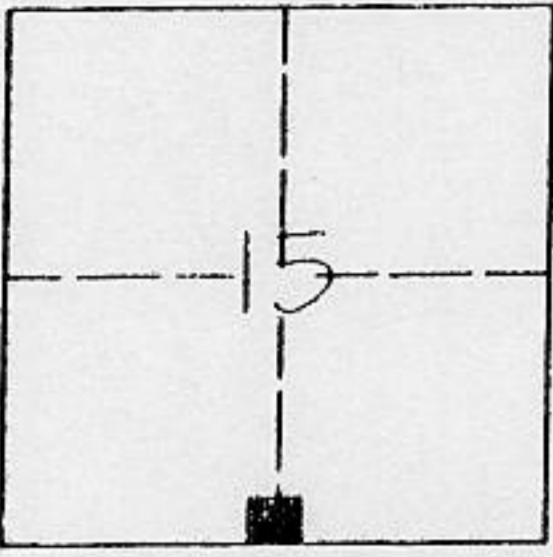

T16N
R17E

CORNER TYPE

Government Corner Control
 Meander Property
 Rancho Other
 Date of Survey JUNE 8, 1998

COORDINATES (Optional)

N. _____
 E. _____
 Zone _____ Datum _____
 Elev. _____

Corner - Left as found Found and tagged Established Reestablished Rebuilt

Identification and type of corner found: Evidence used to identify or procedure used to establish or reestablish the corner:
FOUND 3/4" REBAR AT STREET CENTERLINE CONTROL POINTS, ACCEPTED AS THOSE POINTS SHOWN IN BOOK I, MAPS, PAGE 55. ● - FOUND MONUMENT.

A description of the physical condition of the monument as found and as set or reset: ○ - SET 5/8" X 24" REBAR AND CAP, STAMPED "LS 4878".

SURVEYOR'S STATEMENT

This Corner Record was prepared by me or under my direction in conformance with the Land Surveyors' Act on JUNE 16, 1998.

Signed [Signature] L.S. or R.C.E. Number L.S. 4878

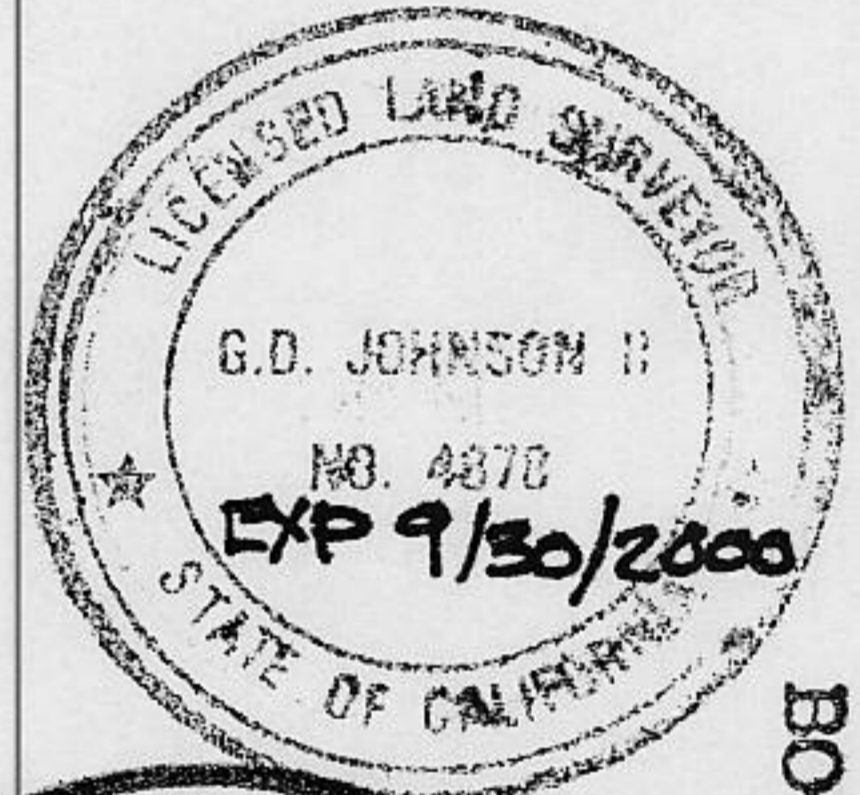

COUNTY SURVEYOR'S STATEMENT

This Corner Record was received October 5, 1998 and examined and filed October 26, 2000.

Signed [Signature] Title COUNTY SURVEYOR
L.S. 4323

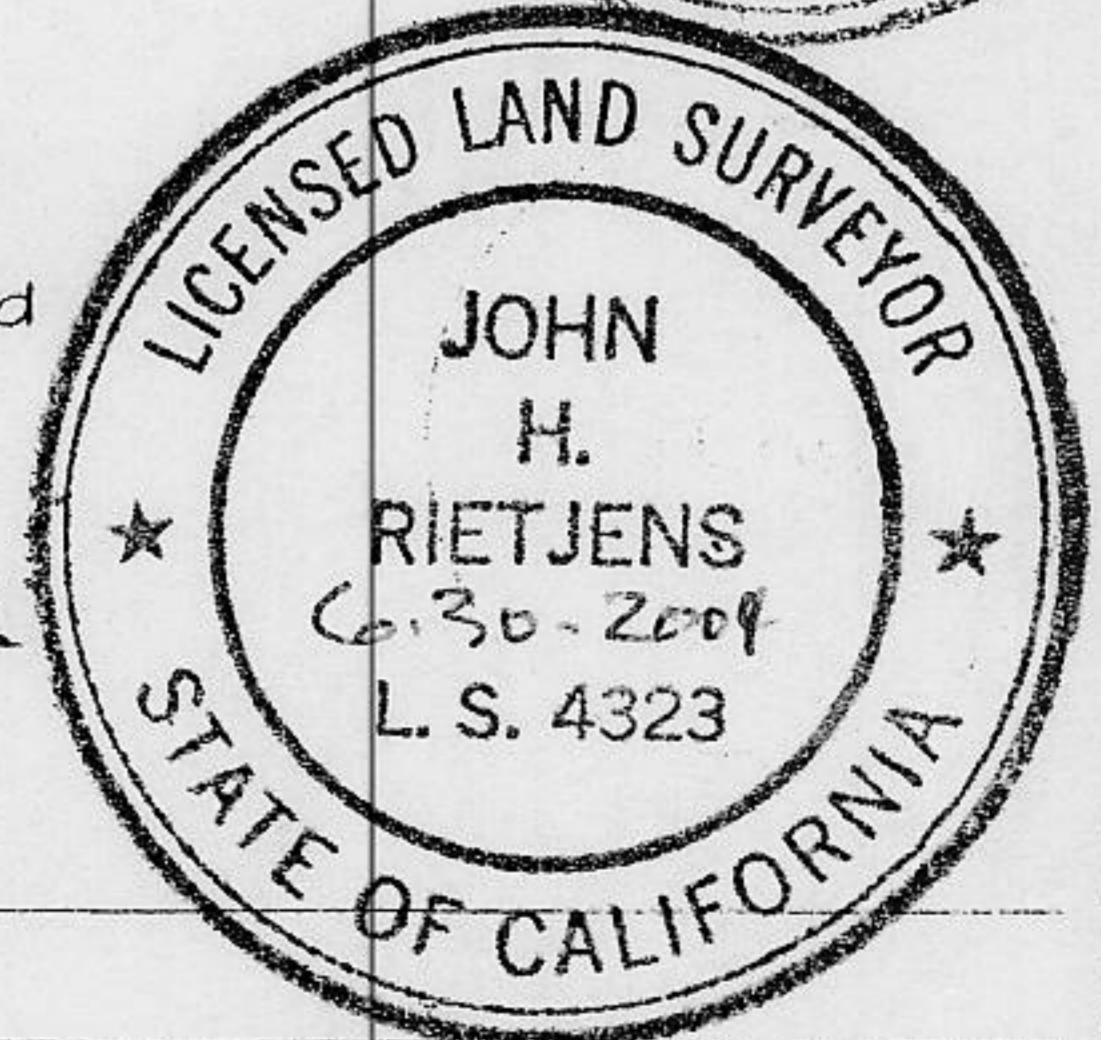

County Surveyor's Comment _____

BOOK 1 CORNER RECORDS PAGE 13



SCALE
1"=50'

RHODESIA ROAD
(50' R/W)

N79°49'00"W 241.33'

N79°49'00"W 196.33'

90.00'

9.81'

96.52'

R=20'

D=89°59'29"

L=31.41'

LOT 52

R=1245'

D=2°57'15"

L=64.19'

N 82°53'10"W(R)

118.43'

FND 1/2" REBAR
NO TAG

N 17°29"E 0.12'

LOT 53

N 5°04'30"E 217.26'

R=1220'

DAKAR ROAD
(50' R/W)

45.00'

N 10°11'00"E

257.11'

LOT 51

FND 1/2"
REBAR
NO TAG

N 10°11'00"E 137.50'

93.01'

44.49'

N 3°41'17"E
49.96'

LOT 55

JOB NO. 98119