

CORNER RECORD

COUNTY OF PLACER, CALIFORNIA

City of \_\_\_\_\_ Document Number \_\_\_\_\_

Brief Legal Description Lot 74, Kingswood Estates Unit No. 1 Book "I" Maps, Page 11



T.16N., R.17E.

CORNER TYPE

COORDINATES (Optional)

Government Corner  Control  N. \_\_\_\_\_  
 Meander  Property  E. \_\_\_\_\_  
 Rancho  Other  Zone \_\_\_\_\_ Datum \_\_\_\_\_  
 Date of Survey \_\_\_\_\_ Elev. \_\_\_\_\_

Corner- Left as found  Found and tagged  Established  Reestablished  Rebuilt

Identification and type of corner found: Evidence used to identify or procedure used to establish or reestablish corner:

● ~ found monument as noted

A description of the physical condition of the monument as found and as set or reset:

∅ set 5/8" rebar L.S. 5886

SURVEYOR'S STATEMENT

This Corner Record was prepared by me or under my direction in conformance with the Land

Surveyor's Act on 8-20 19 98

Signed [Signature] L.S. or R.C.E. Number 5886

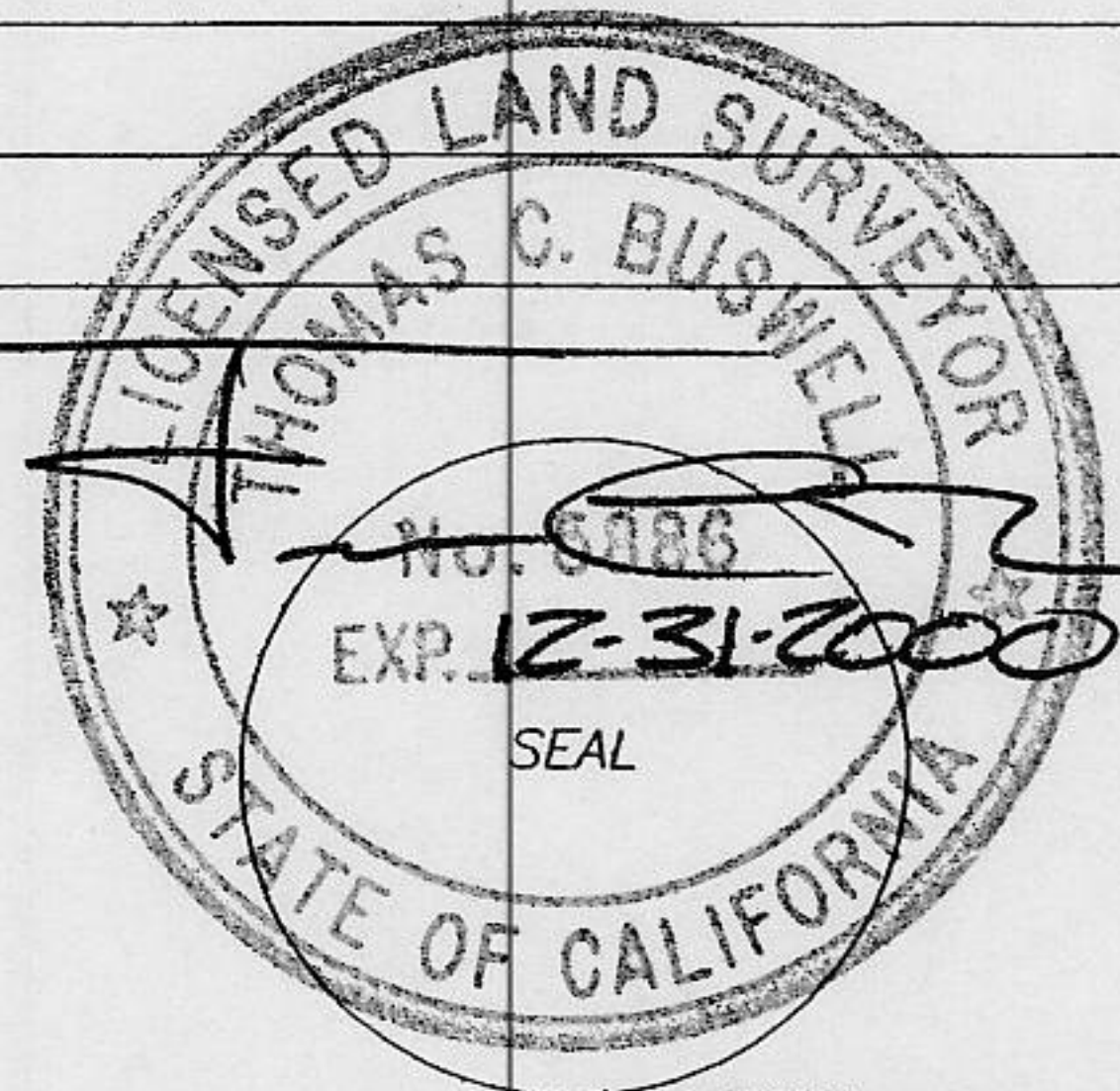

COUNTY SURVEYOR'S STATEMENT

This Corner Record was received August 27, 19 98 and examined

and filed April 11, 19 2000

Signed [Signature] Title Deputy Co. Surveyor

County Surveyor's Comment \_\_\_\_\_

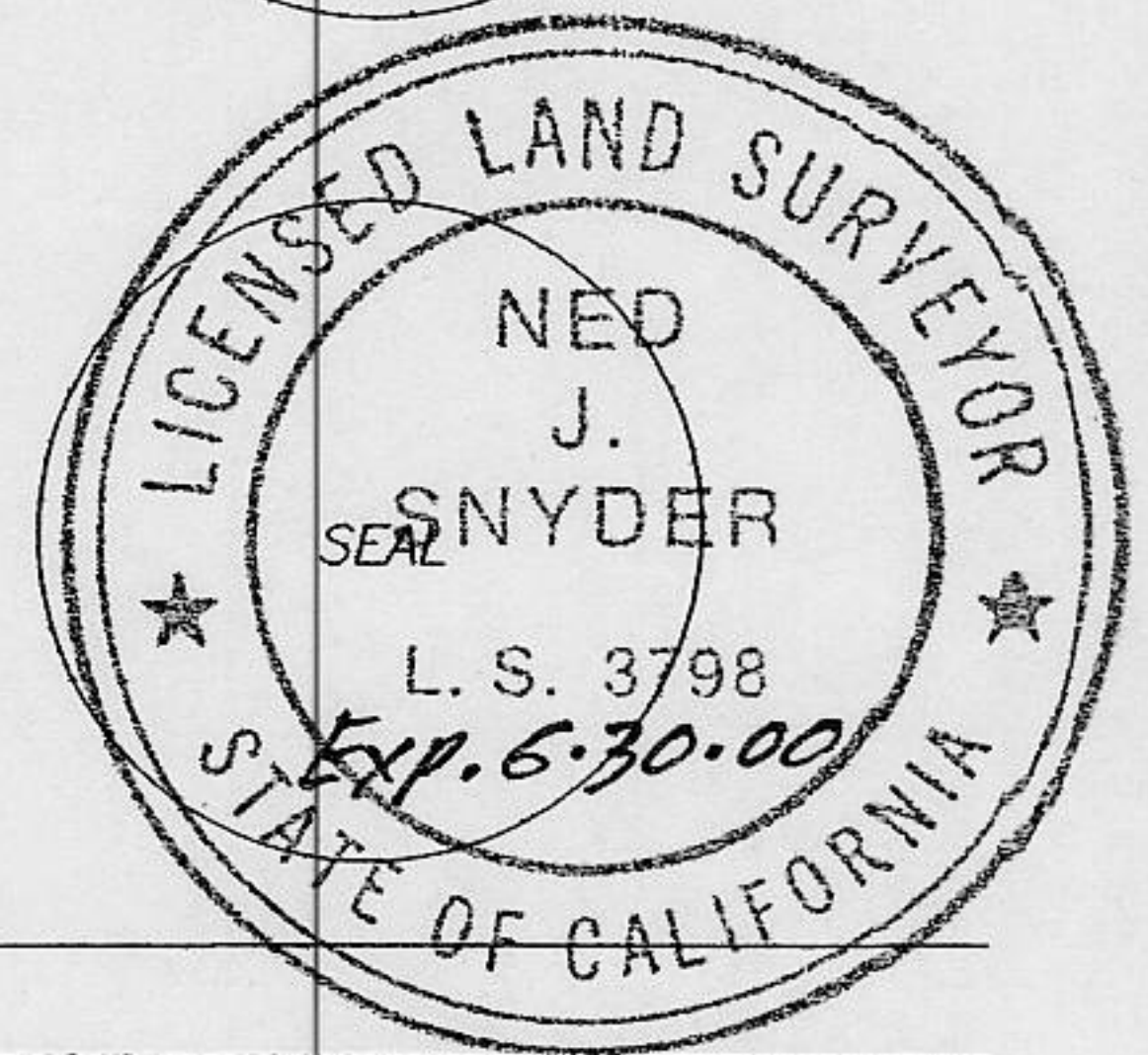

BOOK 6 CORNER RECORDS PAGE 61



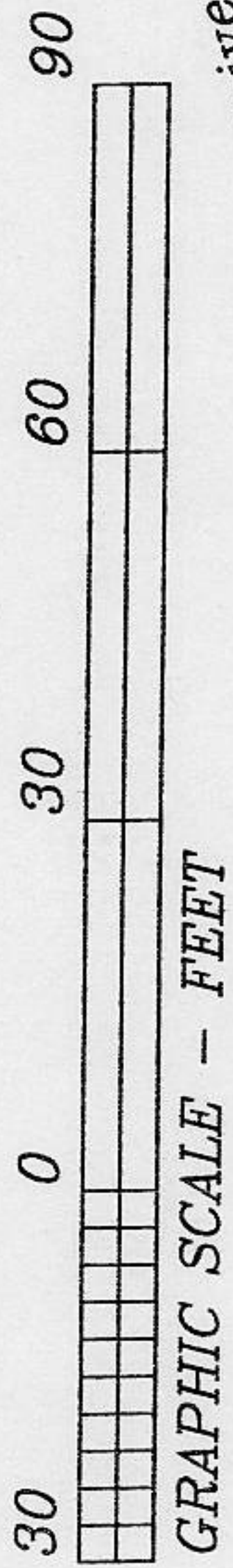

FD. BAR

S 20°54'41"E  
25.00'

Kingswood Drive  
S 69°05'19"W 179.85'

S 69°05'19"W  
48.85'

set bar L.S. 5886

S 69°05'19"W 76.00'

FD. BAR

FD. BAR LS 6230

scale 1" = 30'

N 20°54'41"W 147.45'

S 20°54'41"E 131.50'

FD. 1/2" BAR, NO TAG

N 80°56'38"E 77.66'

FD. 1/2" BAR, NO TAG

73

74

75