

CORNER RECORD

Document Number _____

City of N/A

County of PLACER

California

Brief Legal Description LOT 100, AGATE BAY UPLANDS (BK.G/MAPS/PG.42)

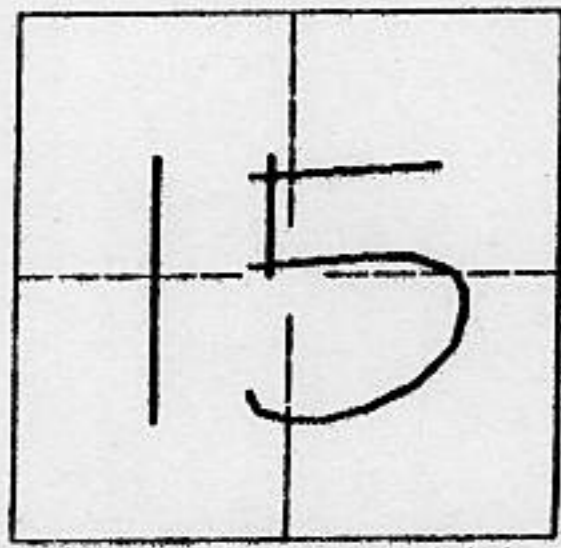

CORNER TYPE

Government Corner Control
 Meander Property
 Rancho Other
 Date of Survey 06/23/97

COORDINATES (Optional)

N. _____
 E. _____
 Zone _____ Datum _____
 Elev. _____

SECT. 15, T. 16N., R. 17E.

Corner - Left as found Found and tagged Established Reestablished Rebuilt

Identification and type of corner found: Evidence used to identify or procedure used to establish or reestablish the corner:
 • FOUND MONUMENT AS SHOWN HEREON

A description of the physical condition of the monument as found and as set or reset:

- SET MONUMENT 5/8"X18" REBAR W/ CAP STAMPED LS 4226
- FOUND MONUMENT-SET CAP STAMPED LS 4226

SURVEYOR'S STATEMENT

This Corner Record was prepared by me or under my direction in conformance with

the Land Surveyors' Act on 16 JULY, 1997

Signed Edward Leckey L.S. or P.C.E. Number 4226

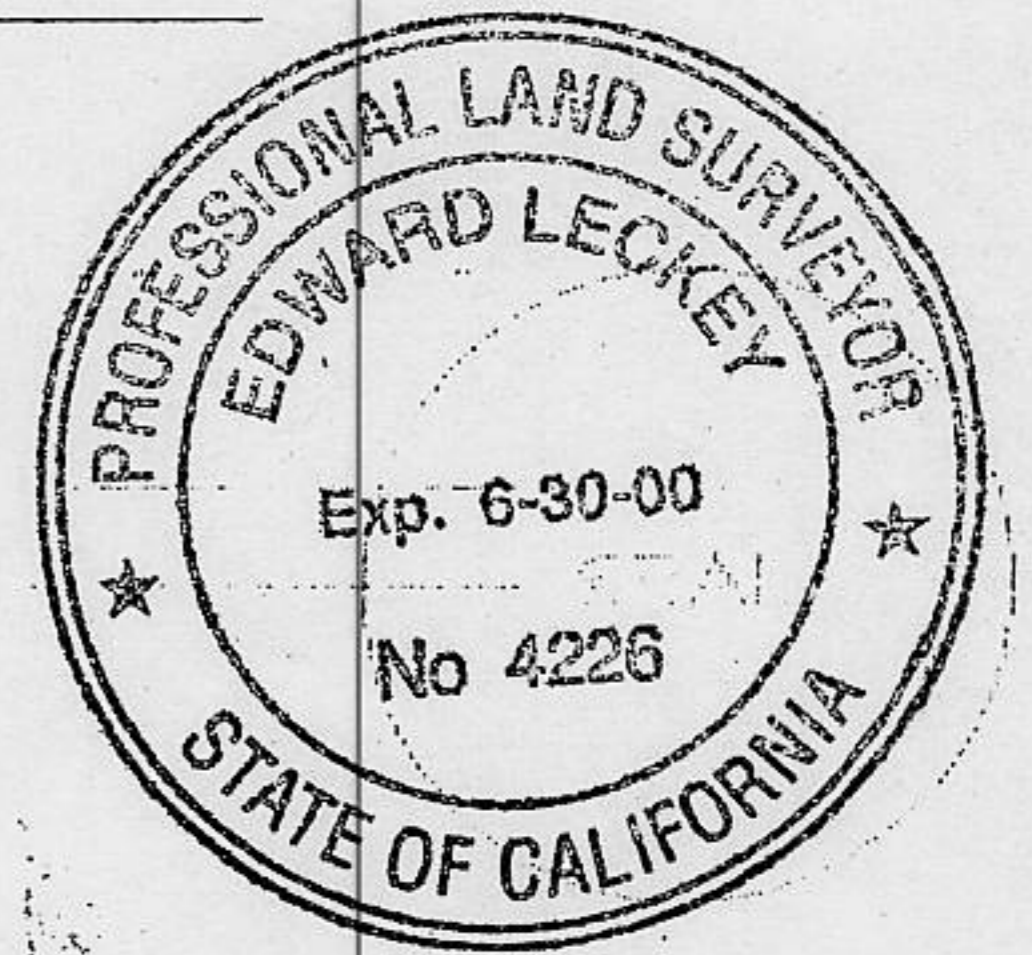

COUNTY SURVEYOR'S STATEMENT

This Corner Record was received July 23, 1997 and examined

and filed November 5, 1998

Signed Ned J. Snyder Title Deputy Co. Surveyor

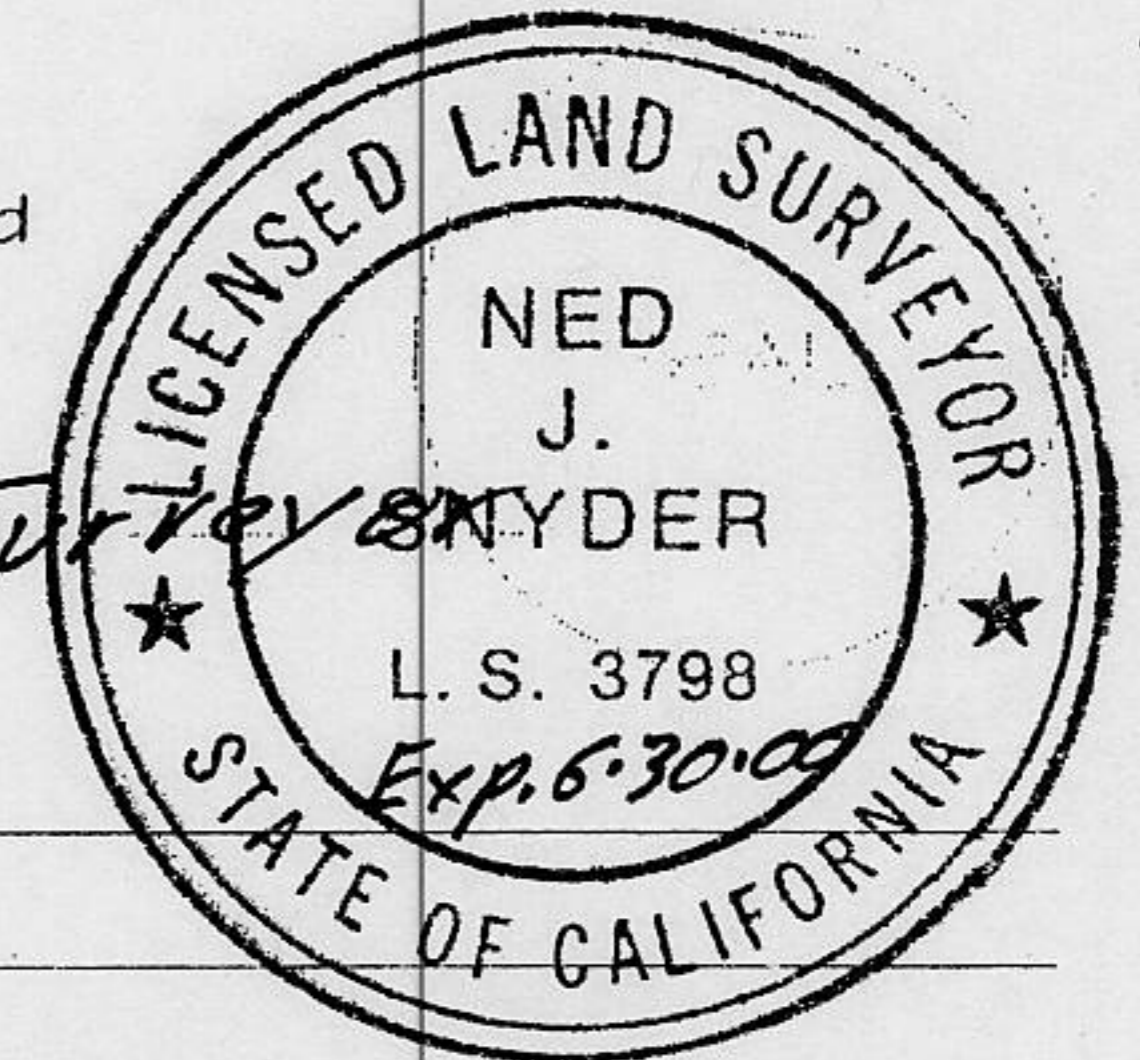

County Surveyor's Comment _____

BOOK 6 OF CORNER RECORDS, PAGE 8



NORTH
SCALE - 1" = 40'

FD 5/8" RB/CAP LS6460
N 23°51'27"W 22.28'(M)
22.00'(I)

LOT 99

LOT 89

BASIS OF BEARINGS
N 57°28'15"E 130.00' RAD(I)
131.57'(M)

AGATE BAY UPLANDS
(BK. 6/MAPS/PG. 42)

LOT 100

AREA = 14,157 S.F. ±

FD 1/2" RB SET CAP LS4226

N57°24'30"E RAD.
N34°44'21"E
31.14' CH
R=400'

D=6°40'44"
L=46.63'
T=23.34'
CH=N 35°50'52"W
46.60'
46.64'(I)

N53°01'47"E
50.13' RAD.

FD 1/2" RB SET CAP LS4226

DODONAH ROAD
(50' R/W)
N50°48'46"E RAD.
R=550'

D=6°20'01"
L=61.90'
T=30.98'
CH=N 36°01'13"W
61.87'
61.76'(I)

FD 1/2" RB
N36°04'06"W
17.67'
17.36' (R)

FD 1/2" RB BENT

N 57°08'47"E 130.94'(M)
130.00'(I) RAD.

SET 5/8" X 1/8" RB/CAP LS4226
SH 6.00' ON PL, AS WC

LOT 90

N57°08'47"E
RAD.

SET 5/8" X 1/8" RB/CAP LS4226

LOT 101

N31°18'05"W
30.34' CH

D=8°42'44"
L=85.17'
T=42.66'
CH=N 28°24'48"W
85.08'
85.00'(I)

FD 5/8" RB/CAP PL53422

LOT 91

FD 3/8" RB

FD 1/2" RB

N 65°41'03"E 130.53'(M)
130'(I)

LOT 102

N65°51'36"E
RAD.

FD 1/2" RB W2*2