

CORNER RECORD

Document Number _____

City of _____

County of PLACER, California

Brief Legal Description LOT 171, BOOK Q OF MAPS, PAGE 57.

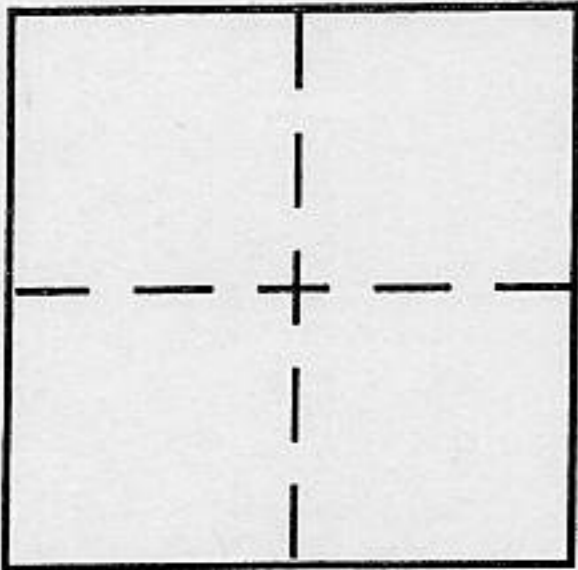

CORNER TYPE

Government Corner Control
Meander Property
Rancho Other
Date of Survey DECEMBER 15, 2000

COORDINATES (Optional)

N. _____
E. _____
Zone _____ NAD27 NAD83
NAD83 Epoch _____
Elev. _____
Vert. Datum: NGVD29 NAVD88
Meas. Units: Metric Imperial

Corner - Left as found Found and tagged Established Reestablished Rebuilt

Identification and type of corner found: Evidence used to identify or procedure used to establish or reestablish the corner:

SEE PAGE 2

A description of the physical condition of the monument as found and as set or reset:

SEE PAGE 2

SURVEYOR'S STATEMENT

This Corner Record was prepared by me or under my direction in conformance with

the Land Surveyor's Act on MARCH 8 2001

Signed L. Dean Baker P.L.S or R.C.E. No. 6746

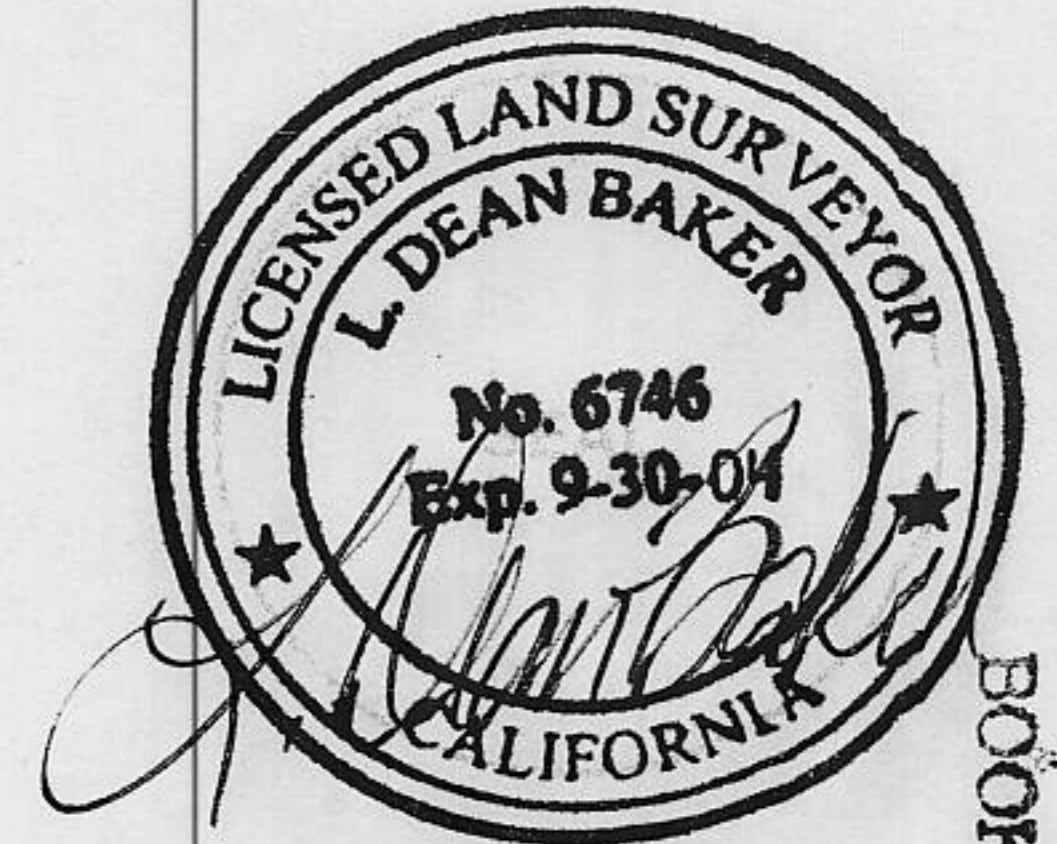

COUNTY SURVEYOR'S STATEMENT

This Corner Record was received MARCH 27, 2001

and examined and filed April 17, 2001

Signed John H. Rietjens P.L.S or R.C.E. No. 4323

Title County Surveyor

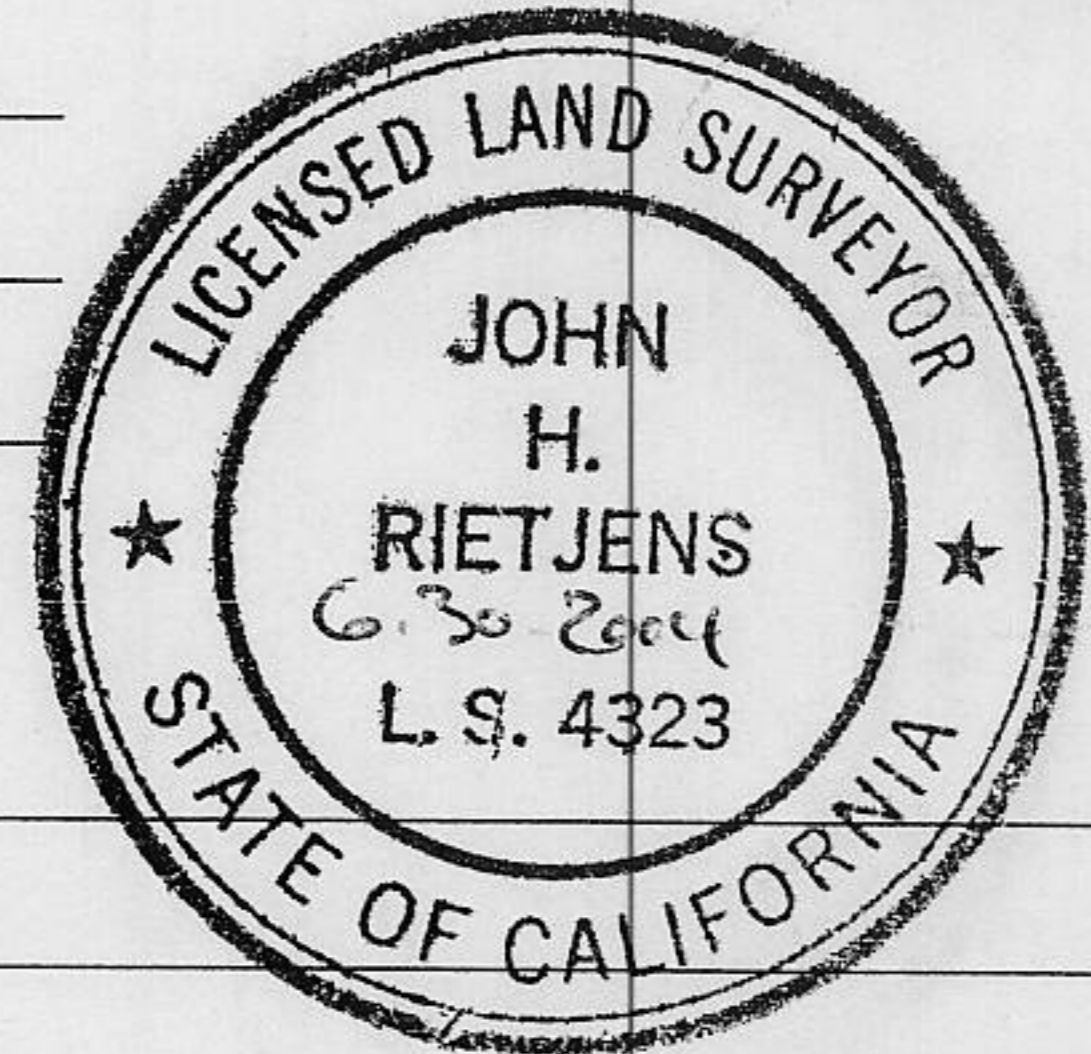

County Surveyor's Comment _____

BOOK Q CORNER RECORDS PAGE 97

JOB NO. 1249-00-0706

FND. 2" BRASS CAP IN MONUMENT BOX STAMPED L.S. 4715
 FND. 5/8" REBAR W/TAG L.S. 4715 UNLESS OTHERWISE NOTED
 SET LEAD + TACK WITH TAG "L.S. 6746"
 RECORD DATA PER Q MAPS 57 (I) OR (II)

LEGEND

SCALE: 1"=80'

