

CORNER RECORD

Document Number _____

City of _____ County of Placer, California

Brief Legal Description Lot 36, Carnelian Heights No. 2, G-23
Portion NW 1/4, S 28, T 16 N, R 17 E, M.D.M.

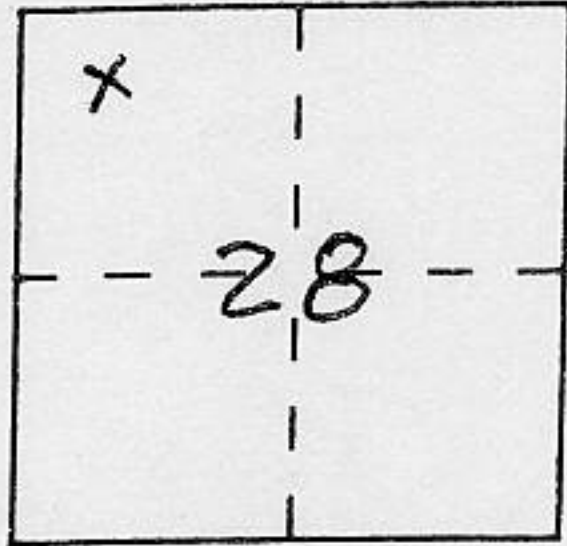

CORNER TYPE

Government Corner Control
 Meander Property
 Rancho Other
 Date of Survey 6-24-94

COORDINATES (Optional)

N. _____
 E. _____
 Zone _____ Datum _____
 Elev. _____

Corner — Left as found Found and tagged Established Reestablished Rebuilt

Identification and type of corner found: Evidence used to identify or procedure used to establish or reestablish the corner:

See pg. 2

A description of the physical condition of the monument as found and as set or reset:

See pg. 2

SURVEYOR'S STATEMENT

This Corner Record was prepared by me or under my direction in conformance with the Land Surveyors' Act on 6-27 1994.

Signed Ronald W. Turner L.S. or R.C.E. Number 4029

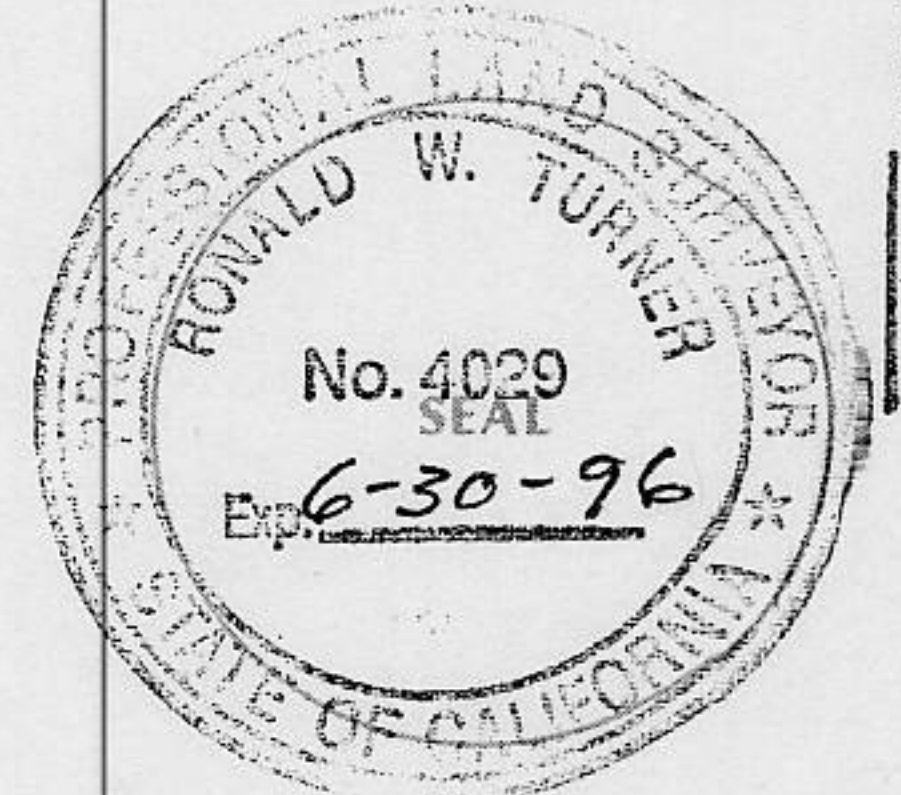

COUNTY SURVEYOR'S STATEMENT

This Corner Record was received JULY 14 1994 and examined

and filed 7/20 1994.

Signed John Riebens Title Deputy County Surveyor

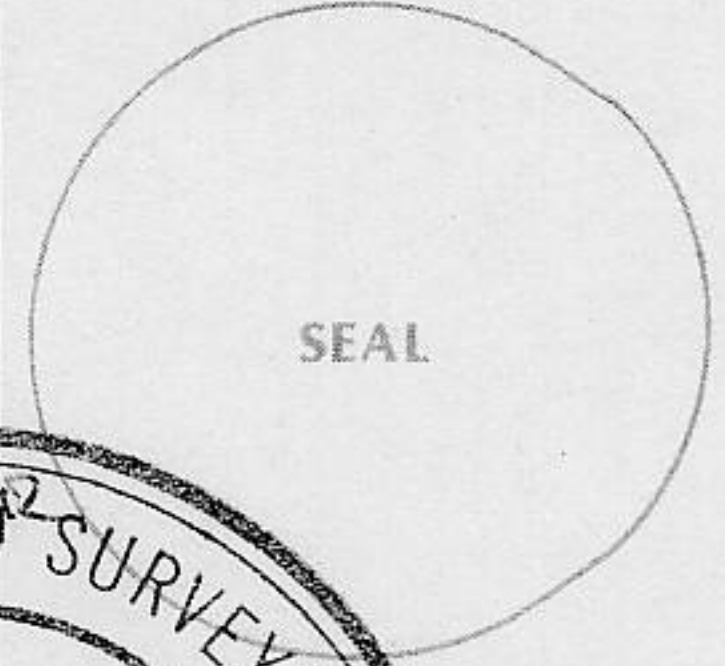

County Surveyor's Comment _____

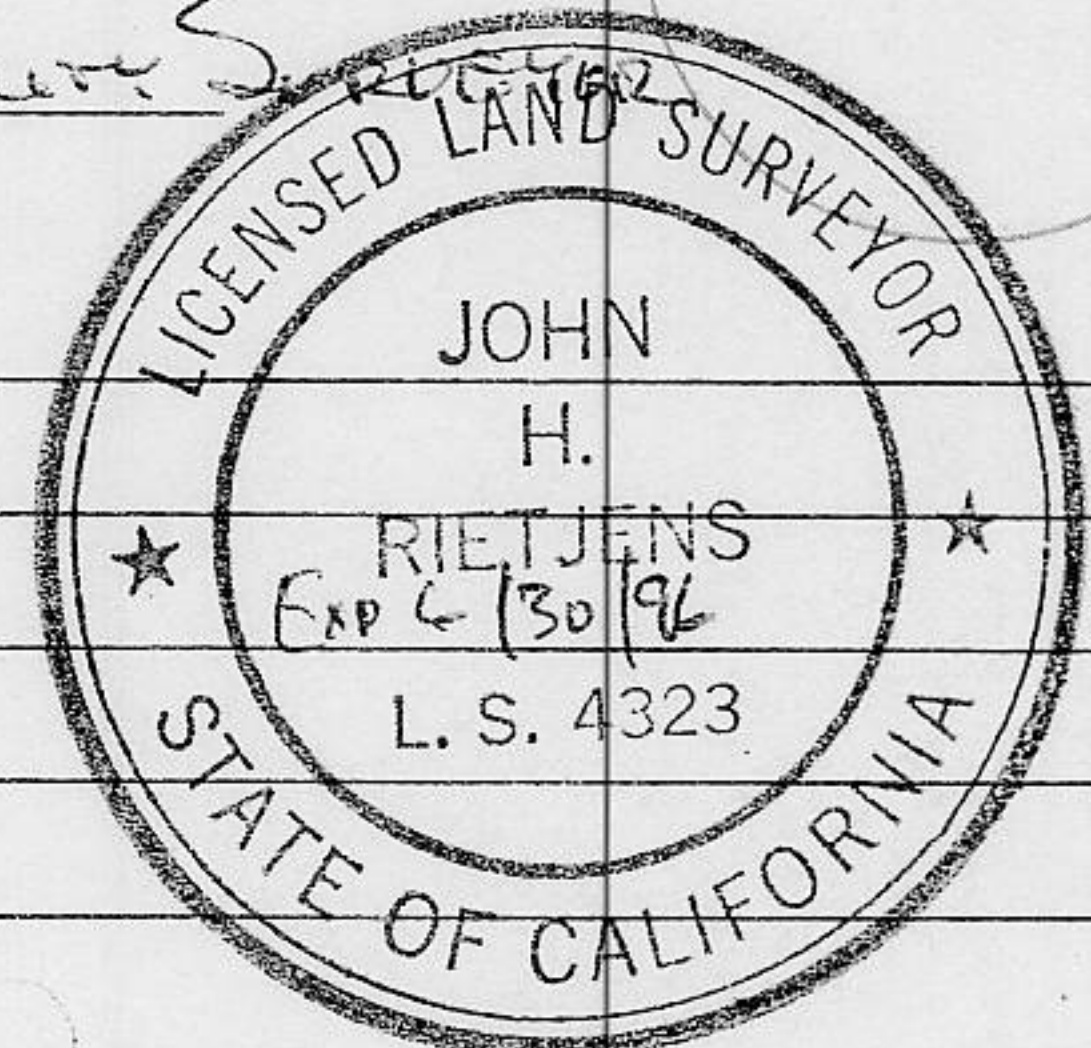

BOOK 4 CORNER RECORDS PAGE 51



- ... End 5/8" bar stamped LS 2515
- ... End 1/2" bar, set cap LS 4029, or as noted.
- ... Set 3/4" IP & plug LS 4029