



PLACER, County Recorder  
 RYAN RONCO  
 DOC- 2020-0129022-00

**RECORDING REQUESTED BY:**

Community Development  
 Resource Agency

TUESDAY, NOV 10, 2020 11:27 AM  
 MIC \$3.00 | AUT \$0.00 | SBS \$0.00  
 ERD \$0.00 | SB2 \$0.00 | MAP \$5.00  
 ADD \$0.00

Ttl Pd \$8.00 Rcpt # 02958271  
 CLKBZRK9T2/DB/1-1

TYPE OF MAP: Community Facilities District Map

BOOK: 4

PAGE: 8

NAME: Community Facilities District No. 2018-3  
 Placer Vineyards – Parks, Open Space, and Landscaping  
 Consolidated Boundary Map  
 County of Placer

NO. OF SHEETS: 1

REFERENCE TO RECORDED MAP: BOOK 3 PAGE 82

**CONSOLIDATED BOUNDARY MAP  
OF COUNTY OF PLACER**

**COMMUNITY FACILITIES DISTRICT NO. 2018-3  
(PLACER VINEYARDS - PARKS, OPEN SPACE, AND LANDSCAPING)**

COUNTY OF PLACER • STATE OF CALIFORNIA  
SEPTEMBER 2020

CFD BOUNDARY APNS	
023-200-045	(14) 023-420-014 (29) 023-390-004
023-200-066	(15) 023-420-015 (30) 023-390-005
(1) 023-420-001	(16) 023-420-016 (31) 023-390-006
(2) 023-420-002	(17) 023-420-017 (32) 023-390-007
(3) 023-420-003	(18) 023-420-018 (33) 023-390-008
(4) 023-420-004	(19) 023-420-019 (34) 023-390-009
(5) 023-420-005	(20) 023-420-020
(6) 023-420-006	(21) 023-420-021
(7) 023-420-007	(22) 023-420-022
(8) 023-420-008	(23) 023-420-023
(9) 023-420-009	(24) 023-420-024
(10) 023-420-010	(25) 023-420-025
(11) 023-420-011	(26) 023-390-001
(12) 023-420-012	(27) 023-390-002
(13) 023-420-013	(28) 023-390-003

FUTURE ANNEXATION AREA APNS			
1: 023-400-001	16: 023-410-006	023-200-006	023-410-019
2: 023-400-002	17: 023-410-007	023-200-037	023-410-020
3: 023-400-003	18: 023-410-008	023-200-062	023-410-021
4: 023-400-004	19: 023-410-009	023-200-063	023-410-022
5: 023-400-005	20: 023-410-010	023-200-018	023-180-006
6: 023-400-006	21: 023-410-011	023-200-028	023-150-026
7: 023-400-007	22: 023-410-012	023-200-029	023-200-008
8: 023-400-008	23: 023-410-013	023-200-069	023-160-011
9: 023-400-009	24: 023-410-014	023-200-015	023-010-014
10: 023-400-010	25: 023-410-015	023-200-041	023-010-006
11: 023-410-001	26: 023-410-016	023-200-013	023-400-014
12: 023-410-002	27: 023-410-017	023-200-009	023-400-013
13: 023-410-003	28: 023-410-023	023-200-010	023-400-012
14: 023-410-004	29: 023-410-024	023-200-011	023-400-011
15: 023-410-005	023-200-017	023-200-068	023-410-018

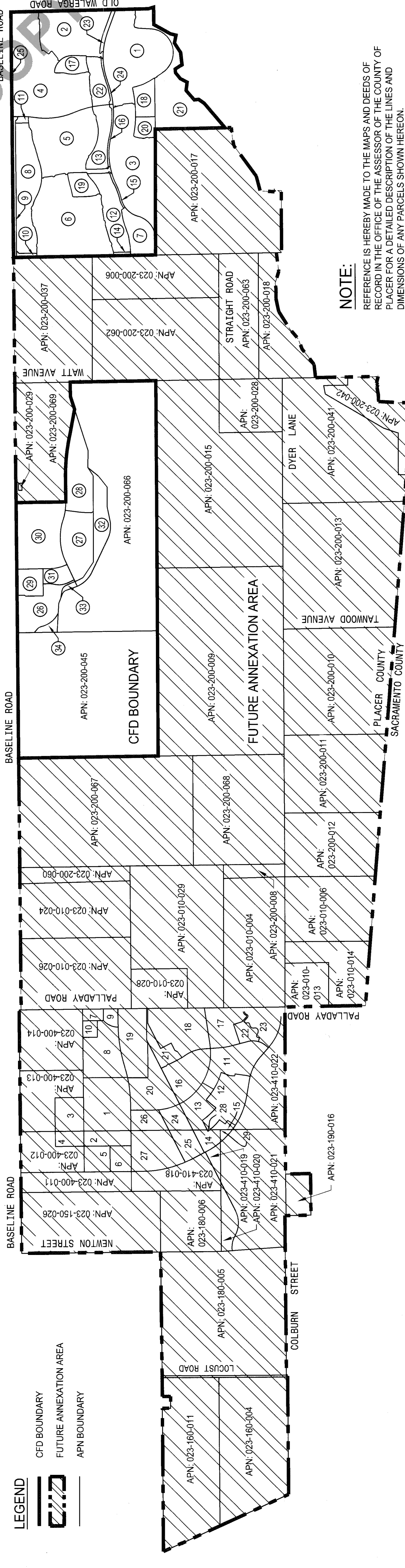
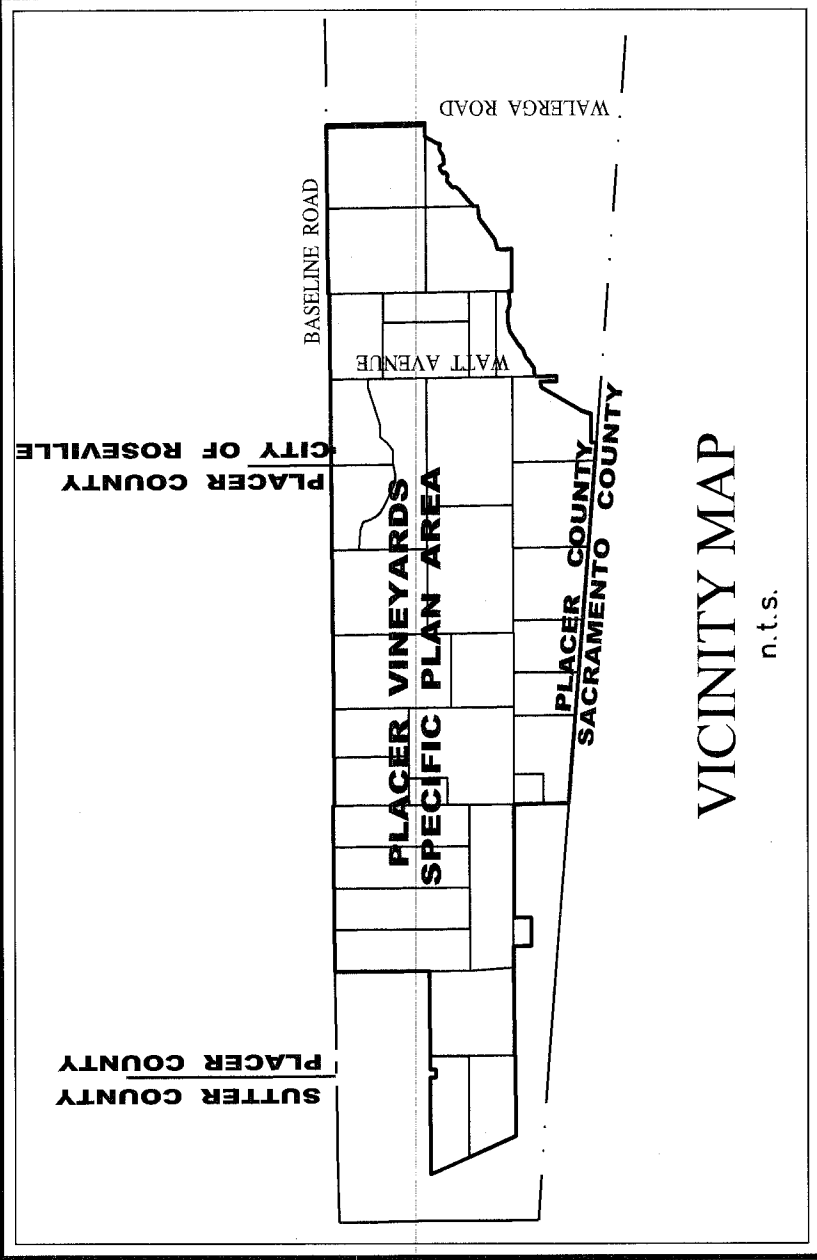

**NOTE:**  
REFERENCE IS HEREBY MADE TO THE MAPS AND DEEDS OF RECORD IN THE OFFICE OF THE ASSESSOR OF THE COUNTY OF PLACER FOR A DETAILED DESCRIPTION OF THE LINES AND DIMENSIONS OF ANY PARCELS SHOWN HEREON.

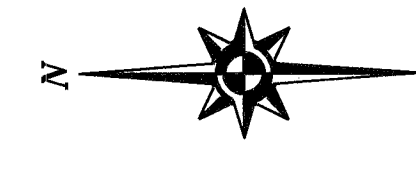

**CLERK'S MAP STATEMENT:**

THIS CONSOLIDATED BOUNDARY MAP REFLECTS THE ANNEXATION OF CERTAIN PARCELS FROM THE FUTURE ANNEXATION AREA INTO COUNTY OF PLACER COMMUNITY FACILITIES DISTRICT NO. 2018-3 (PLACER VINEYARDS - PARKS, OPEN SPACE, AND LANDSCAPING), COUNTY OF PLACER, STATE OF CALIFORNIA. THIS CONSOLIDATED BOUNDARY MAP SUPERSEDES THE MAP ENTITLED "PROPOSED BOUNDARIES AND FUTURE ANNEXATION AREA OF COUNTY OF PLACER COMMUNITY FACILITIES DISTRICT NO. 2018-3, COUNTY OF PLACER, STATE OF CALIFORNIA" RECORDED ON THE 20TH DAY OF NOVEMBER, 2018, AT THE HOUR OF 2:32 O'CLOCK P.M., IN BOOK 3 OF MAPS OF ASSESSMENT AND COMMUNITY FACILITIES DISTRICT AT PAGE 82 IN THE OFFICE OF THE COUNTY RECORDER IN THE COUNTY OF PLACER, STATE OF CALIFORNIA.

**CLERK'S MAP FILING STATEMENT**

FILED IN THE OFFICE OF THE CLERK OF THE BOARD OF SUPERVISORS OF THE COUNTY OF PLACER THIS 27<sup>th</sup> DAY OF October 2020.

*Megan Wood*  
CLERK

**RECORDER'S STATEMENT**

FILED THIS 10<sup>th</sup> DAY OF November, 2020, AT THE HOUR OF 11:27 O'CLOCK A.M. IN BOOK 4 OF MAPS OF ASSESSMENT AND COMMUNITY FACILITIES DISTRICTS AT PAGE 8 IN THE OFFICE OF THE COUNTY RECORDER IN THE COUNTY OF PLACER, STATE OF CALIFORNIA.

FEE \$ 8.00 RYAN RONCO  
FILE NO. 2020-0129-022 PLACER COUNTY RECORDER  
*D. Burtner*  
DEPUTY

**CLERK'S MAP CERTIFICATE**

I HEREBY CERTIFY THAT THE WITHIN CONSOLIDATED BOUNDARY MAP AND THE FUTURE ANNEXATION AREA OF COUNTY OF PLACER COMMUNITY FACILITIES DISTRICT NO. 2018-3 (PLACER VINEYARDS - PARKS, OPEN SPACE, AND LANDSCAPING), COUNTY OF PLACER, STATE OF CALIFORNIA, WAS APPROVED BY THE BOARD OF SUPERVISORS OF THE COUNTY OF PLACER, AT A MEETING THEREOF, HELD ON THE 27<sup>th</sup> DAY OF October, 2020, BY ITS RESOLUTION NO. 2020-229

*Megan Wood*  
CLERK