

CORNER RECORD

COUNTY OF PLACER, CALIFORNIA

City of _____

Document Number _____ "D" Maps, Page 92

Brief Legal Description Lot 40, Tahoe Tavern Heights Amended and Addition

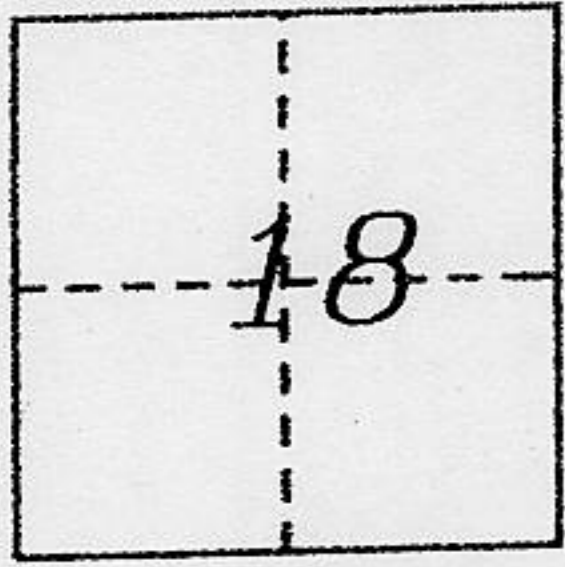

T.15 N., M.D.B. & M.
R.17 E.

CORNER TYPE

- Government Corner
- Control
- Meander
- Property
- Rancho
- Other
- Date of Survey August 2002

COORDINATES (Optional)

N. _____
 E. _____
 Zone _____ Datum _____
 Elev. _____

Corner— Left as found Found and tagged Established Reestablished Rebuilt

Identification and type of corner found: Evidence used to identify or procedure used to establish or reestablish corner:

● ~ found monument as noted

A description of the physical condition of the monument as found and as set or reset:
 ~ set 5/8" x 24" bar with 2" aluminum cap stamped LS 5886

SURVEYOR'S STATEMENT

This Corner Record was prepared by me or under my direction in conformance with the Land

Surveyor's Act on November 19 2002

Signed Thomas C. Buswell L.S. or R.C.E. Number 5886



COUNTY SURVEYOR'S STATEMENT

This Corner Record was Received OCT 2 2003 and Examined

and filed OCT 2 2003

Signed Charles B. Grant Title DEPUTY COUNTY SURVEYOR
 LS 6158

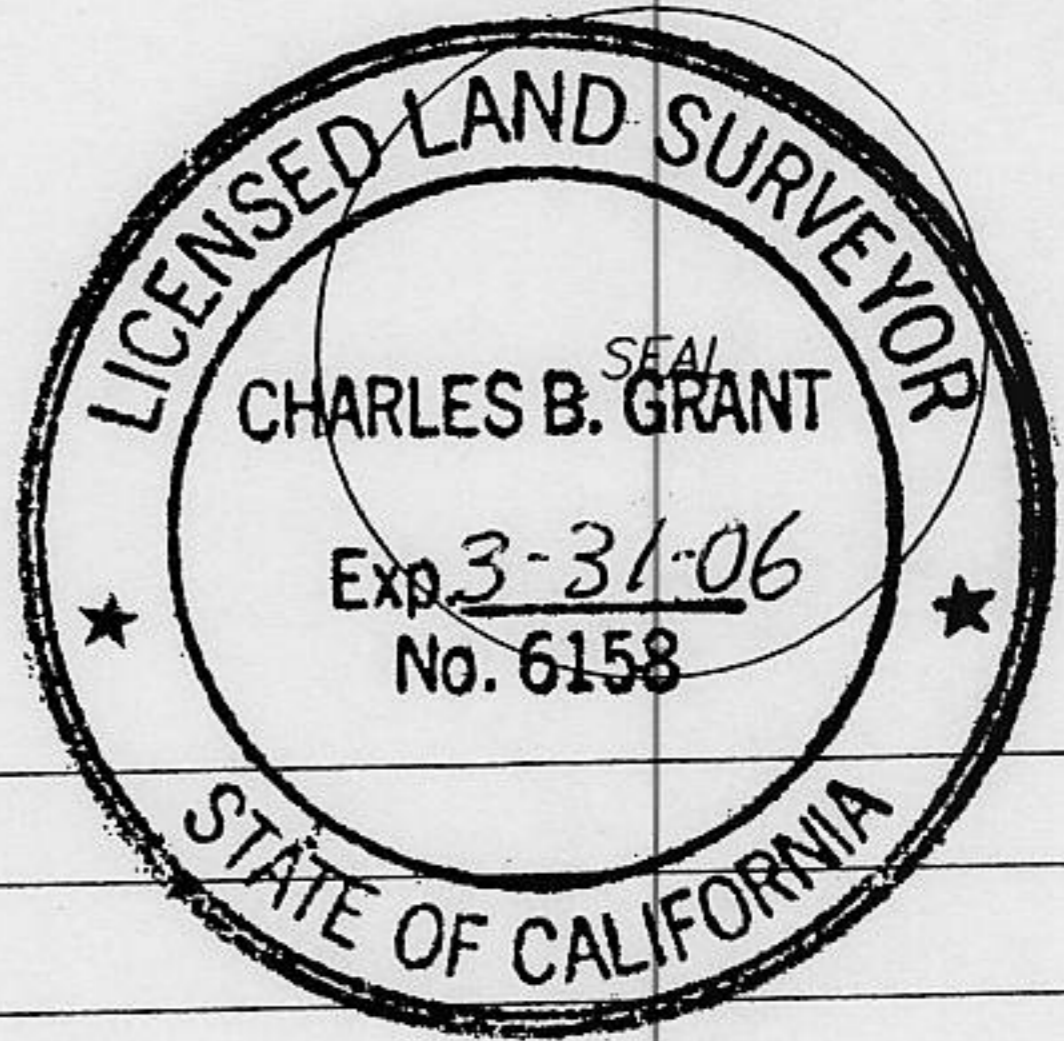

County Surveyor's Comment _____

Book 8 CORNER RECORDS PAGE 52

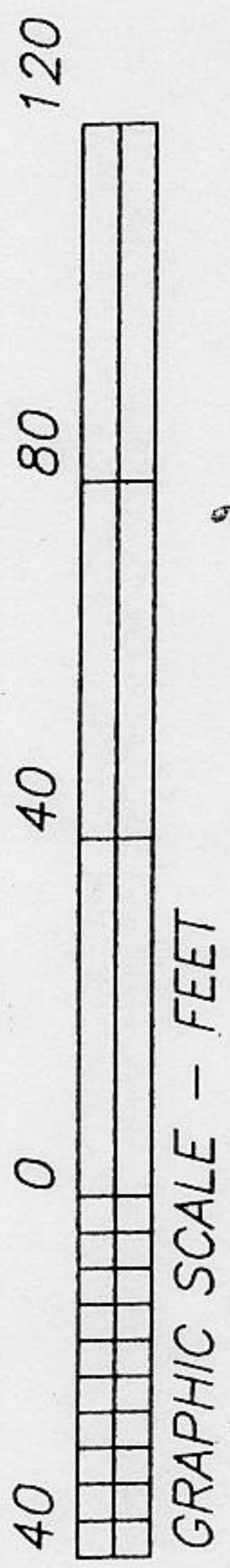
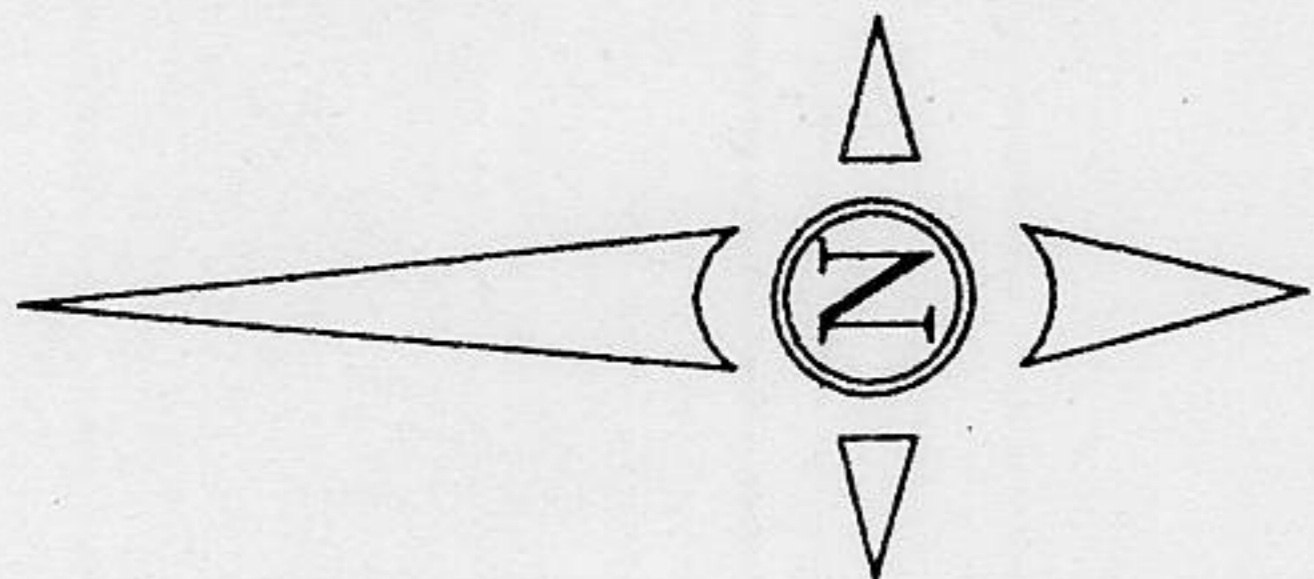

(R1) ~ RECORD PER "D" MAPS 92
(R2) ~ Measurement per unrecorded TBLs survey done in 1993

fd. 1 1/2" capped pipe stamped LS 2217 at N.E. cor. Lot 67

BASIS OF BEARINGS
N 0°23'00"W (R1)
(750.00')(R1)
749.87'

fd. 3/4" iron pipe
LS 5549

fd. 3/4" pipe, capped LS 5549

Holly (Manzanita)(R1)
50' r.o.w. (R1)

875.80'(875.91)(R2)

N 00°23'00"W (R1)
100.00' (R1)

N 00°23'00"W (R1)
125.93' (C) (R1)

set 5/8" bar LS 5886
fd. bent pipe with cap stamped LS 2217 lying on ground nearby

Lot 43

S 89°37'00"W (R1)
200.00' (R1)

Lot 40

(203.2')(R1)
203.10'
S 80°10'55"E
(N 80°12'W)(R1)

Lot 39

fd. 3/4" pipe, capped LS 5549

(90.00')(R1)
89.96'
S 00°27'13"E
(S 00°23'E) (R1)

Lot 41

fd. 1 1/2" capped iron pipe stamped LS 2217