

CORNER RECORD

COUNTY OF PLACER, CALIFORNIA

City of \_\_\_\_\_

Document Number \_\_\_\_\_

Brief Legal Description Lot 159, Dollar Point Unit No. 2, "G" Maps 7

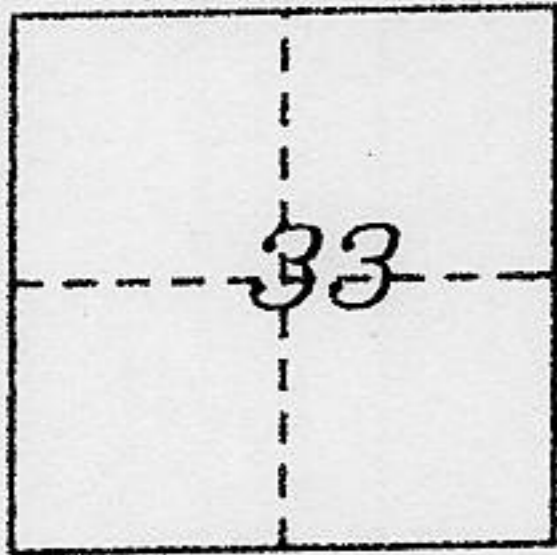

T.16N., R.17E. CORNER TYPE

COORDINATES (Optional)

M.D.M.

Government Corner

Control

N. \_\_\_\_\_

Meander

Property

E. \_\_\_\_\_

Rancho

Other

Zone \_\_\_\_\_

Datum \_\_\_\_\_

Date of Survey September 2002

Elev. \_\_\_\_\_

Corner— Left as found  Found and tagged  Established  Reestablished  Rebuilt

Identification and type of corner found; Evidence used to identify or procedure used to establish or reestablish corner:

● ~ found monument as noted

A description of the physical condition of the monument as found and as set or reset:

∅ ~ set 5/8" rebar with aluminum cap stamped LS 5886

SURVEYOR'S STATEMENT

This Corner Record was prepared by me or under my direction in conformance with the Land

Surveyor's Act on December 2002

Signed Thomas C. Buswell L.S. or R.C.E. Number 5886

Thomas C. Buswell



COUNTY SURVEYOR'S STATEMENT

This Corner Record was Received OCT 2 2003 and Examined

and filed OCT 2 2003

Signed Charles B. Grant Title DEPUTY COUNTY SURVEYOR  
LS 6158

County Surveyor's Comment \_\_\_\_\_

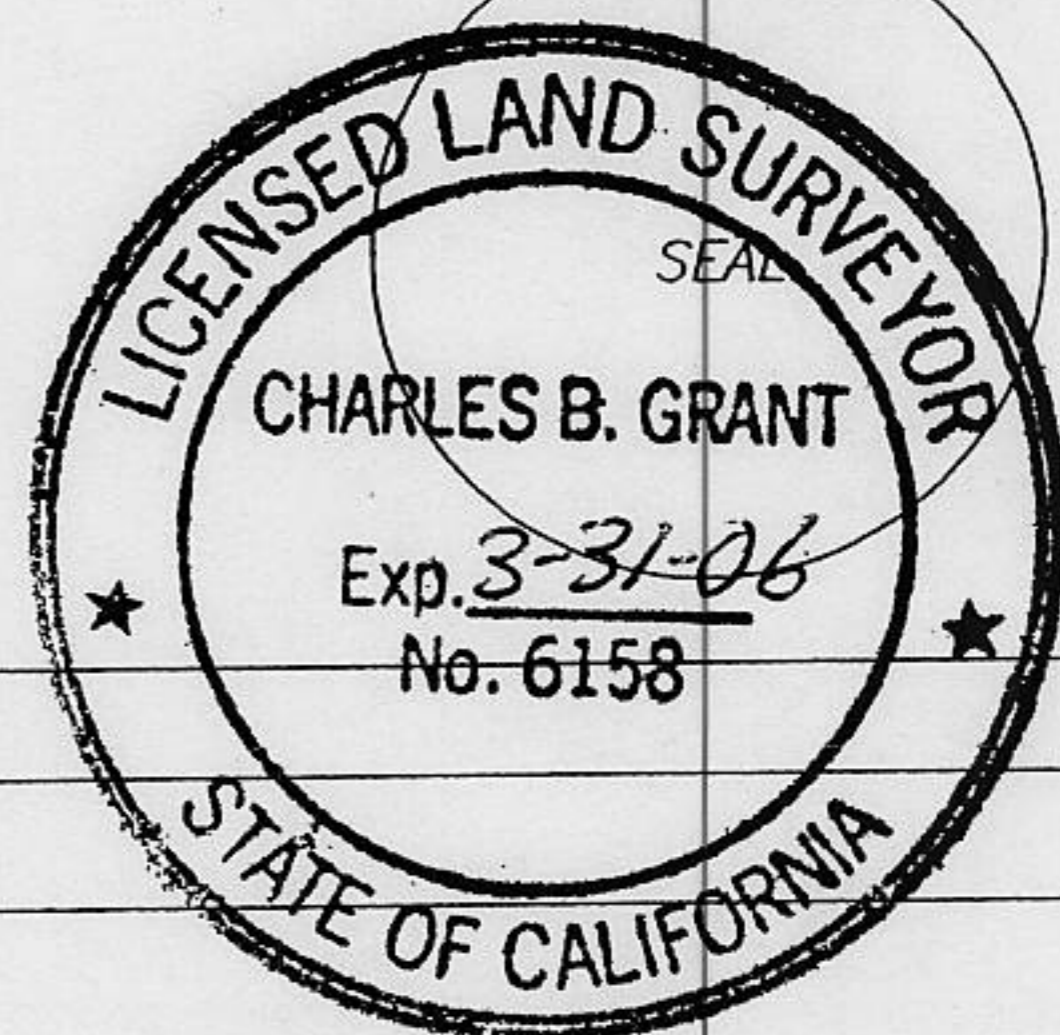

Book 8 CORNER RECORDS PAGE 59

(R1) ~ record per "G" Maps 7

