

CORNER RECORD

COUNTY OF PLACER, CALIFORNIA

City of _____ Document Number _____

Brief Legal Description Lot 26, Highlands No.1. M.O.R. Bk. "E" Pg. 92

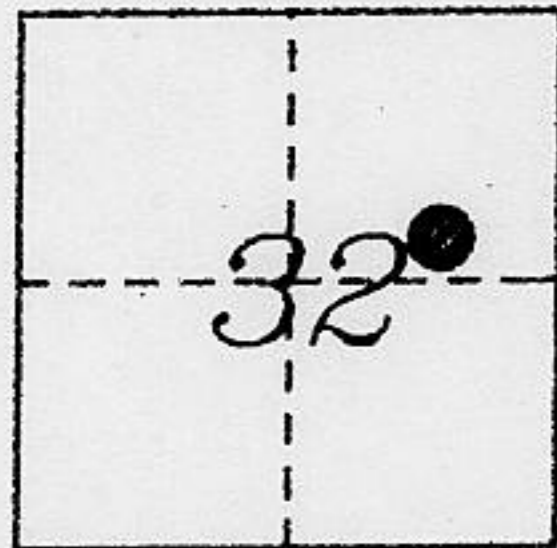

T. 16. N.

CORNER TYPE

COORDINATES (Optional)

R. 17 E.

Government Corner Control
Meander Property
Rancho Other
Date of Survey September 2002

N. _____
E. _____
Zone _____ Datum _____
Elev. _____

Corner- Left as found Found and tagged Established Reestablished Rebuilt

Identification and type of corner found: Evidence used to identify or procedure used to establish or reestablish corner:

● FOUND 1/2" REBAR
UNLESS OTHERWISE NOTED

A description of the physical condition of the monument as found and as set or reset:

Q SET 5/8" REBAR WITH 2" ALUMINUM CAP
STAMPED "TAHOE BASIN LAND SURVEYING" LS 5886

SURVEYOR'S STATEMENT

This Corner Record was prepared by me or under my direction in conformance with the Land

Surveyor's Act on November 15 02
20

Signed [Signature] L.S. or R.C.E. Number LS 5886

Thomas C. Buswell, PLS

COUNTY SURVEYOR'S STATEMENT

This Corner Record was Received OCT. 2 2003 and Examined

and Filed OCT 2 2003

Signed Charles B. Grant Title DEPUTY COUNTY SURVEYOR
LS 6158

County Surveyor's Comment _____

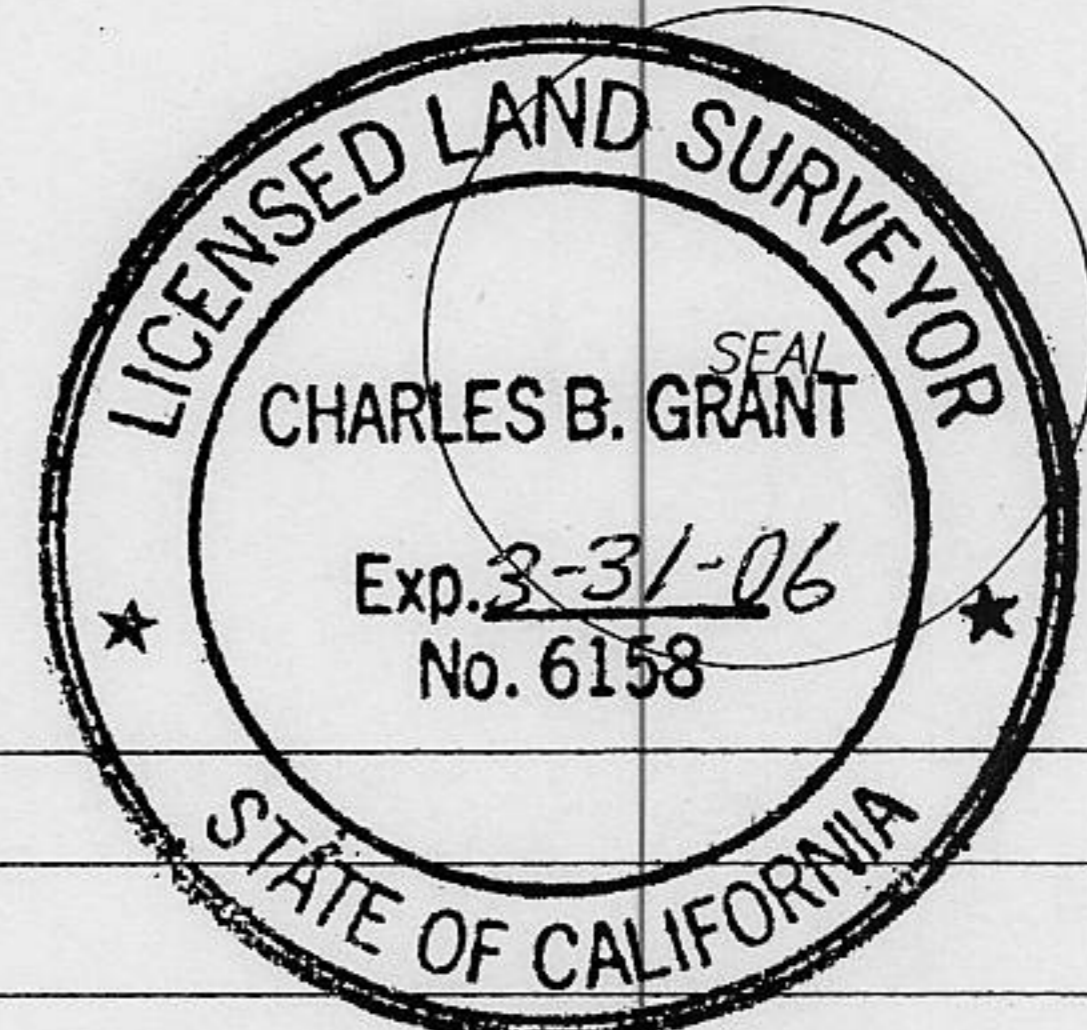
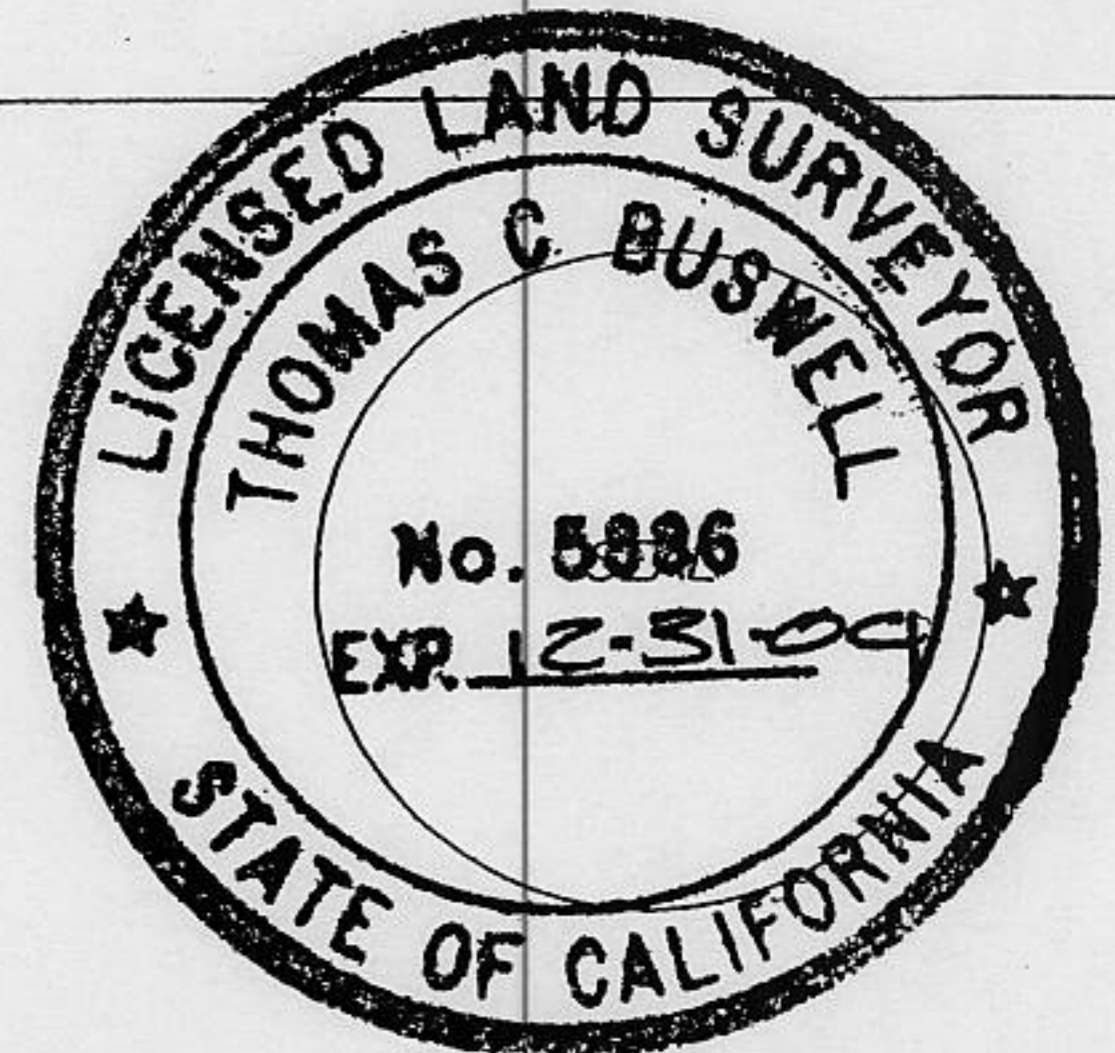

BOOK 8 CORNER RECORDS PAGE 60

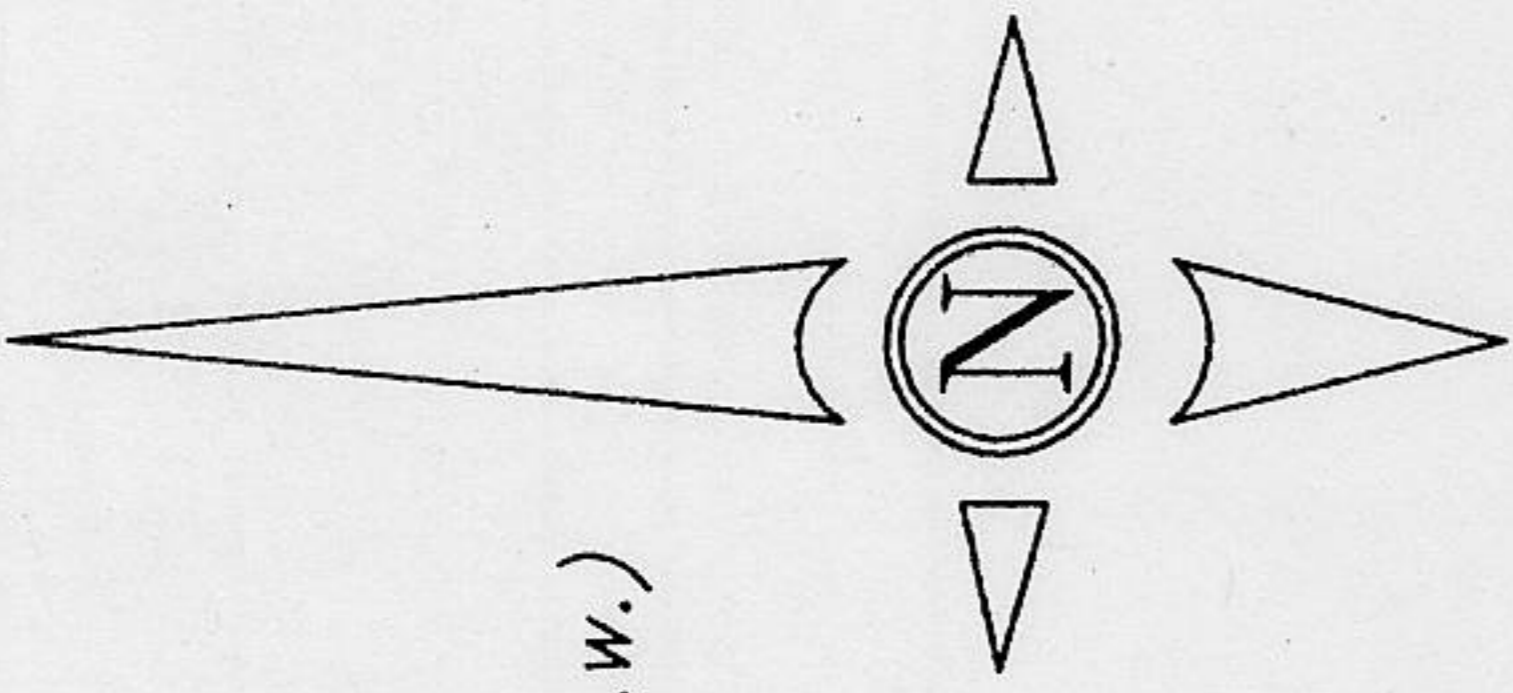

SCALE 1" = 40'

Watson Drive (50' r.o.w.)

fd. 1/2" bar, no tag (R1)
held as orig. monument

Lot 25

(150.00')(R1)
150.18'

S 00°51'25"E
(S 00°47'E)(R1)

fd. 1/2" bar (R1)
sleeved by 3/4" open pipe

Lot 8

(100.00')(R1)
100.015

N 89°11'06"E
(N 89°13'E)(R1)

Lot 26

(150.00')(R1)
150.12'

S 00°48'43"E
(S 00°47'E)(R1)

(S 89°13'W)(R1)
S 89°13'12"W

100.13'

(100.00')(R1)

Lot 7 40

120

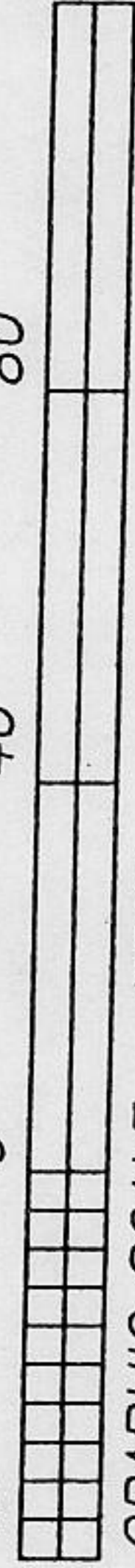

GRAPHIC SCALE - FEET

Lot 6

fd. 1/2" bar (R1)

S 00°47'E (R1)
S 00°48'54"E
50.00'(R1)

(N 89°13'E)(R1)

S 89°11'06"W

100.015

(100.00')(R1)

fd. 1/2" bar, no tag (R1)
held as orig. monument

set 5/8" rebar
with 2" metal cap
LS 5886

Lot 27

Basis of Bearings

fd. 1/2" bar (R1)

S 89°13'00"W (R1)

399.82'

(400.00')(R1)

fd. 5/8" bar with plastic cap
LS 3422 at S.W. cor. Lot 29

(R1) ~ RECORD PER "E" MAPS 92