

CORNER RECORD

COUNTY OF PLACER, CALIFORNIA

City of _____

Document Number 20090011

Brief Legal Description 7 - PM - 9

PARCEL MAP No. 71275

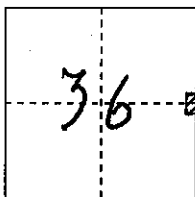

S. 36

CORNER TYPE

COORDINATES

T. 12 N.

Government Corner

Control

N. _____

R. 5 E.

Meander

Property

E. _____

Rancho

Other

Zone _____ Datum _____

Date of Survey _____

Elev. _____

Corner--- Left as found Found and tagged Established Reestablished Rebuilt

Identification and type of corner found: Evidence used to identify or procedure used to establish or reestablish corner: FOUND COPPERWELD STAMPED FOR 1/4 Cor. Sec. 36/31, LS 2515, 1975 # R#R SPIKES MARKING THE NORTHWEST & NORTHEAST CORNERS OF PARCEL 'C' IN TRAVELED WAY OF EAST CATTLE RD. PER PARCEL MAP No. 71275, BOOK 7 of PARCEL MAPS, PAGE 9 O.R.P.C. FROM FOUND MONUMENTS ESTABLISHED REFERENCE POINTS PRIOR ROAD RECONSTRUCTION

A description of the physical condition of the monument as found and as set or reset: FROM REFERENCE POINTS SET 2 1/2" BRASS CAP IN MONUMENT BOX STAMPED FOR 1/4 Cor. Sec. 36/31, T. 12 N., R. 5 E., R. 6 E., LS 7887, 2007 AND SET R#R SPIKES STAMPED LS 7887 AT NORTHWEST & NORTHEAST CORNERS OF PARCEL 'C' AFTER ROAD RECONSTRUCTION

SURVEYOR'S STATEMENT

This Corner Record was prepared by me or under my direction in conformance with the Professional Land Surveyors' Act

on JANUARY 15 2009

Signed [Signature]

L.S. or R.C.E. Number 7887 Expiration Date MAR. 31, 2009



COUNTY SURVEYOR'S STATEMENT

This Corner Record was received _____ 20____

and examined and filed MARCH 11 2009

Signed Charles B. Grant Title COUNTY SURVEYOR

L.S. or R.C.E. Number 6158 Expiration Date 3-31-10

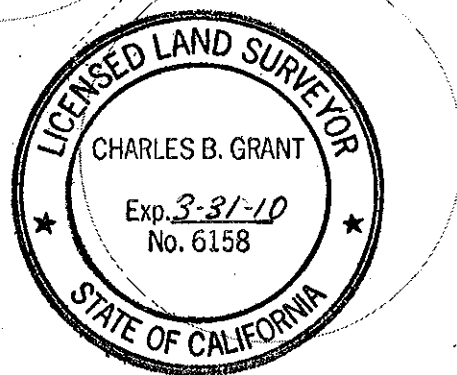

County Surveyor's Comment _____

BOOK 12 CORNER RECORDS PAGE 95

FOUND COPPER WELD STAMPED FOR
 1/4 Cor, Sec 36-31, LS 2515, 1975. SET
 2-1/2" BRASS CAP IN MONUMENT BOX
 STAMPED FOR 1/4 Cor Sec 36-31, T.12 N.,
 R.5 E., R.6 E., LS 7887, 2007.

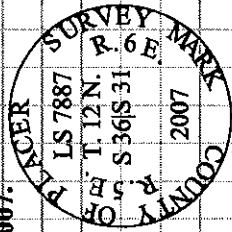

FOUND R x R SPIKE, MARKINGS
 ILLEGIBLE, AT RECORD DISTANCE
 FROM 3/4" REBARS MARKING AREA
 "K" PER 7-PM-9, BEARING NOT
 MEASURED, SET R x R SPIKE
 STAMPED LS 7887

MONUMENTS NOT SEARCHED FOR,
 NO ROAD RECONSTRUCTION WEST
 OF PARCEL 'C'

EAST CATLETT Rd. (A 4050)

30.00' (1)

FOUND 3/4" REBAR
 W/ COPPER COLLAR
 STAMPED LS 2515

WITNESS CORNER
 OBLITERATED

PARCEL 'A'

PARCEL 'B'

PARCEL 'C'

PARCEL 'D'

7-PM-9

NOTE:
 THIS CORNER RECORD REPRESENTS THE
 AS FOUND LOCATION OF THE MONUMENTS
 SHOWN HEREON. NO SURVEY HAS BEEN
 MADE OF SAID MONUMENTS.