

CORNER RECORD

COUNTY OF PLACER, CALIFORNIA

City of _____

Document Number 20090045

Brief Legal Description 12-ROS-51

RECORD of SURVEY No. 1548

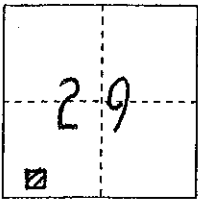

S. 29

CORNER TYPE

COORDINATES

(Optional)

T. 13 N.

Government Corner

Control

N. _____

Meander

Property

E. _____

R. 8 E.

Rancho

Other

Zone _____ Datum _____

Date of Survey _____

Elev. _____

Corner--- Left as found Found and tagged Established Reestablished Rebuilt

Identification and type of corner found; Evidence used to identify or procedure used to establish or reestablish corner:

FOUND R-R SPIKE IN TRAVELED WAY OF BELL RD. PER RECORD of SURVEY No. 1548
AT BOOK 12 of SURVEYS, PAGE 51 O.R.P.C. FROM FOUND MONUMENT ESTABLISHED
REFERENCE POINTS PRIOR TO ASPHALT OVERLAY

A description of the physical condition of the monument as found and as set or reset:

FROM REFERENCE POINTS SET MAG-NAIL W/ 1/4" BRASS TAG STAMPED "PLACER CO SURVEYOR"
CENTERED OVER FOUND MONUMENT AFTER ASPHALT OVERLAY

SURVEYOR'S STATEMENT

This Corner Record was prepared by me or under my direction in conformance with the Professional Land Surveyors' Act on MARCH 25 2009

Signed [Signature]

L.S. or R.C.E. Number 7887 Expiration Date MAR. 31, 2011



COUNTY SURVEYOR'S STATEMENT

This Corner Record was received _____ 20____ and examined and filed OCTOBER 16 2009

Signed Charles B. Grant Title COUNTY SURVEYOR

L.S. or R.C.E. Number 6158 Expiration Date 3-31-10

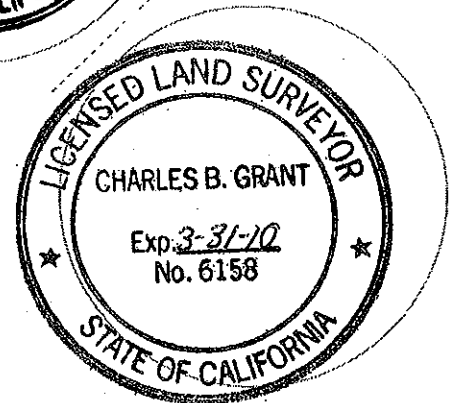

County Surveyor's Comment _____

BOOK 13 CORNER RECORDS PAGE 58

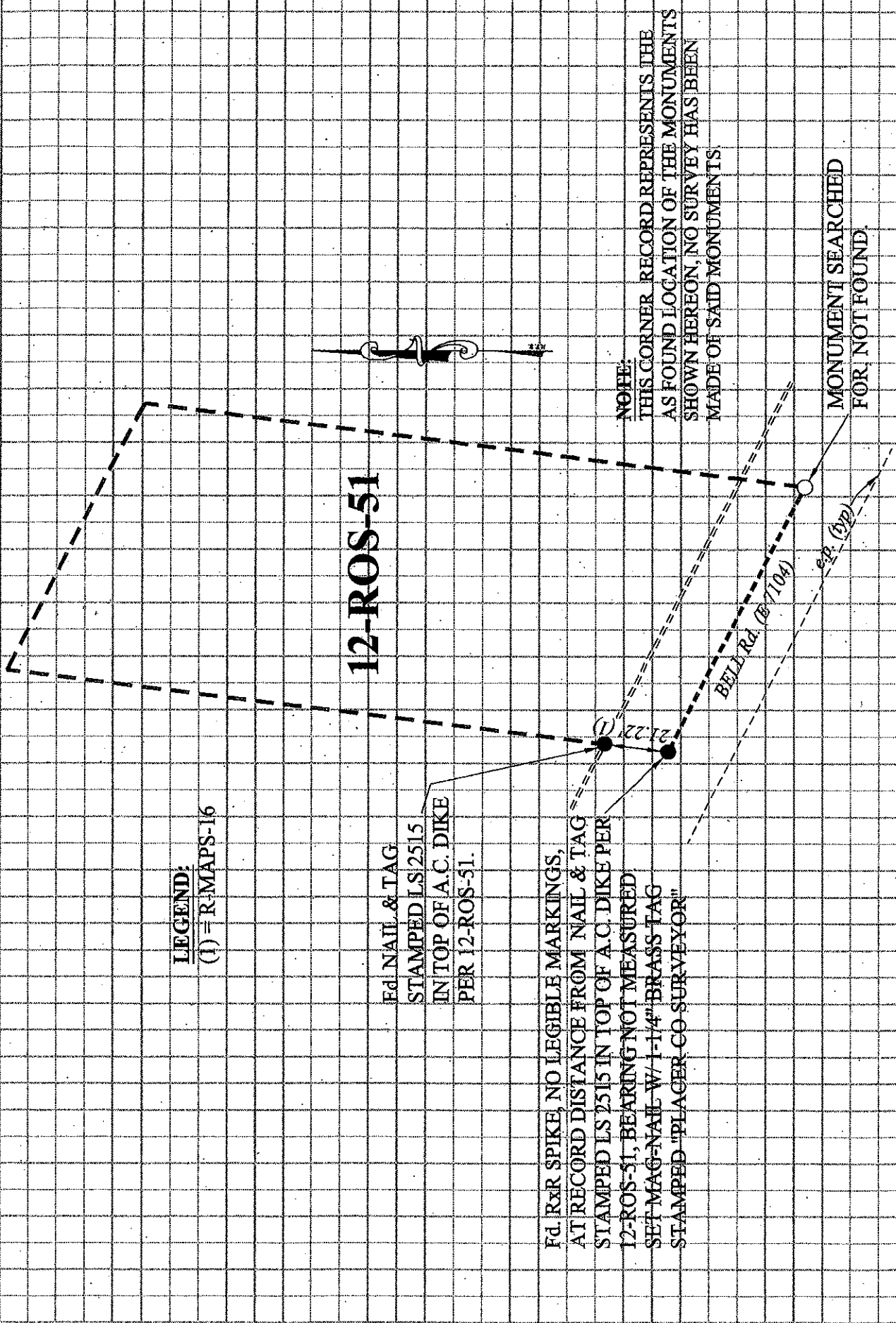

LEGEND:
 (1) = R-MAPS-16

12-ROS-51

Ed NAIL & TAG
 STAMPED LS 2515
 IN TOP OF A.C. DIKE
 PER 12-ROS-51.

Fd. R&R SPIKE, NO LEGIBLE MARKINGS,
 AT RECORD DISTANCE FROM NAIL & TAG
 STAMPED LS 2515 IN TOP OF A.C. DIKE PER
 12-ROS-51, BEARING NOT MEASURED
 SET MAG-NAIL W/ 1-1/4" BRASS TAG
 STAMPED "PLACER CO SURVEYOR"

NOTE:
 THIS CORNER RECORD REPRESENTS THE
 AS FOUND LOCATION OF THE MONUMENTS
 SHOWN HEREON, NO SURVEY HAS BEEN
 MADE OF SAID MONUMENTS

MONUMENT SEARCHED
 FOR, NOT FOUND