

# CORNER RECORD

DOCUMENT NUMBER 20100031

CITY OF \_\_\_\_\_

COUNTY OF PLACER, CALIFORNIA

BRIEF LEGAL DESCRIPTION: The East quarter corner of Section 5, T. 16 N., R. 13 E., M.D.M.

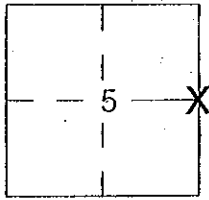

## CORNER TYPE

## COORDINATES (Optional)

GOVERNMENT CORNER       CONTROL   
 MEANDER                       PROPERTY   
 RANCHO                       OTHER   
 DATE OF SURVEY: August 30, 2010

N. \_\_\_\_\_  
 E. \_\_\_\_\_  
 Zone \_\_\_\_\_ Datum \_\_\_\_\_  
 Elev. \_\_\_\_\_

Corner -      LEFT AS FOUND       FOUND AND TAGGED       ESTABLISHED       REESTABLISHED       REBUILT

Identification and type of corner found: Evidence used to identify or procedure used to establish or reestablish the corner:

I found a well embedded stone mound in a meadow and remains of original bearing tree in the Southeast quadrant. (Fnd. a twin rotted Red Fir stump and old rusted steel K-Tag w/ tack between S5-S4). Measurements were made South to the GLO call for end of flat ground, a line tree, and ridge top. Several rotted fir stumps are located in the vicinity of the GLO Line tree, but no clear evidence of the exact Line tree. The GLO call to the end of flat ground & the ridge agrees with my measurement. Fir debris is located near the GLO bearing tree in the Southwest quadrant, but evinence of original bearing tree could not be positively identified.

A description of the physical condition of the monument as found and as set or reset:

Set a 3 inch aluminum capped monument 30 inches long in the found stone mound and rebuilt a 32" by 8" stone mound around the monument. Established two new bearing trees as noted on page 2.

## SURVEYOR'S STATEMENT

This Corner Record was prepared by me or under my direction in conformance with the Land Surveyors' Act on, August 31, 2010

Signed \_\_\_\_\_ L.S. or R.C.E. Number 29700



## COUNTY SURVEYOR'S STATEMENT

This Corner Record was received: \_\_\_\_\_, and examined and filed NOVEMBER 30, 2010  
 Signed: \_\_\_\_\_ Title Deputy

*Leslie Amstbery*  
 PLS 6584

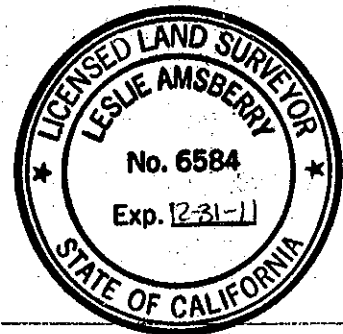

County Surveyor's Comment \_\_\_\_\_  
 \_\_\_\_\_  
 \_\_\_\_\_  
 \_\_\_\_\_

BOOK 14, CORNER RECORDS, PAGE 06

BOOK 14, CORNER RECORDS, PAGE 06

FND. EMBEDDED STONE MND.  
SET 3" ALUMINUM CAPPED  
PIPE IN 32"X 8" STONE  
MOUND. CAP MARKED:

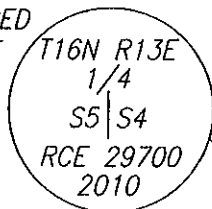

FND. 5/8" REBAR W/  
PLASTIC CAP MKD:  
LS 3728, NO RECORD



S75°W  
213.92'

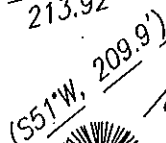

NEW B.T.  
20" RED FIR  
SCRIBED: 1/4S5BT

SEARCHED FOR ORIGINAL  
(48" FIR) NO EVIDENCE  
COULD BE IDENTIFIED

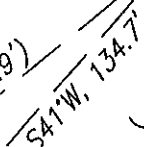

SOUTH, 625' [Magnetic Bearing]

(S60°E 141.2')  
S60°E 141.4'

ORIGINAL B.T.  
(24" FIR)  
FND. ROTTED STUMP  
25" & 36" DIAMETER  
TWIN RED FIRS



NEW B.T.  
22" WESTERN WHITE PINE  
SCRIBED: 1/4S4BT

END OF FLAT LANDS  
SOUTH 66' (SOUTH 66')

LEGEND:

( ) RECORD PER: G.L.O BY J. GLOVER 1875  
(R0076/PG 264-267)

BASIS OF BEARINGS:

BEARINGS ARE IDENTICAL TO THOSE SHOWN  
ON BOOK 10 OF SURVEYS PAGE 125 BASED  
UPON MONUMENTS FOUND ALONG THE NORTH  
LINE OF SECTION 5, T16N, R13E., M.D.M.  
DETERMINED BY USING RAW UNCORRECTED  
G.P.S. MEASUREMENTS.

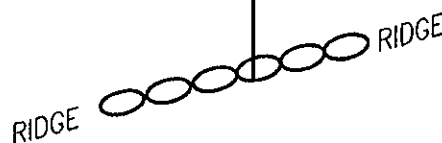

NO SCALE