

CORNER RECORD

COUNTY OF PLACER, CALIFORNIA

City of \_\_\_\_\_ Document Number 20150004

Brief Legal Description PORTION LOT 7 & 8, BOOK I MAPS, PAGE 29

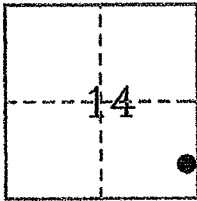

T.15N., R.16E.  
M.D.B. & M.

CORNER TYPE

Government Corner  Control   
Meander  Property   
Rancho  Other   
Date of Survey OCTOBER 2014

COORDINATES  
(Optional)

N. \_\_\_\_\_  
E. \_\_\_\_\_  
Zone \_\_\_\_\_ Datum \_\_\_\_\_  
Elev. \_\_\_\_\_

Corner— Left as found  Found and tagged  Established  Reestablished  Rebuilt

Identification and type of corner found: Evidence used to identify or procedure used to establish or reestablish corner:

• ~ FD. 3/4" IRON PIPE ON CENTERLINE PER 1 MAPS 29

THESE MONUMENTS WERE USED AS A BASIS OF BEARINGS

TO RESET THE MONUMENTS SHOWN IN THEIR RECORD POSITIONS

IN THE ABSENCE OF ANY OTHER EVIDENCE.

A description of the physical condition of the monument as found and as set or reset:

Ø ~ set 5/8" rebar with 2" aluminum cap stamped "TAHOE BASIN LAND SURVEYING, THOMAS C. BUSWELL, LS 5886".

SURVEYOR'S STATEMENT

This Corner Record was prepared by me or under my direction in conformance with the Land

Surveyor's Act on JANUARY 20 15

Signed Thomas C. Buswell L.S. or R.C.E. Number 5886  
Thomas C. Buswell, PLS



COUNTY SURVEYOR'S STATEMENT

This Corner Record was Received \_\_\_\_\_ 20 \_\_\_\_\_ and Examined

and filed APRIL 29 2015

Signed Leslie Amberry Title County Surveyor



County Surveyor's Comment \_\_\_\_\_

BOOK 17 CORNER RECORDS PAGE 99

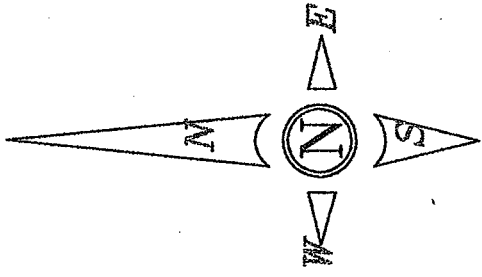

SCALE = 1" = 50'

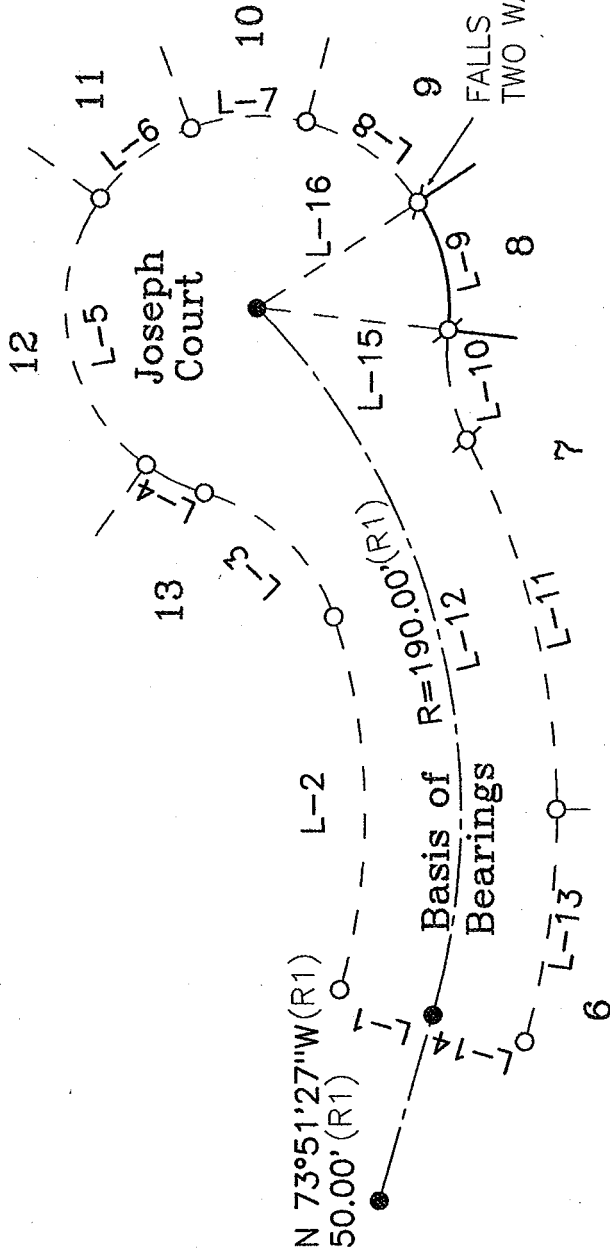

**Legend**

- (R1) ~ RECORD AS PER BK. 1 Maps 29
- ~ FD. 3/4" IRON PIPE IN A.C. PAVEMENT, NO MARKINGS
- ~ SEARCHED FOR MONUMENT, BUT DID NOT FIND
- ⊗ ~ SET 5/8" REBAR L.S. 5886

COURSE	BEARING	DISTANCE
L-1	N 16°08'33"E (R1)	25.00' (R1)
L-2	N 89°04'16"E (R1)	96.88' (R1)
L-3	N 44°01'10"E (R1)	46.92' (R1)
L-4	N 25°43'25"E (R1)	16.82' (R1)
L-5	N 80°07'35"E (R1)	70.36' (R1)
L-6	S 37°46'35"E (R1)	29.87' (R1)
L-7	S 02°53'35"E (R1)	30.08' (R1)
L-8	S 35°33'15"W (R1)	35.74' (R1)
L-9	S 76°36'55"W (R1)	34.40' (R1)
L-10	N 79°54'50"E (R1)	28.94' (R1)
L-11	S 76°26'45"W (R1)	99.30' (R1)
L-12	N 76°08'35"E (R1)	190.00' (R1)
L-13	N 82°01'50"W (R1)	61.13' (R1)
L-14	N 16°08'33"E (R1)	25.00' (R1)
L-15	N 06°44'00"E (R1)	50.00' (R1)
L-16	N 33°30'10"W (R1)	50.00' (R1)