





LEGEND:

-  EXISTING TREES TO BE REMOVED (800 TREES TOTAL TO BE REMOVED)
-  EXISTING TREE
-  SILT FENCING
-  CONSTRUCTION FENCING
-  TREE PROTECTION FENCING

NOTE:
ALL CONSTRUCTION FENCING, SILT FENCING/FIBER ROLLS, AND TREE PROTECTION IS TO BE PERFORMED IN STAGES. CONTRACTOR IS TO REUSE UNDAMAGED MATERIAL IN FUTURE STAGES TO ELIMINATE THE AMOUNT OF MATERIAL AND SUPPLIES REQUIRED FOR ALL TEMPORARY BMPs THROUGH OUT THE LIFE SPAN OF THE PROJECT.



2 WORKING DAYS
BEFORE YOU DIG CALL USA
DIAL '811'

PLACER COUNTY
TRPA
SUBMITTAL
DATE: 07-29-15

TREE SURVEY ON CAMPGROUND SITE ONLY:

TREE SIZE	QTY	REMOVED	REMAINING
TREES UNDER 30" DIAMETER	3,970	676	3,294
TREES 30" AND OVER	530	61	469
TOTAL TREES	4,500	737	3,763

REMOVAL PERCENTAGES:

TREE SIZE	ON TOTAL PROJECT AREA*
TREES UNDER 30" DIAMETER	676 / 4,764 = 14.2%
TREES 30" AND OVER	61 / 636 = 9.6%

*TREE SURVEY & REMOVAL NOTE:
THE FIELD TREE SURVEY WAS PERFORMED ON THE CAMPGROUND SITE ONLY (80+ ACRES). THE PROJECT AREA IS APPROXIMATELY 120.4 ACRES; THEREFORE, THE ESTIMATED, TO BE VERIFIED, TOTAL TREES IN PROJECT AREA IS APPROXIMATELY 5,400 TREES RESULTING IN REMOVAL PERCENTAGES THAT ARE LESS THAN ABOVE; ADDITIONALLY, AS THE SITE DESIGN IS REFINED AND PERMITTED, TREES, NAMELY OVER 30", WILL BE AVOIDED WHERE FEASIBLE.

TRPA Notes:

- 61.1.4.C
2. Limited Forest Plan
Private landowners may prepare a limited forest plan when there would be limited proposed impact to large trees.
 - a. A limited forest plan may be prepared if ten percent or less of the trees larger than 30 inches dbh in the westside forest types and larger than 24 inches dbh in eastside forest types within the project site are proposed to be cut within the life of the plan.
 - b. The limited forest plan shall include:
 - (i) The relative state permit application, if available;
 - (ii) Description of harvest activities;
 - (iii) Description of management activities;
 - (iv) Explanation of how thresholds, goals and policies shall be attained under the forest plan; and
 - (v) The expiration date of the plan. A minimum lifespan of ten years and a maximum lifespan of 50 years shall be accepted.
 3. TRPA shall review proposed cutting of trees larger than 30 inches dbh in the westside forest types and larger than 24 inches dbh in eastside or larger forest types on a tree-by-tree basis consistent with the forest plan.

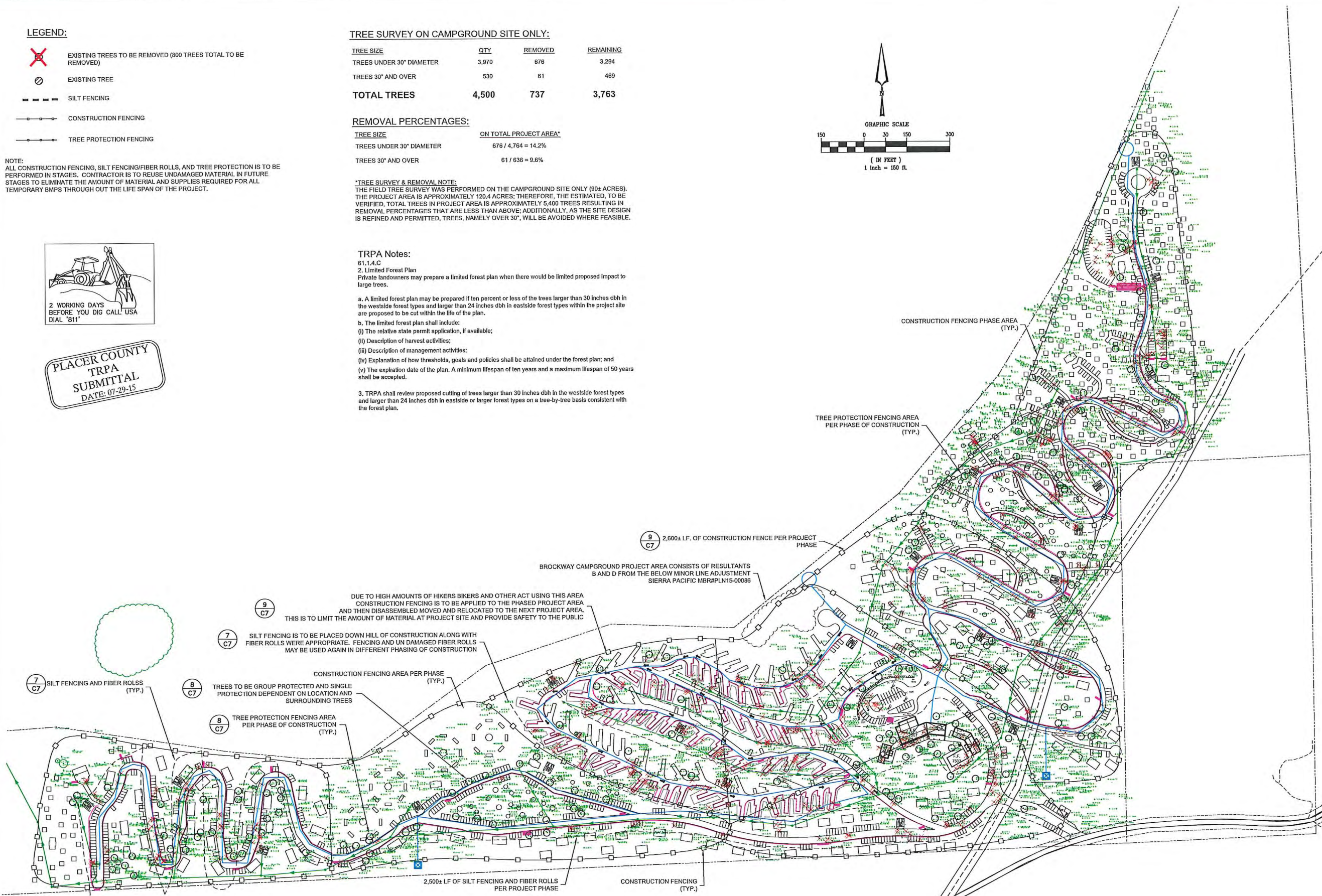
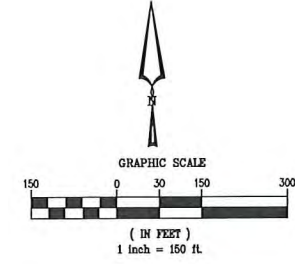

BROCKWAY CAMPGROUND
PLACER COUNTY, CALIFORNIA

SIERRA PACIFIC INDUSTRIES
PO BOX 496028 REDDING, CA.
(530) 378-8000

Revisions:

WELSH HAGEN
ASSOCIATES
ENGINEERING · PLANNING · SURVEYING
5490 Longley Lane
Reno, Nevada 89511
(775) 853-7776
www.welshhagen.com

NOTE:
This drawing is the property of Welsh Hagen Associates, Inc., including all patented and patentable features, and/or confidential information. Its use is conditioned upon the user's agreement not to reproduce the drawing, in whole or part, nor the material described thereon; nor to use the drawing for any purpose other than specifically permitted in writing by Welsh Hagen Associates, Inc.



**PRELIMINARY
NOT FOR
CONSTRUCTION**

Sheet Title:
**BMP
TREE REMOVAL
PLAN**

Project: 404100
Drawn By: BAMB
Checked By: DLH
Scale: AS-NOTED
Date: JULY 2015
Sheet Number:

C3

RECORD DRAWINGS
DATE _____ ENGINEER INITIAL _____