

2016 CALIFORNIA BUILDING STANDARDS CODE OF REGULATIONS TITLE 24

PRIVATE SWIMMING POOL/FENCING BARRIER REQUIREMENTS CBC SECTION 3109

INTENT: The intent of the swimming pool barrier requirement is to prevent the uncontrolled access to a pool or spa by children from adjacent properties and from the home.

DEFINITIONS:

Swimming pool or pool means any structure intended for swimming or recreational bathing that contains water over 18" deep. Swimming pool includes in-ground and aboveground structures and includes, but is not limited to, hot tubs, spas, portable spas, and non-portable wading pools.

Spa, self-contained, is a continuous-duty appliance in which all control, water-heating and water-circulating equipment is an integral part of the product, located entirely under the spa skirt. A self-contained spa is intended for recreational bathing and contains water over 18 inches (457 mm) deep. (Locking safety covers that comply with ASTM ES-13-89 ASTM F 1346 91(2010) would be acceptable CBC 3109.4.4.5) (No enclosure required)

Spa, non-self-contained, is a hydro-massage pool or tub for recreational or therapeutic use, not located in health-care facilities, designed for immersion of users and usually having a filter, heater and motor-driven blower. It may be installed indoors or outdoors, on the ground or on a supporting structure, or in the ground or in a supporting structure. A non-self-contained spa is intended for recreational bathing and contains water over 18 inches (457 mm) deep. (Considered a swimming pool, enclosure required to comply with CBC 3109.4.4.2 and 3109.4.4.3)

Enclosure means a fence, wall, or other barrier that isolates a swimming pool from access to the home.

Approved safety pool cover means a manual or power-operated safety pool cover that meets all of the performance standards of the American Society for Testing and Materials (ASTM) standard F1346.

Exit alarms means devices that make audible, continuous alarm sounds when any door or window that permits access from the residence to the pool area that is without any intervening enclosure is opened or is left ajar. Exit alarms may be battery operated or may be connected to the electrical wiring of the building. Home security alarm is not acceptable.

Contractor's Responsibility

Any person entering into an agreement to build a swimming pool shall give the consumer notice of the requirements of the swimming pool barrier. Health and Safety Code Section 115924

REQUIRED SAFETY FEATURES: Both Part A and Part B below must be complied with.

Part A) CBC Section 3109.4 as modified by Placer County.

The swimming pool must be surrounded by a fence or wall at least 60" high. Chain link of 2 ¼" square (3109.4.1.5) fencing or vertical slat fencing with a maximum slat spacing of four inches, masonry meets this requirement. Other enclosures that will prevent access to the pool can be approved provided that no opening other than openings for doors, gates or allow a sphere four inches in diameter to pass through it may be approved.

Exception: Hot tubs or spas, that meet the definition of self-contained, and have a locking safety cover that complies with ASTM ES-13-89 (ASTM F-1346) are exempt from the fence enclosure requirement. Hot tubs or spas recessed below the adjoining floor, deck or grade level are considered pools for this purpose and must have the fence enclosure. CBC 3109.4.4.3 #2.

Part B) CBC Section 3109.4.4

The pool shall be isolated from access to a home by one of the following methods prior to filling with water. Please see diagrams below for appropriate applications of items 1 thru 6. Provide additional information for item 7.

- #1. The pool shall be isolated from access to the home by an enclosure that meets the following requirements:
 - Any access gates through the enclosure open away from the swimming pool and are self-closing with a self-latching device placed no lower than 60" above the ground. Double (Vehicle) gates, shall require the fixed side of the gate to have a lockable drop pin and a permanently attached plastic or metal weather resistant signage, **"THIS GATE TO REMAIN LOCKED AT ALL TIMES"**. Operating gate shall open away from the pool, be self-closing and self-latching at 60" above grade or shall be locked at all times.
 - A minimum height of 60".
 - Maximum vertical clearance from the ground to the bottom of the enclosure of 2".
 - Gaps or voids, if any, do not allow passage of a sphere equal to or greater than 4" in diameter.
 - An outside surface free of protrusions, cavities, or other physical characteristics that would serve as handholds or footholds that could enable a child below the age of five years to climb over.
- #2. The pool shall incorporate removable mesh pool fencing that meets ASTM F 2286 in conjunction with a gate that is self-closing and self-latching and can accommodate a key lockable device.
- #3. The pool shall be equipped with an approved safety pool cover meeting ASTM F1346
- #4. The residence shall be equipped with exit alarms on those doors providing direct access to the pool. All doors with direct access to the pool from the dwelling shall be equipped with an alarm that produces an audible warning when the door and its screen, if present, are opened. The alarm shall be listed in accordance with UL 2017. The deactivation switch shall be located at least 54 inches above the threshold of the door.
- #5. All doors providing direct access from the home to the swimming pool shall be equipped with a self-closing, self-latching device with a release mechanism placed no lower than 54" above the floor.
- #6. Swimming pool alarm, when placed in pools, will sound upon detection of accidental or unauthorized entrance into the water and certified to ASTM F 2208. Other means of protection, if the degree of protection afforded is equal to or greater than that afforded by any of the devices set forth in (1) to (6) above, as determined by the Building Official.
- #7. Other means of protection, if the degree of protection afforded is equal to or greater than that afforded by any of the devices set forth in items 1-4, and have been independently verified by an approved testing laboratory as meeting standards for those devices established by the ASTM or the American Society of Testing Mechanical Engineers (ASME).
- #8 Driveway gates that are part of the enclosure are to be electronically operated and automatically close within one minute of being opened. (15.04.320) P.C.C.

Barrier features 2, 3, 4, 5 and 6 of Part B above are permitted as a substitution for the fence between the home and pool but **cannot be used as a substitution for the fence required in Part A.**

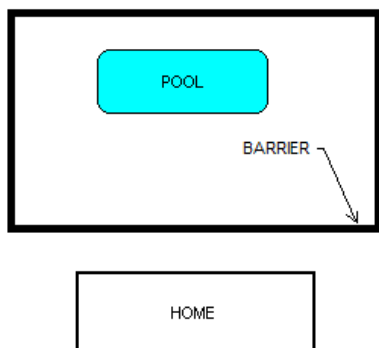

PART "A" REQUIRED ONLY

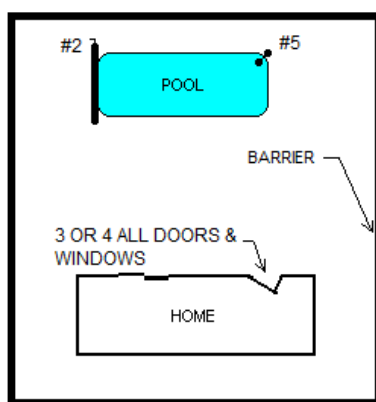

PARTS "A" & "B"

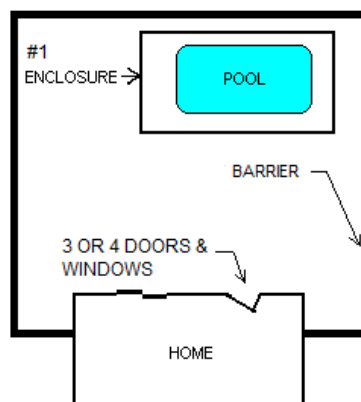

PARTS "A" & "B"